

8.0 RECREATION AND OPEN SPACE ELEMENT

Developing new facilities and fields, as well as enhancing existing recreation facilities and open space, remains an important aspect of campus design. As student enrollment increases, not only is there an increased demand to ensure adequate housing but to provide enough recreation fields and open space. Whether for intercollegiate or intramural activities, students need these amenities to remain connected to the University (see Figure 8.1: Modesto A. Maidique Campus, Figure 8.2: Engineering Center and Figure 8.3: Biscayne Bay Campus the location of recreational facilities and open space).

The 2015 Master Plan Update identifies the need for additional on-campus recreation facilities and the development and preservation of open space to support the projected growth in student enrollment. Due to the increased pressure at Modesto A. Maidique to use its available land for academic facilities, active recreational activities are limited to the western edge of campus, which is experiencing yet further constraints due to the construction of additional support facilities. This has forced the University to limit its long-range growth in on-campus recreation and look for off-campus joint use facilities. Negotiations with Miami-Dade County for possible joint use of Tamiami Park should remain as a constant tool to use for additional recreational facilities. FIU will continue to work with the Miami-Dade County Park and Recreation Department (MDPR) regarding recreation and open space needs for both the University and Miami-Dade County.

Biscayne Bay Campus has available land to accommodate a growing student population and associated recreation and athletic facilities. As additional housing is completed, recreational fields and facilities will be located to the north and south portions of the campus.

The 2015 Open Space Concept Plan (See Figures 8.1 Modesto A. Maidique Campus, 8.2 Engineering Center and 8.3 Biscayne Bay Campus) identifies three categories: gathering space, recreational open space and special purpose landscapes. Recreational space refers to structured recreation and athletic spaces. Special Purpose Landscapes refer to open spaces that can be used for teaching or research. The remaining gathering spaces include that which is integral to the surrounding built campus environment. (Refer to Figures 16.1 Modesto A. Maidique, 16.2 Engineering Center and 16.3 Biscayne Bay Campus for greater definition of the open space category.)

Open spaces on each campus have been developed so that they become an integral part of the overall urban design campus plan. Development that would encroach on these open spaces is discouraged in order that the natural resources of each campus are protected. Architectural and landscape design guidelines will ensure that appropriate open spaces, plazas and gathering spaces are provided with all new construction.

GOAL 1: Protect, enhance and develop adequate recreation facilities and open space amenities necessary to serve projected student enrollments.

Objective 1.1	Recreation Facilities: Coordinate public and private resources as necessary to ensure the timely and efficient provision of recreation facilities to meet projected needs.
Policy 1.1.1	UNIVERSITY-WIDE: FIU will continue to assess the needs of the students for on-campus recreational fields. Recreational fields displaced by new construction will be replaced at an alternative site.
Policy 1.1.2	MODESTO A. MAIDIQUE CAMPUS: Phase and time development of open space improvements consistent with 14.0 Capital Improvement.
Policy 1.1.4	FIU shall create additional stadium seating by relocating the existing stadium track to the soccer field. Discussions for the modification of the stadium and its use will include input from MDPR and Miami-Dade County Public Schools.
Policy 1.1.5	FIU will create jogging trails throughout campus for fitness programs and general use.
Policy 1.1.7	BISCAYNE BAY CAMPUS: Phase and time development of open space improvements, future athletic and recreational facilities consistent with 14.0 Capital Improvement Element.
Policy 1.1.7	Recreation and athletic spaces will be clustered to the north and south portions of the campus.
Objective 1.2	Open Space: Protect and/or enhance present open space resources.
Policy 1.2.1	UNIVERSITY-WIDE: FIU shall select sites for infrastructure and academic and support facilities, which are designed to strengthen the viability and character of campus open space.
Policy 1.2.2	FIU shall maintain densities and intensities for the development of the campus which maximize the retention of open space. These densities and intensities are established in 4.0 Land Use Element.
Policy 1.2.3	MODESTO A. MAIDIQUE CAMPUS: Any development within the Teaching and Research Park (See Figure 16.1) will be coordinated with the recommendations of the 2003 Charrette, contingent on a 10 year progress review. Protected areas

will be integrated within the existing wooded areas, with sensitively place buildings, paths, seating areas, interpretative display and amenities, retaining wooded areas for existing species and to provide shelter and its natural characteristics.

The FIU "Natural Preserve Charrette" of 2003 provides a plan for utilizing the preserve for teaching and outdoor recreation as well as other uses.

- | | |
|---------------|---|
| Policy 1.2.4 | Create and maintain a built-out development plan for the purpose of designating landscaped open space. |
| Policy 1.2.5 | Protect existing and planned designated landscaped open spaces from development and create new malls, quadrangles, courtyards, plazas and open space. |
| Policy 1.2.6 | Coordinate with Miami-Dade County Park and Recreation Department for the utilization of open space to meet recreation and open space needs. |
| Policy 1.2.7 | ENGINEERING CENTER
Protect existing open space from SW 107 th Avenue as a landscaped buffer. |
| Policy 1.2.8 | Establish educational open space bordering West Flagler Street. |
| Policy 1.2.9 | Establish open space quadrangle around which to organize future academic and research facilities. |
| Policy 1.2.10 | Establish open spaces between facilities as activity centers, gathering areas and pedestrian plazas. |
| Policy 1.2.11 | Establish north/south pedestrian spine to connect Flagler, existing buildings and potential development to the north. |
| Policy 1.2.12 | Protect walled open space around the Wall of Wind to provide protection from research activities. |
| Policy 1.2.13 | BISCAYNE BAY CAMPUS:
Protect environmentally sensitive and Bayfront open spaces from development encroachment by strictly enforcing future placement of buildings, parking, infrastructure and other man-made improvements consistent with the land use plan which depicts and protects the environmentally sensitive and Bayfront open spaces from development. |

Miami-Dade County's Department of Environmental Protection (DERM) recommends close coordination with DERM for any future placement of buildings, parking infrastructure and other man-made improvements as part of FIU's commitment to protect environmentally sensitive and bayfront open spaces from development encroachment at the Biscayne Bay Campus.

Policy 1.2.14

Enhance key symbolic campus open spaces to the north and south of Academic One and Two/Wolfe University Center and to the east of the Conference Center (see 16.0 Landscape Design Guidelines Element).

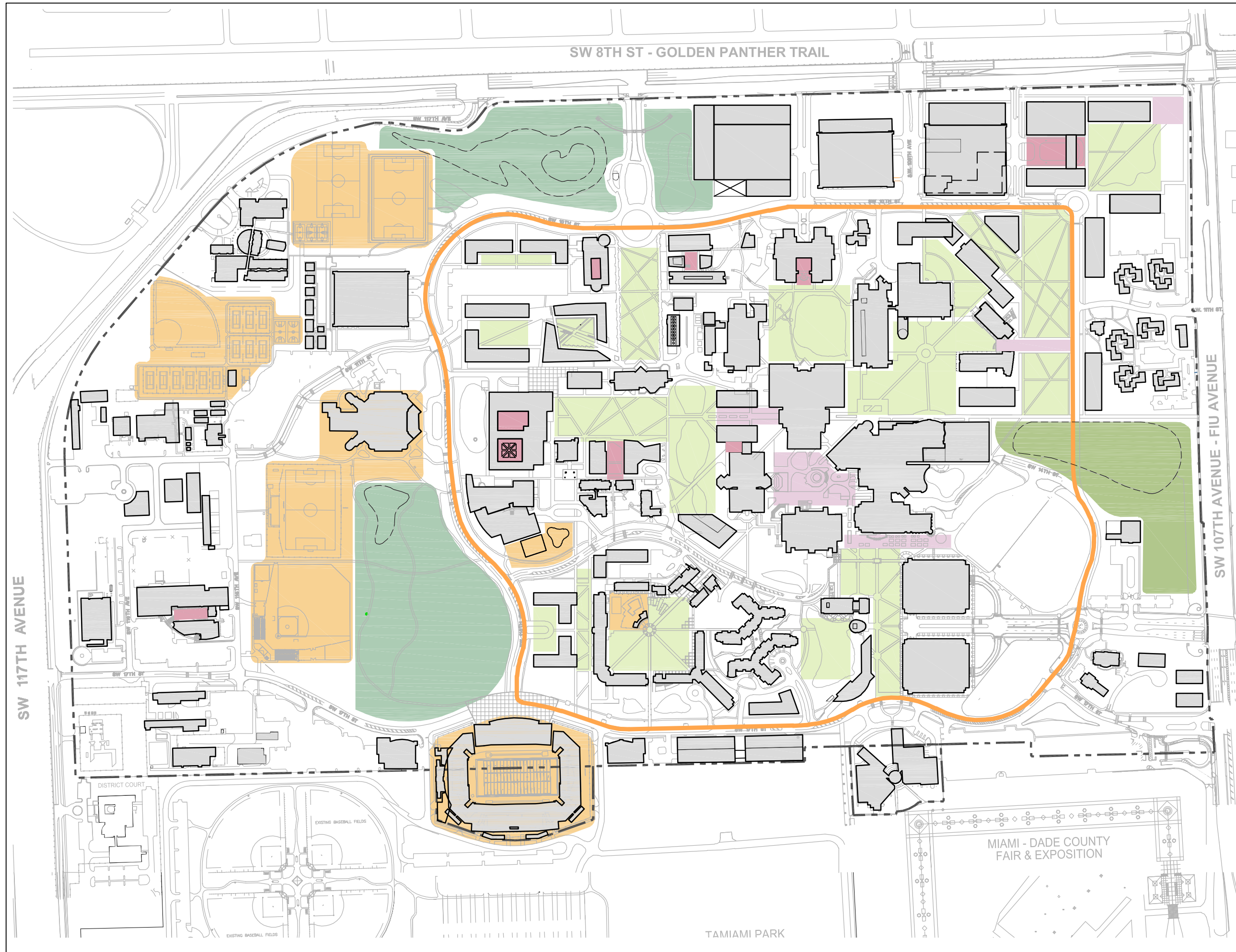

LEGEND

Gathering Space

- Quads
- Courtyards
- Plaza

Recreation Space

- Outdoor Recreation Space
- Recreation Loop

Special Purpose Landscape

- Teaching and Research Landscape
- Garden

KEY MAP

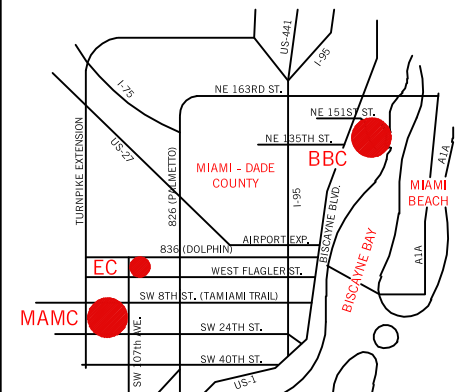
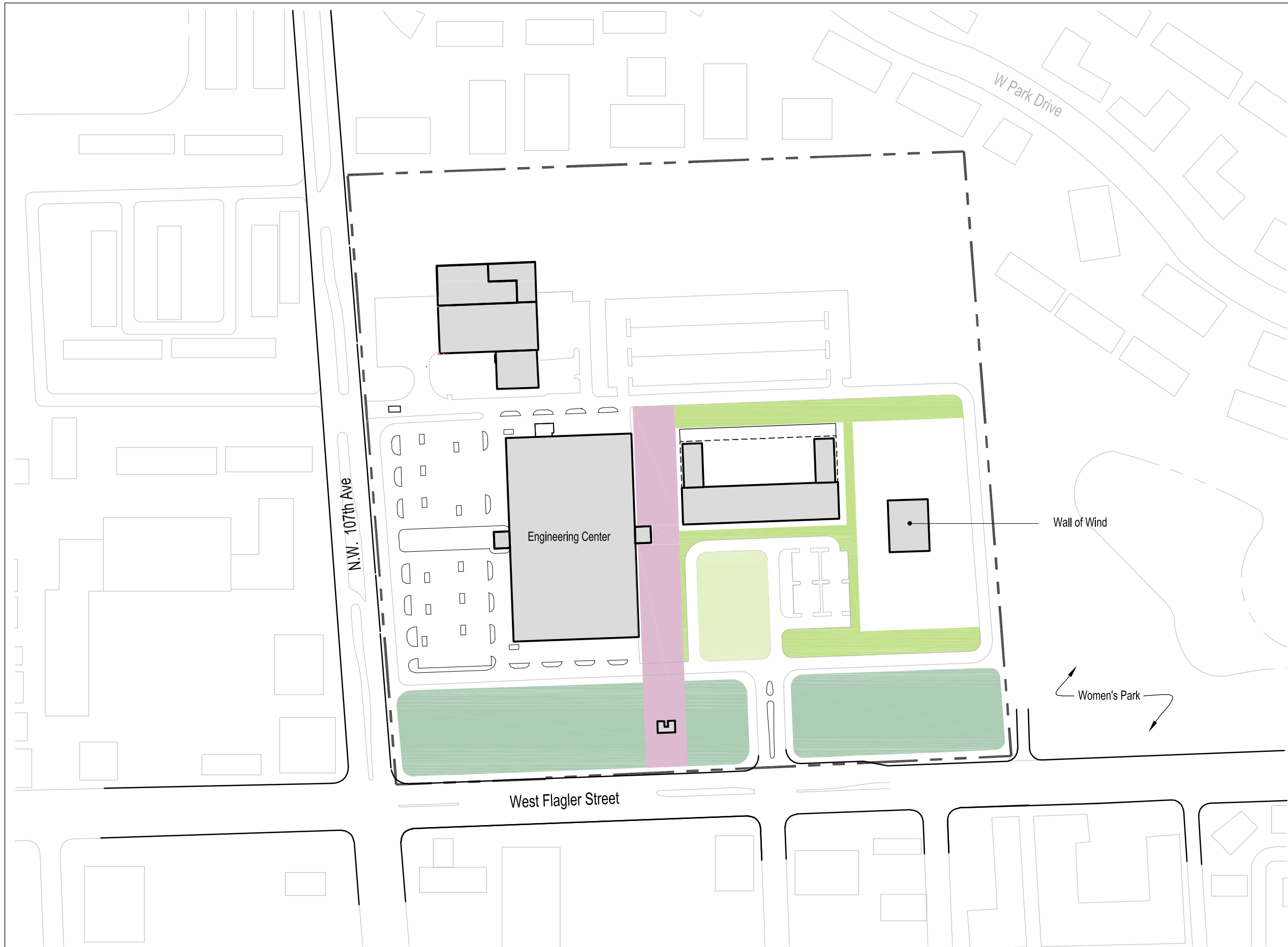

FIGURE: 8.1
Modesto A. Maidique Campus
2015 Open Space Concept Plan



Campus Master Plan - June 2010





LEGEND

- Gathering Space
- Quad
- Promenade
- Special Purpose Landscape
- Teaching & Research Landscape

KEY MAP

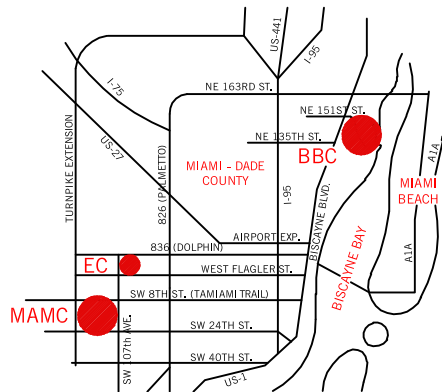

FIGURE: 8.2
Engineering Center
2015 Open Space Concept Plan



Campus Master Plan - June 2010



PERKINS
+ WILL

To Biscayne Blvd.
Via NE 151 Street

Bay Vista Blvd

City of North Miami

Oleta River State Park

Library

Wolfe university Center

Conference Center

Biscayne Bay

LEGEND

- Gathering Space
- Quads
- Recreation Space
- Outdoor Recreation Space
- Recreation Loop
- Special Purpose Landscape
- Teaching and Research Landscape

KEY MAP

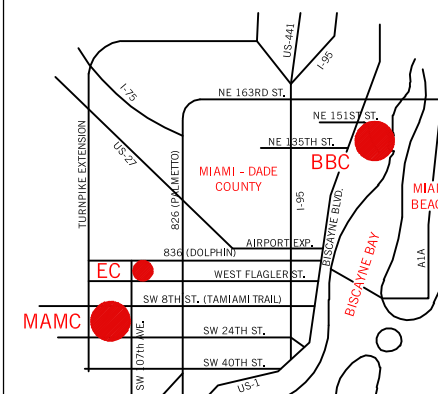

FIGURE: 8.3
Biscayne Bay
2015 Open Space Concept Plan

FIU | FLORIDA
INTERNATIONAL
UNIVERSITY

Campus Master Plan - June 2010

0 250 500 1000



**PERKINS
+ WILL**