

CAMPUS MASTER PLAN UPDATE 2010-2020

FIU | FLORIDA
INTERNATIONAL
UNIVERSITY

Transportation Element Focus Group Meeting #3



5 December 2012

PERKINS+WILL

1

Campus Master Plan 2010-2020 : Transportation Agenda

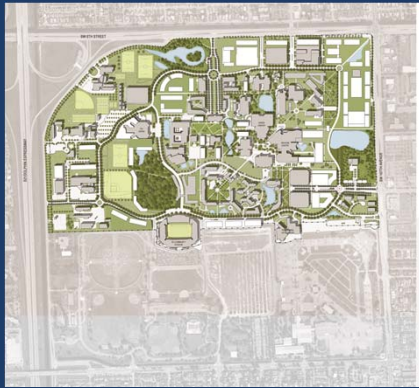

1. MMC



2. EC



3. BBC

- a. Inventory & Analysis Review
- b. Campus Vision Plan Review
- c. Campus Change since 2010

4. Implementation Strategies & Concepts

- a. Concept 1
- b. Concept 2
- c. Concept 3

Master Planning Schedule

Inventory & Analysis

July-Oct 2012

Preliminary Alternative Concepts

Nov-Dec 2012

Concept Plan Development

Jan 2013

Draft Comprehensive Master Plan

Feb-July 2013

Final Comprehensive Master Plan

Aug-Dec 2013

BOT Approval of Master Plan

Dec 2013

INVENTORY & ANALYSIS OVERVIEW

1a

Transportation & Parking Inventory and Analysis – MMC/EC

Parking-

- Adequate Capacity through 2020
- Improve Parking efficiency to allow CMP implementation
- Implement strategies to minimize parking demand/Single Occupancy Vehicle (SOV) trips

Transit

- Encourage increased ridership on public and FIU provided transit
- Potential MDT Express Bus hub at MMC
- Expand community shuttle system connections (Sweetwater/Doral)

Bike and Pedestrian

- Improve pedestrian routes/safety from garages/parking to Campus core.
- Improve Bicycle facilities on campus and encourage off campus improvements

Safety

- Designated Bike lanes
- Pedestrian crosswalks

Transportation & Parking Inventory and Analysis – MMC/EC

On-Campus Roadways

- Peak volume intersection levels of service
- Segment improvements to accommodate current use and CMP implementation
- Implement strategies to minimize parking demand/Single Occupancy Vehicle (SOV) trips

Off- Campus Roadways

- Adequate levels of service
- Improvements to SW 8th Street and SW 107th Avenue intersection
- Need for bike lanes/ connectivity
- Pedestrian friendly streetscapes

Transportation Demand Management Strategies

- Reduce parking reliance/demand
- Enhance transit ridership
- Bicycle and pedestrian improvements
- On-Campus housing
- Transit Oriented Development (TOD)

Transit, Parking and Service Map – MMC

LEGEND

- Transit Route
- Parking Garages
- Surface Parking Lots
- Service/Loading Area
- Transit Stop

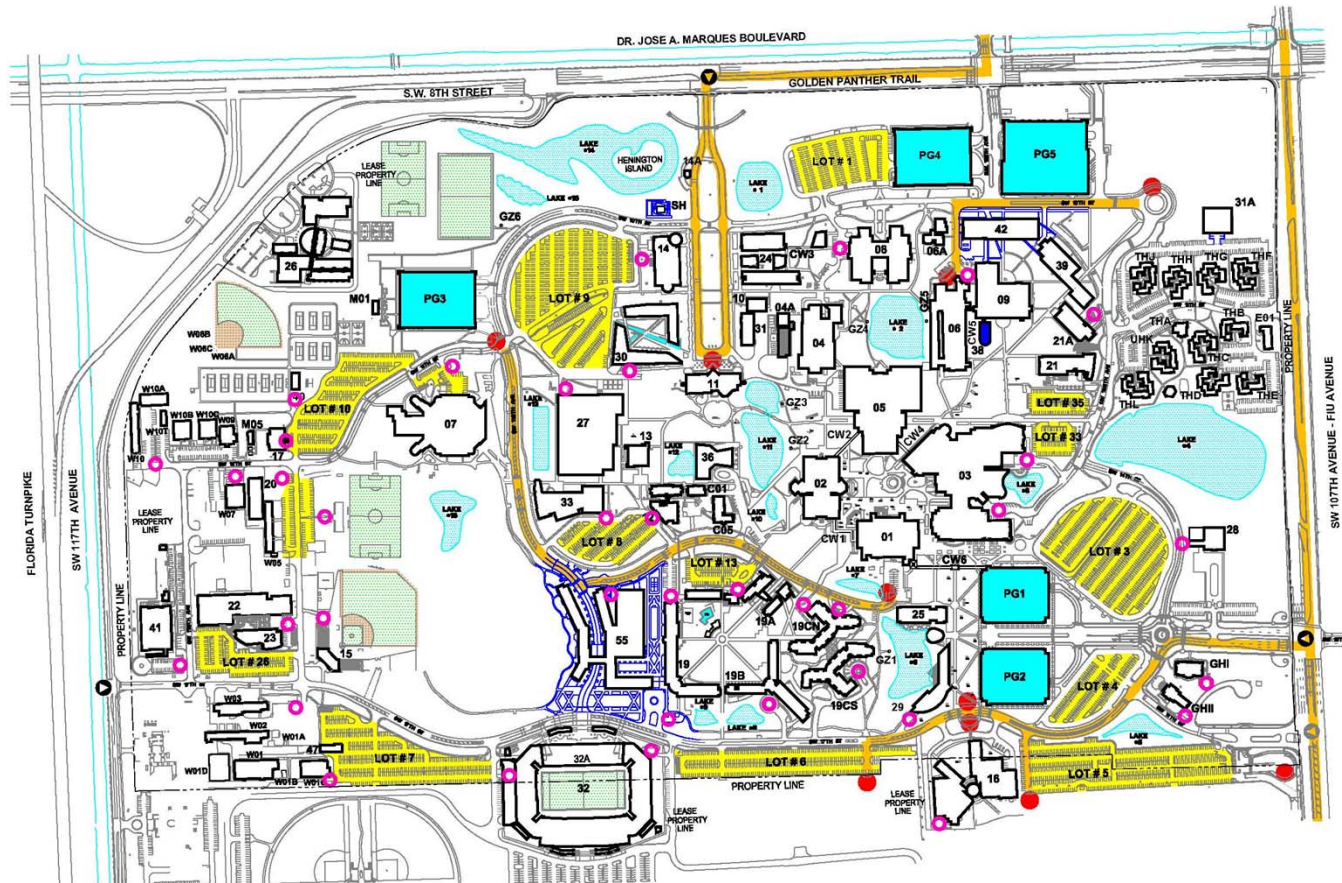

Pedestrian and Bicycle System Map – MMC

LEGEND

- Primary Pedestrian Route
- Golf Cart Exclusion Area
- Crosswalks

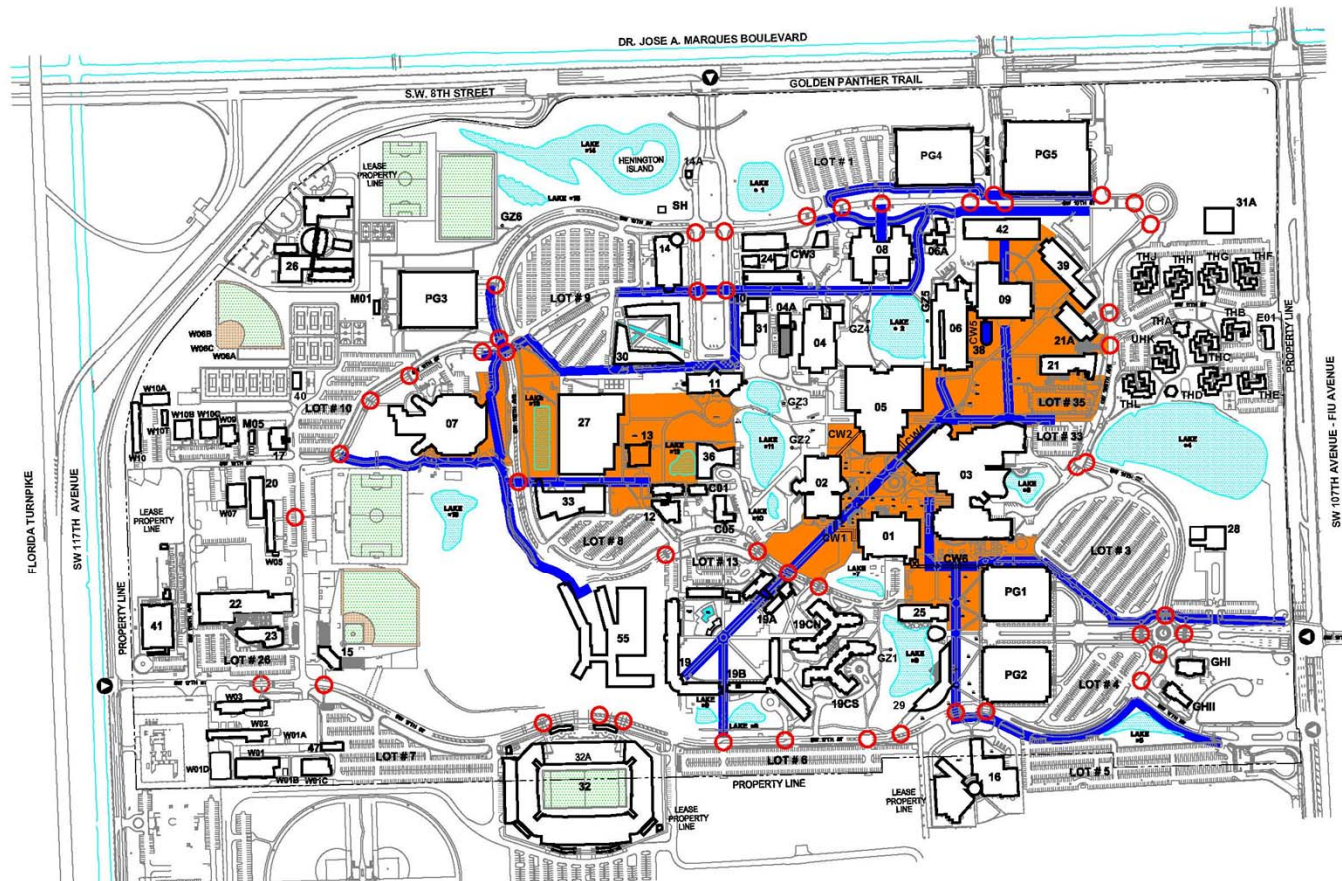

Key Transportation Issues Map – MMC

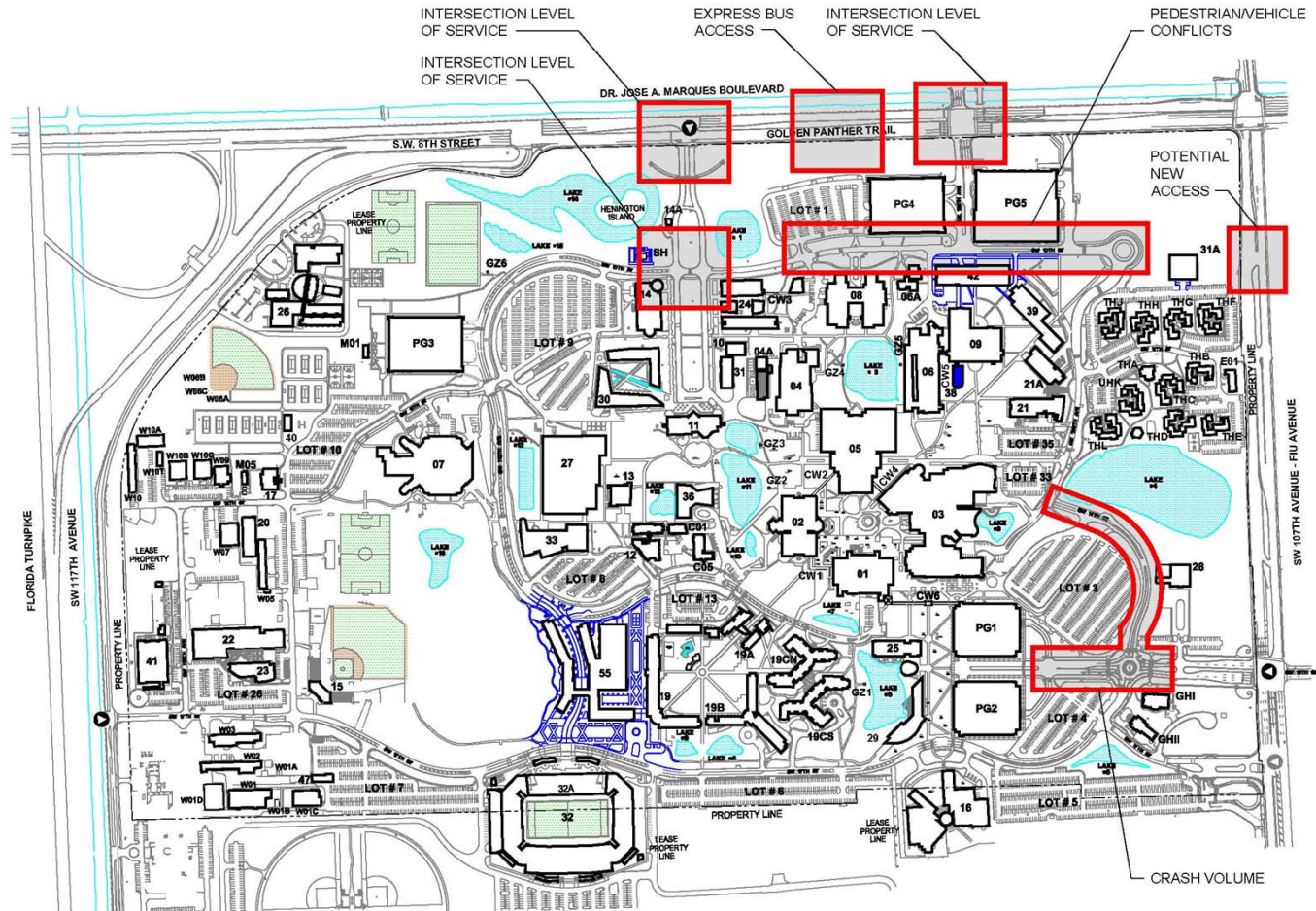

Transit, Parking and Service Map – EC



Pedestrian and Bicycle System Map – EC

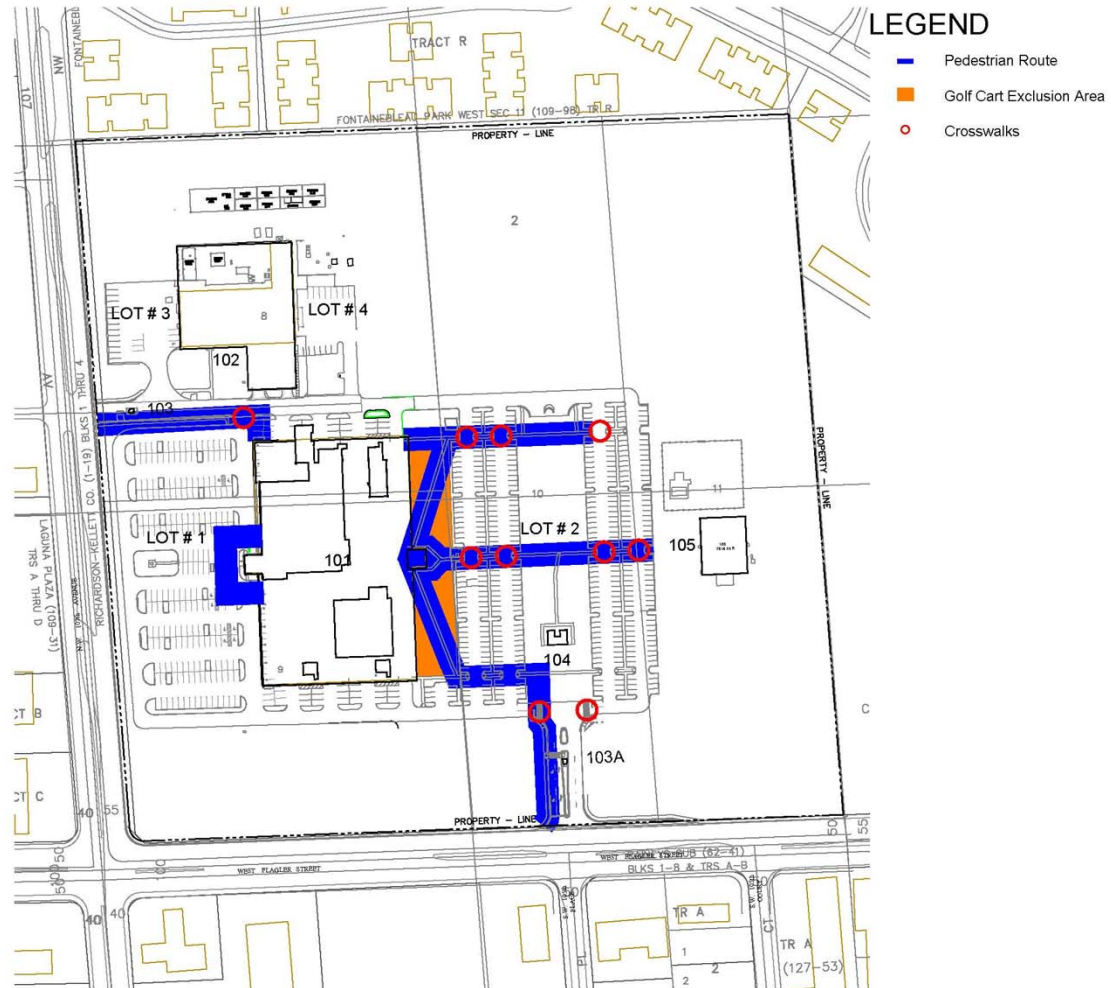

Transportation & Parking Inventory and Analysis – BBC

Parking-

- Adequate Capacity through 2020
- Implement strategies to minimize parking demand/Single Occupancy Vehicle (SOV) trips

Transit

- Encourage increased ridership on public and FIU provided transit
- Expand community shuttle system connections (North Miami Express)

Bike and Pedestrian

- Improve pedestrian/bike link to Oleta State Park to provide connectivity for North Miami community
- Improve Bicycle facilities on campus
- Secure continuous bike lane from Biscayne Boulevard

Safety

- Second campus vehicular access

Transportation & Parking Inventory and Analysis – BBC

Off- Campus Roadways

- Adequate levels of service
- Improvements to Biscayne Boulevard and 151 Street intersection
- Need for continuous bike lanes/ connectivity
- Pedestrian friendly streetscapes

Transportation Demand Management Strategies

- Reduce parking reliance/demand
- Enhance transit ridership
- On-Campus housing
- Transit Oriented Development (TOD) – Biscayne Landings/transit hub

Transit, Parking and Service Map – BBC

LEGEND

-  Proposed Building
-  Transit Route
-  Surface Parking
-  Service/Loading Area
-  Transit Stop

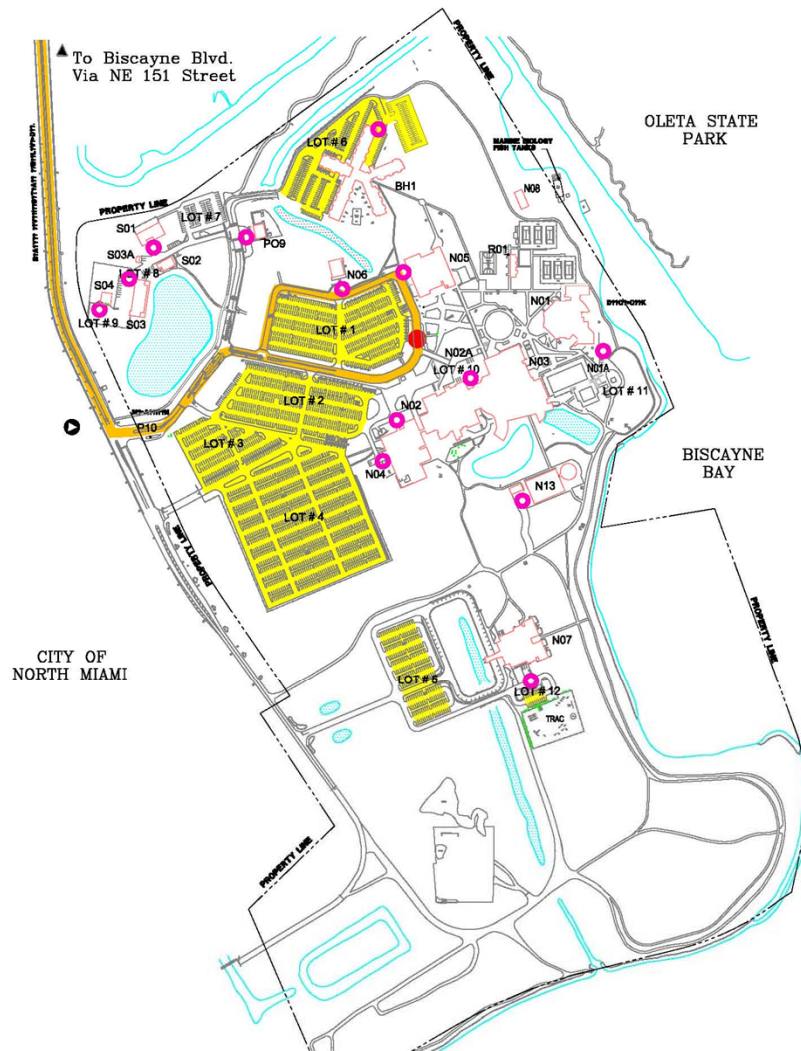

Pedestrian and Bicycle System Map – BBC

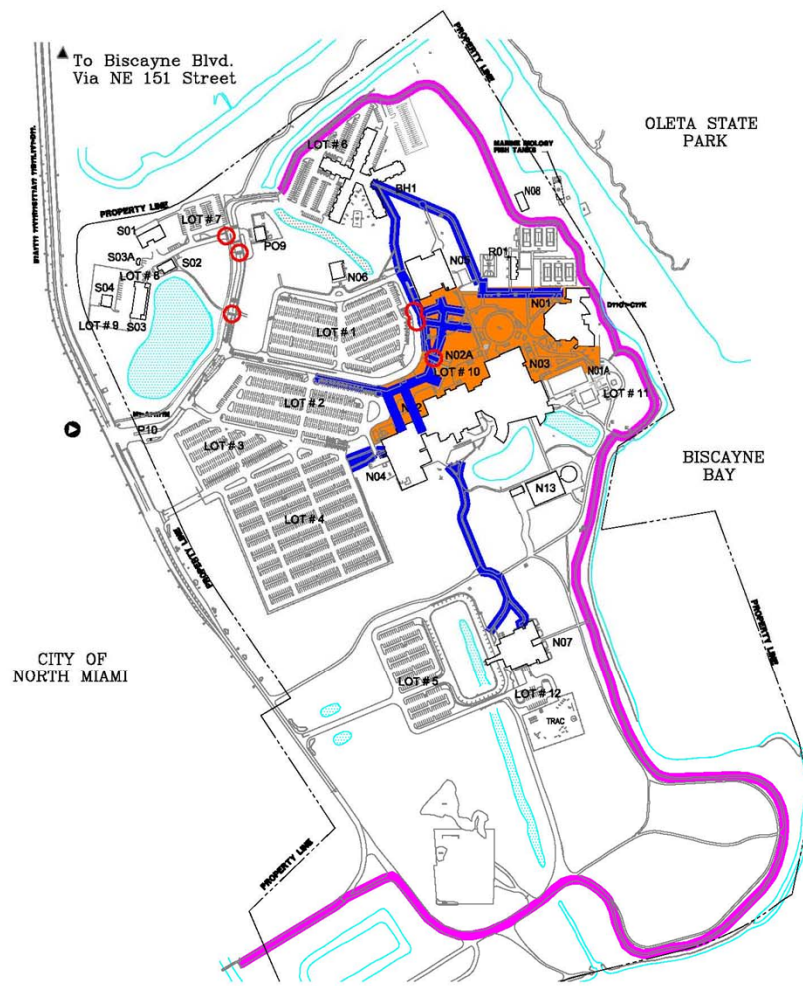

LEGEND

- Pedestrian Route
- Designated Bike Route
- Golf Cart Exclusion Area
- Crosswalks

ALTERNATE IMPLEMENTATION STRATEGIES

4

Campus Guiding Principles

- Develop a **sustainable** campus environment.
- Develop forward looking, **innovative and interdisciplinary** learning and research environments.
- **Reinforce FIU's identity** through the articulation of landmarks, precincts, edges, buildings, and open spaces.
- Create a more **compact urban environment**.
- Develop comprehensive **multi-modal solutions to transportation & infrastructure**.
- Establish better **connectivity with neighboring communities**.
- Create a safe, connected, **pedestrian-friendly** campus.
- Site core academic programs along **main axes**.
- Develop **student life mixed use communities**.
- Foster learning through **multipurpose open space**.

Sustainable Planning Principles

- ***Multi-modal circulation*** and access to planned metro transit systems
- Mixed use parking decks at perimeter of campus
- More ***compact urban environment*** with connectivity to community
- Student residential community with mixed use amenities on campus
- Creating “***green lungs***” with open space quadrangles, courtyards, landscaping, and water features
- ***Campus green belt*** for pedestrian and vehicular movement
- ***Building guidelines*** encouraging natural ventilation, shading, and daylighting in exterior and interior spaces to reduce energy consumption
- Outdoor ***lighting guidelines*** for efficient energy use
- ***On-site storm water treatment and management***
- ***Landscape guidelines*** for shade, filtration and water efficiency
- Recycling/composting: facilities, construction, mail/print services, dining
- ***Thermal Energy Storage*** (ice tanks) planned with new chiller plants
- ***Precinct plants***: mini-loops for efficiency and shared redundancy

OPTION #1

Expand in Place / Create a Strong Core

4a

Expand in Place | Create a Strong Core

Key Characteristics

- **Program expansion consolidates current campus districts**
- **Infill buildings and additions strengthen each campus core**
- **Preserves future perimeter building sites at each campus**
- **Maximizes growth at MMC**
- **Minimizes growth at EC and BBC**

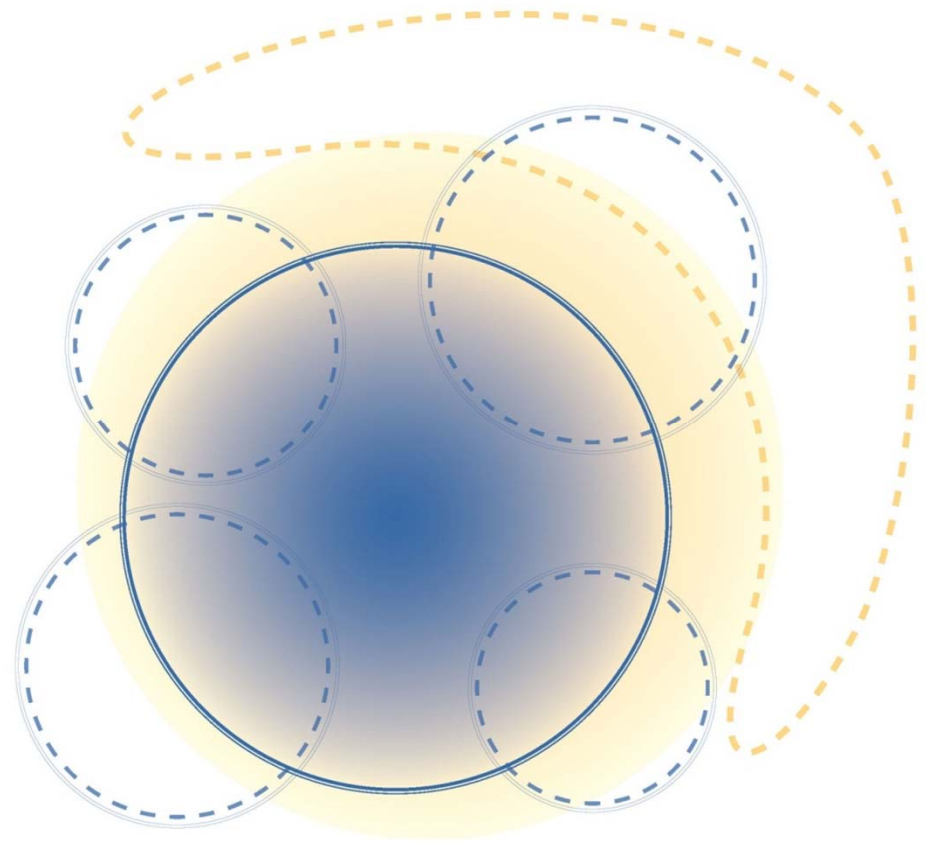

Concept 1

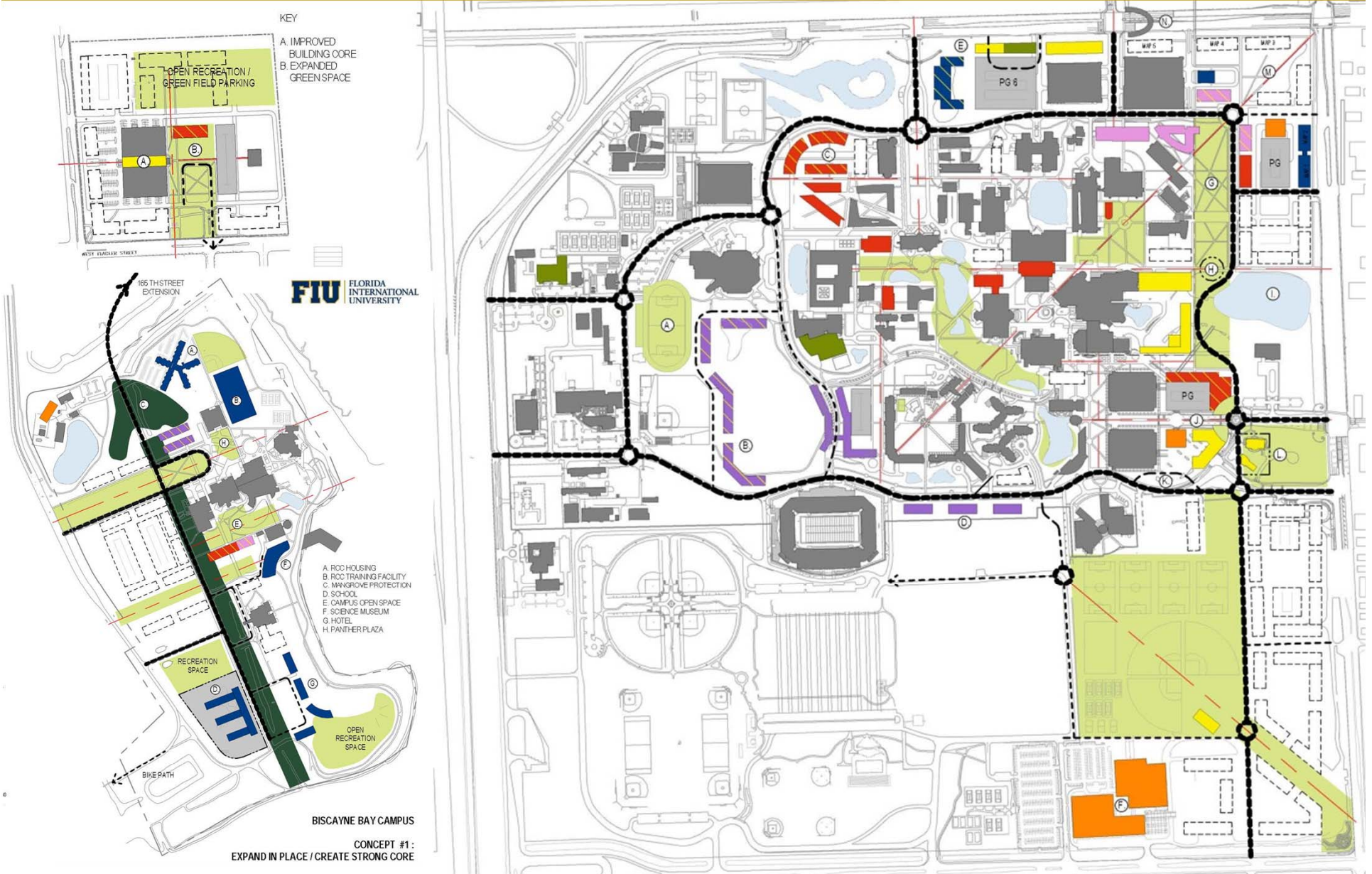

CONCEPT #2

Shift Programs / Reinforce Campus Identity

4b

Shift Programs | Reinforce Campus Identity

Key Characteristics

- **Academic Health programs strengthen MMC identity**
- **Engineering, Math and Computing programs strengthen EC identity**
- **Hospitality, Education and Environmental Science programs strengthen BBC identity**
- **Maximizes future MMC flexibility**
- **Maximizes balanced growth across campus**

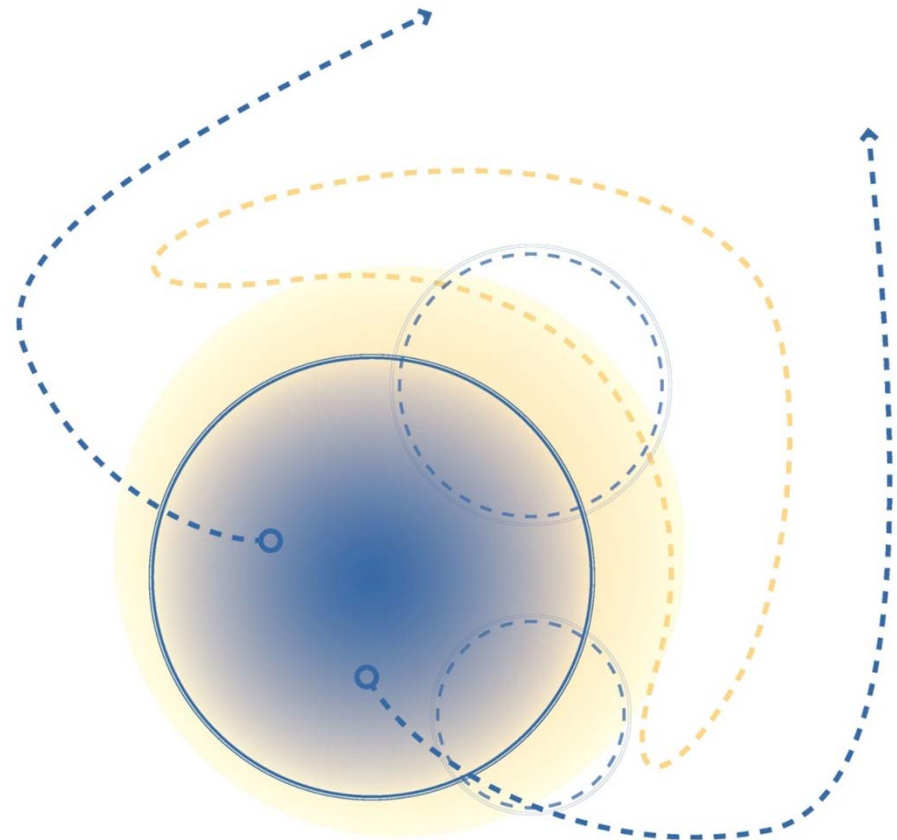

Concept 2

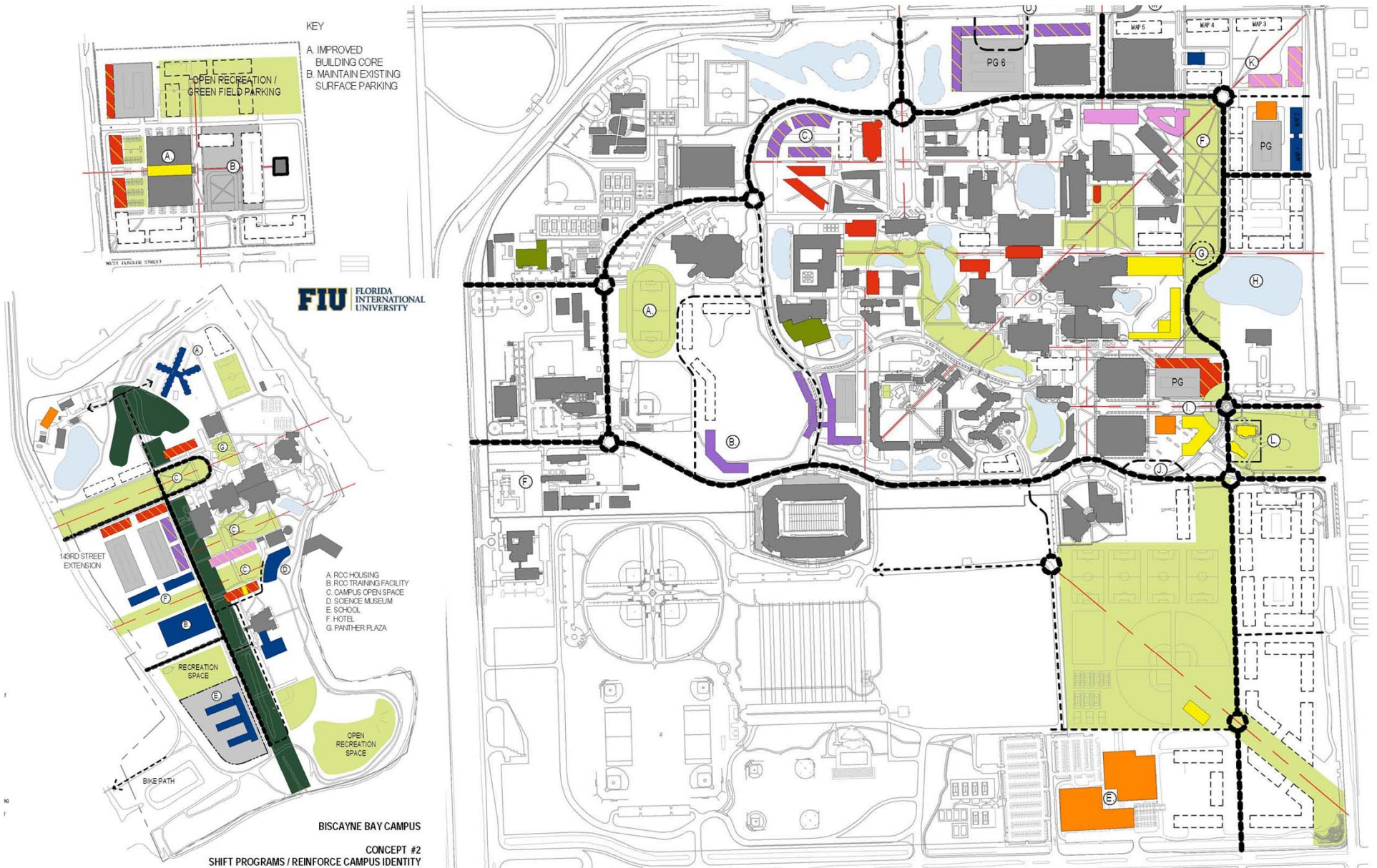

OPTION #3

Expand at the Perimeter / Reinforce Partnerships

4e

Expand at the Perimeter | Reinforce Partnerships

Key Characteristics

- **Focuses growth at each campus perimeter**
- **Strengthens sites for visible partnerships**
- **Repositions EC highest and best use**
- **Shifts Engineering to MMC**
- **Maximizes future campus core infill opportunities**

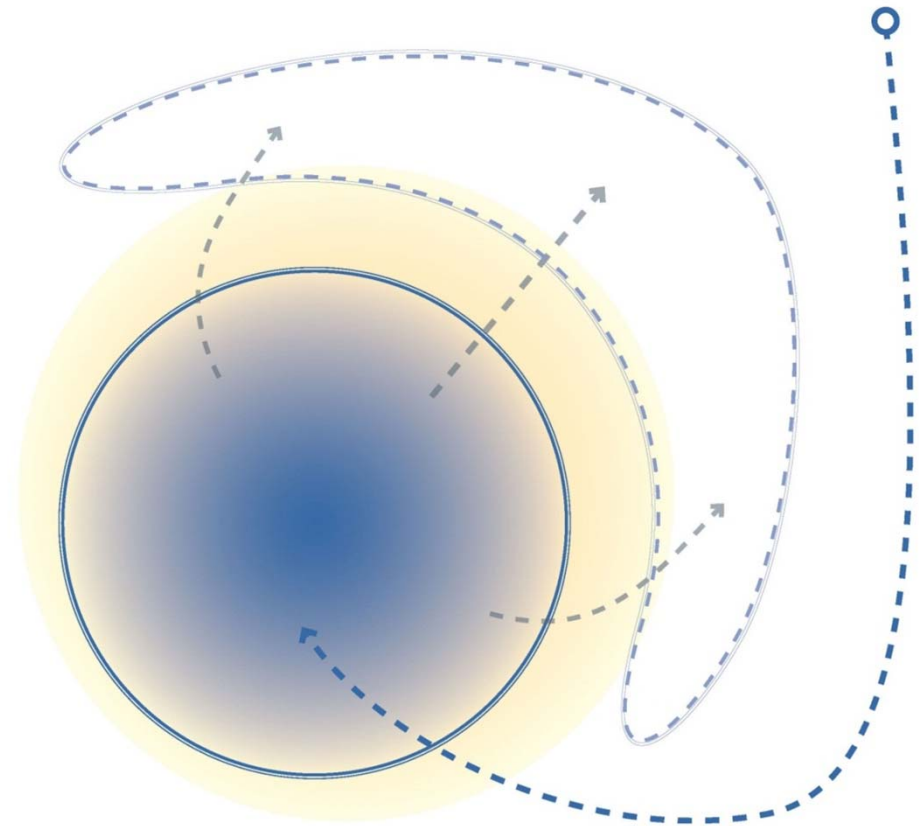

Concept 3

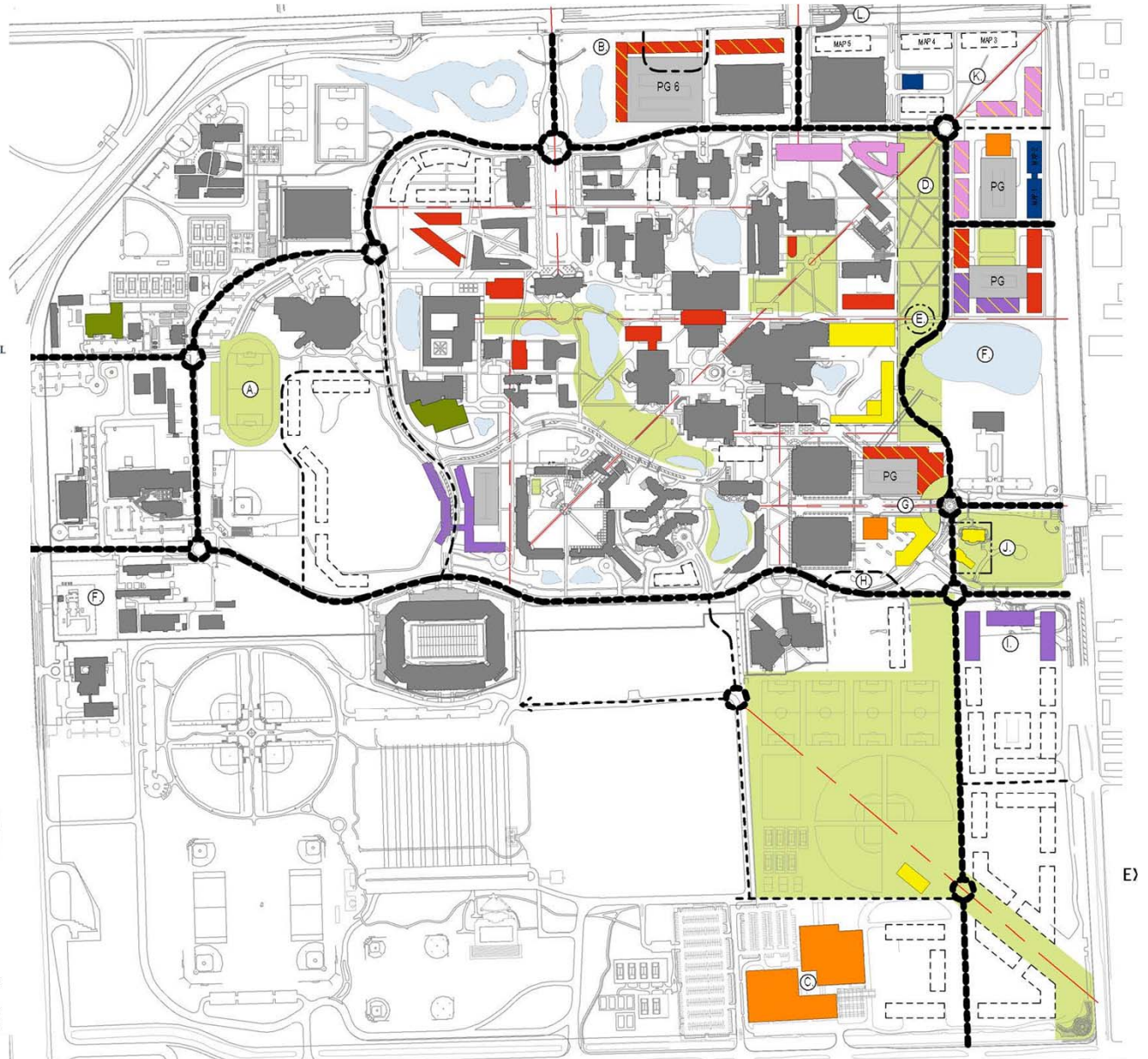
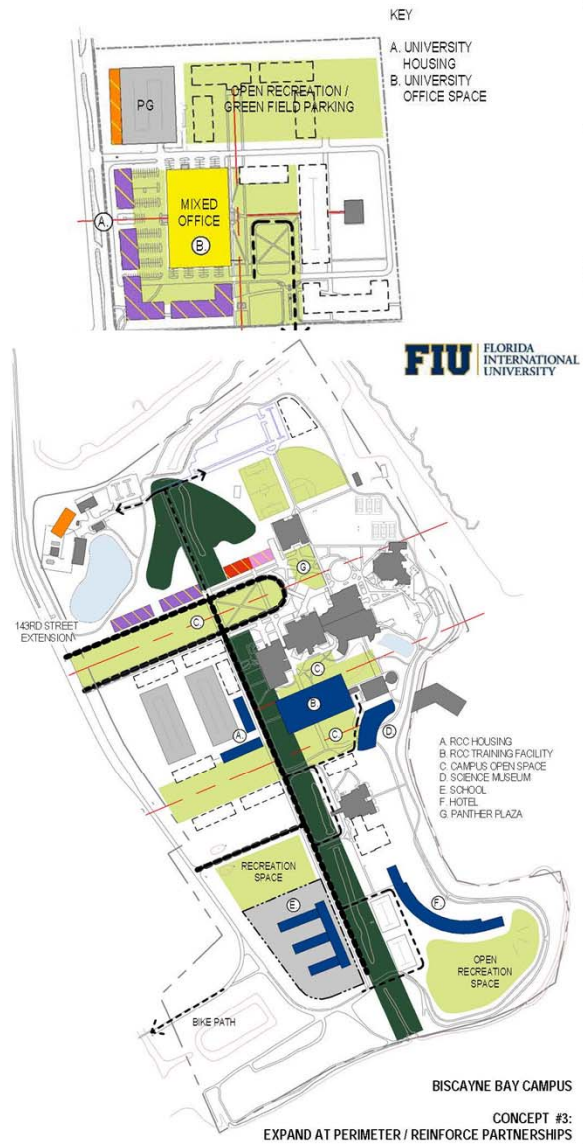

DISCUSSION

5