

CAMPUS MASTER PLAN UPDATE 2010-2020

FIU | FLORIDA
INTERNATIONAL
UNIVERSITY

Focus Group 4- Housing,
Student Life & Support
Meeting #4



Campus Master Plan 2010-2020

Meeting #4 Agenda

- 1. Review Schedule / December Minutes**
- 2. Review Campus Vision Plan**
- 3. Review Preliminary 2020 Concept Plan Elements**
 - a. Facility Use**
 - b. Land Use**
 - c. Open Space**
 - d. Circulation/Parking**

Master Planning Schedule

Inventory & Analysis

July-Oct 2012

Preliminary Alternative Concepts

Nov-Dec 2012

Concept Plan Development

Jan 2013

Draft Comprehensive Master Plan

Feb-July 2013

Final Comprehensive Master Plan

Aug-Dec 2013

BOT Approval of Master Plan

Dec 2013

Key Characteristics: Create a Strong Core

- **Expand programs to strengthen current successful campus districts and interdisciplinary practices**
- **Infill buildings and additions discretely to “densify” campus core for collegiality, walkability and livability**
- **Preserve open space for inspiration, education and recreation**

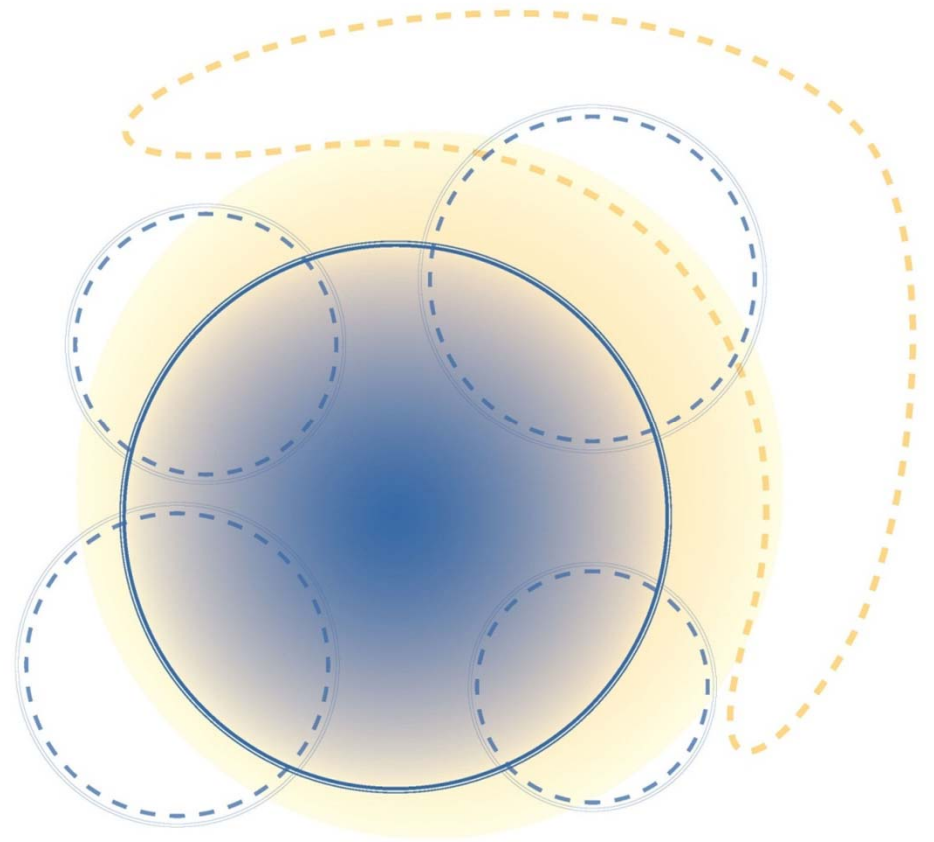

Key Characteristics: Reinforce Identity

- **Position Academic Health programs for high access and outreach**
- **Position Engineering, Math and Computing programs to successfully relocate to MMC over time**
- **Position Journalism, Hospitality, Education and Environmental Science programs to strengthen BBC identity**

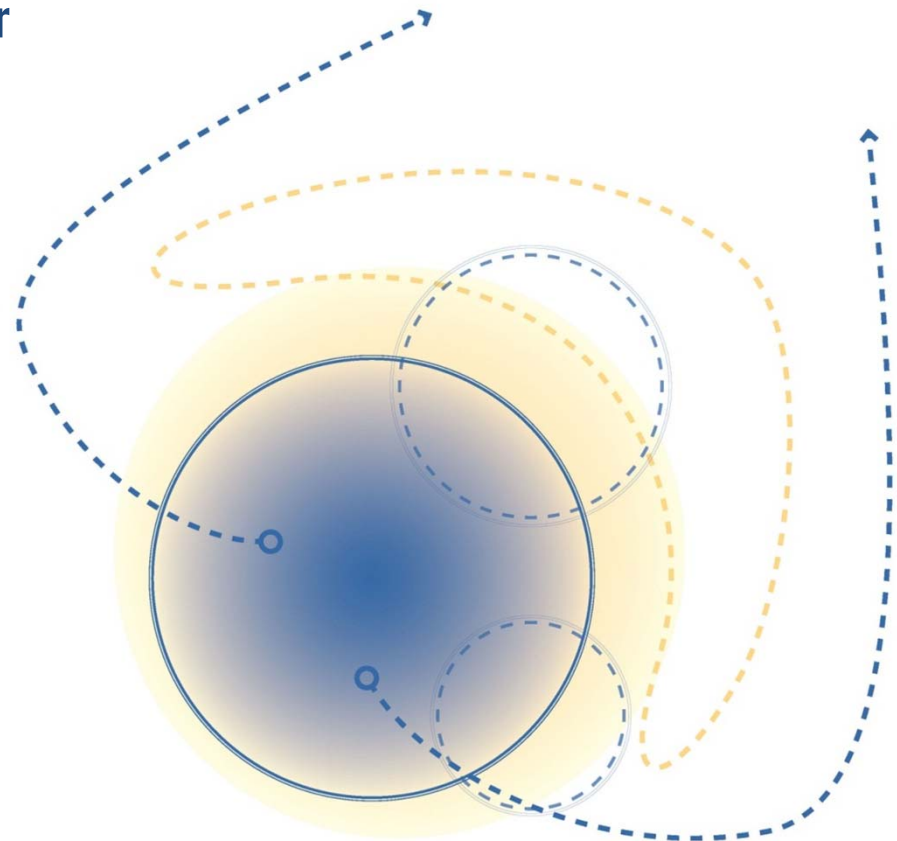

Key Characteristics: Reinforce Partnerships

- **Focus externally funded growth at the campus perimeter**
- **Reserve MMC partnership sites to meet requirements for high access, high visibility, and flexible opportunities**
- **Reposition EC / partnership sites for highest and best use**
- **Landbank sites at BBC in light of limited access**

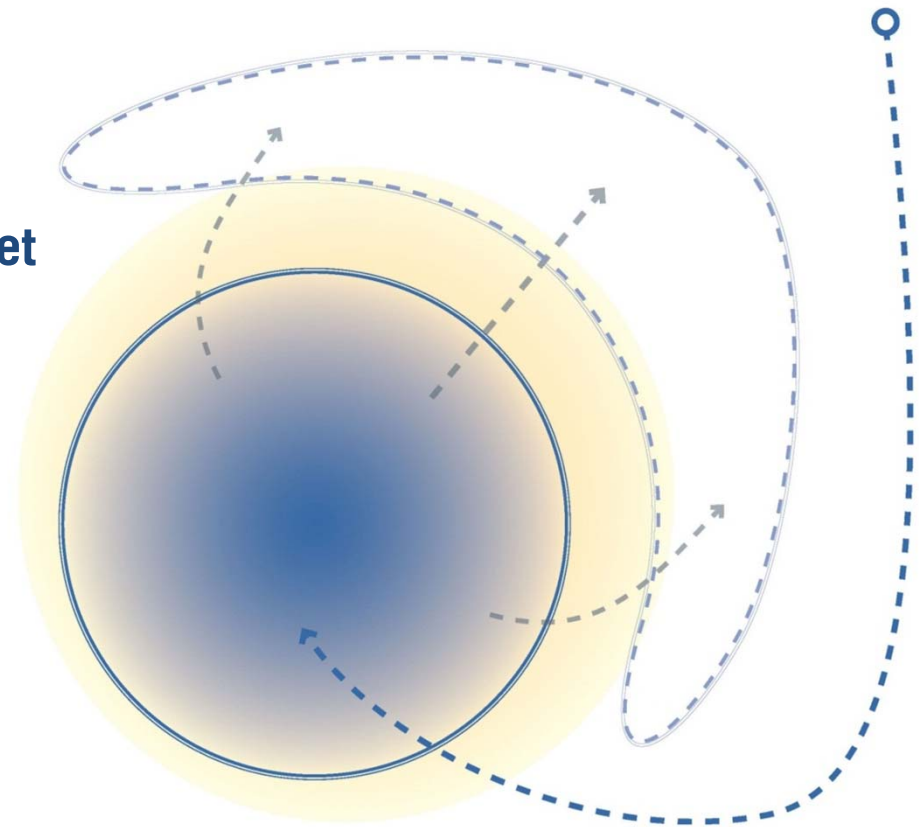

Overall 2020 New Space Needs

FIU NEEDS BEYOND CAPITAL PROJECTS

ACADEMIC: 951,600 SF

SUPPORT: 476,000 SF

RESEARCH: 246,900 SF

FACILITY SUPPORT: 116,900 SF

RECREATION: 90,900 SF

CLINIC: 35,200 SF

TOTAL: 1,917,500 SF

HOUSING: 1,002,950 SF /3086 BEDS (includes replacement)

RECREATION FIELDS/ COURTS:

NIRSA STANDARDS:

SOCCER/ FOOTBALL FIELDS

5 This assumes continued use of Mourning High

SOFTBALL FIELDS

4 This assumes fields at Tamiami Park are still used

TENNIS COURTS

3

VOLLEYBALL COURTS

3

COUNTY STANDARDS:

13.75 ACRES TOTAL REQUIRED

Additional 2035 Space Needs

FIU NEEDS BEYOND 2020

| | |
|-------------------|---------------------------------|
| ACADEMIC: | 511,000SF |
| SUPPORT: | 324,400 SF |
| RESEARCH: | 173,000 SF |
| FACILITY SUPPORT: | 28,500 SF |
| RECREATION: | 44,300 SF |
| STUDENT CLINIC: | 15,450 SF |
| TOTAL: | 1,096,650 SF |
| HOUSING: | 1,509,000 SF (4043 BEDS) |

RECREATION FIELDS/ COURTS:

NIRSA STANDARDS:

| | |
|-------------------------|--|
| SOCCER/ FOOTBALL FIELDS | 3 This assumes continued use of Mourning High |
| SOFTBALL FIELDS | 2 This assumes fields at Tamiami Park are still used |
| TENNIS COURTS | 6 |
| VOLLEYBALL COURTS | 2 |
| BASKETBALL COURTS | 2 |

COUNTY STANDARDS:

20.62 ACRES TOTAL REQUIRED

MMC PLAN REVIEW

Modesto Maidique Campus Development Framework

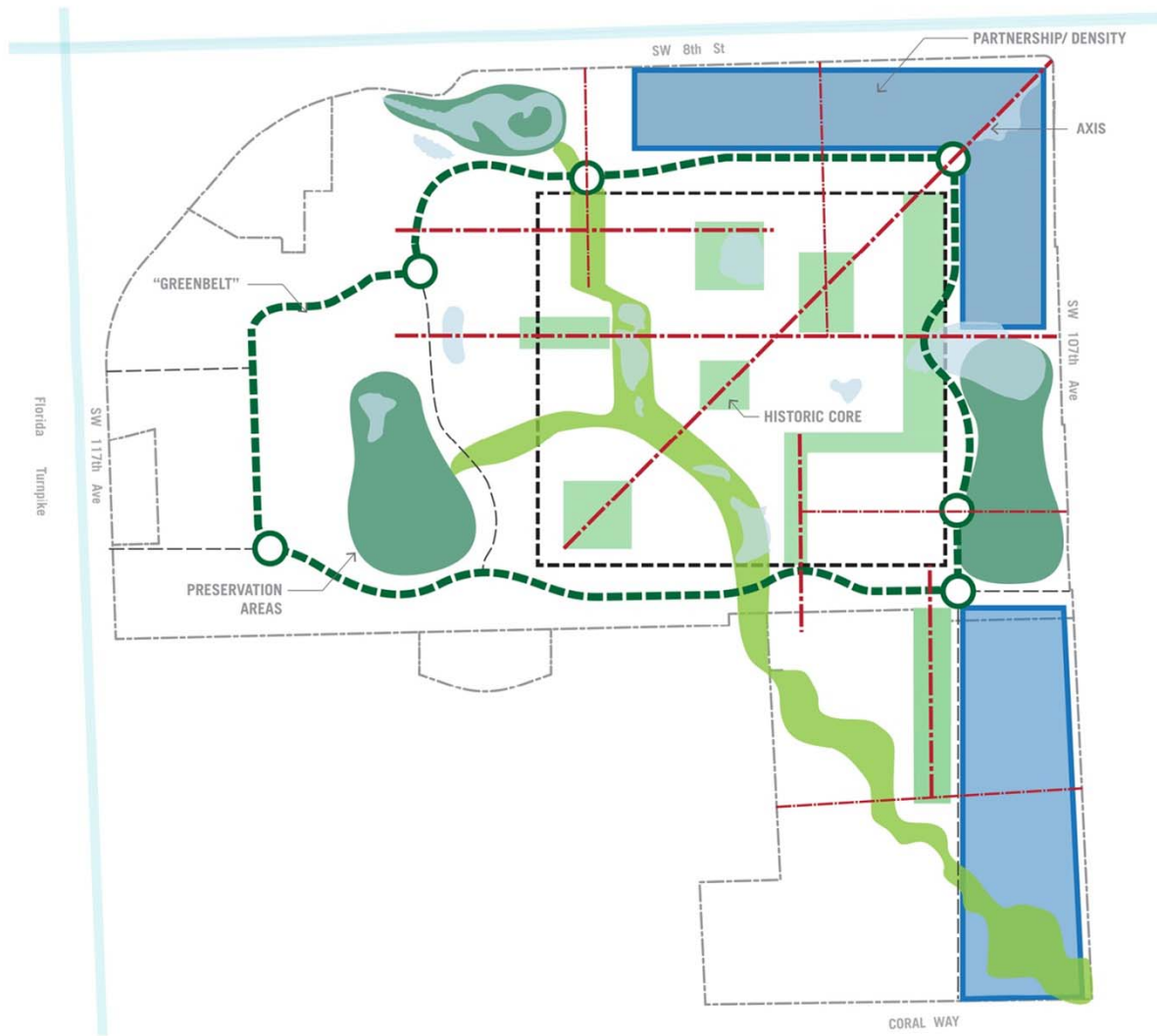

January 9, 2013

Modesto Maidique Campus

Urban Design Framework - Vision

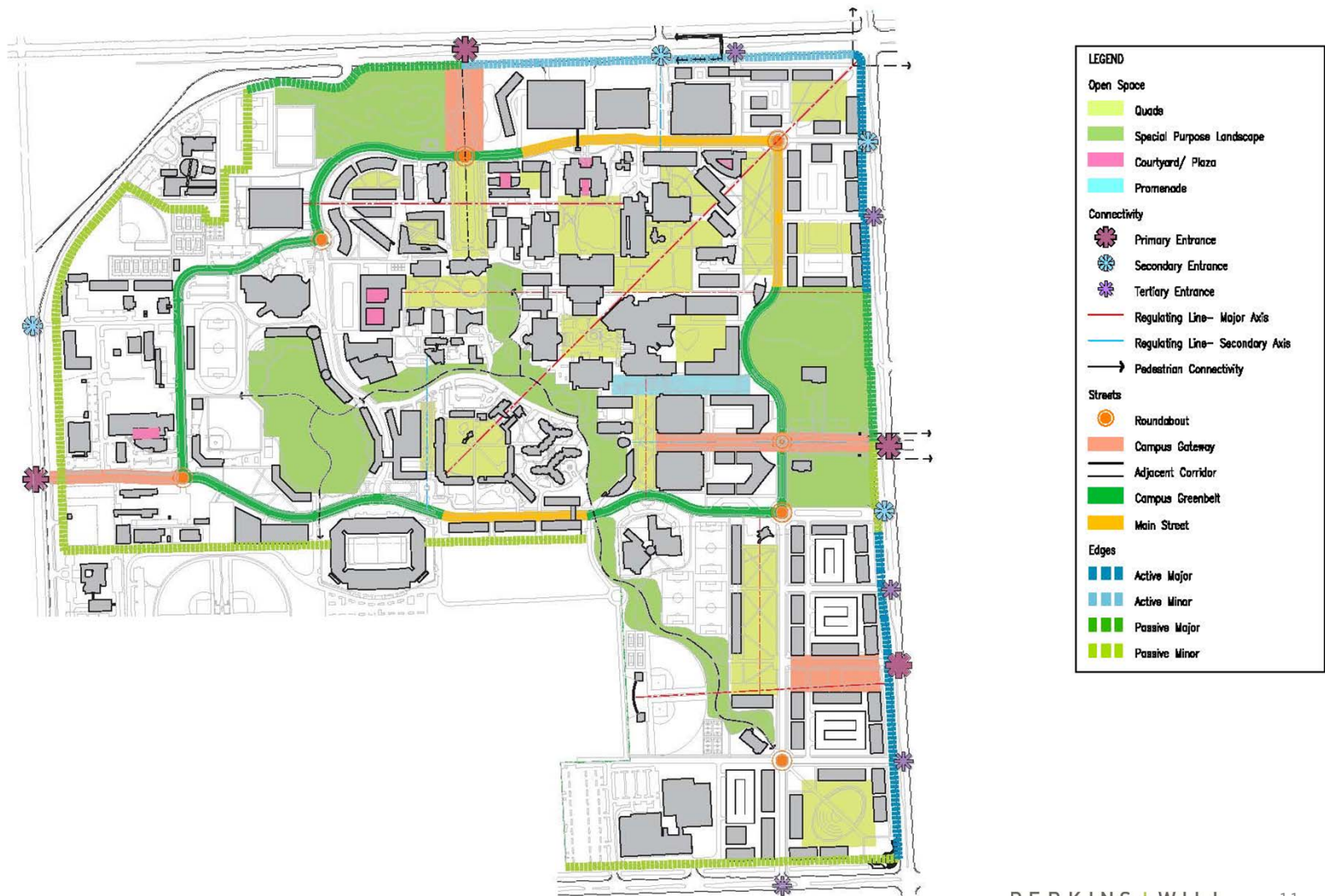

Modesto Maidique Campus

Vision Plan

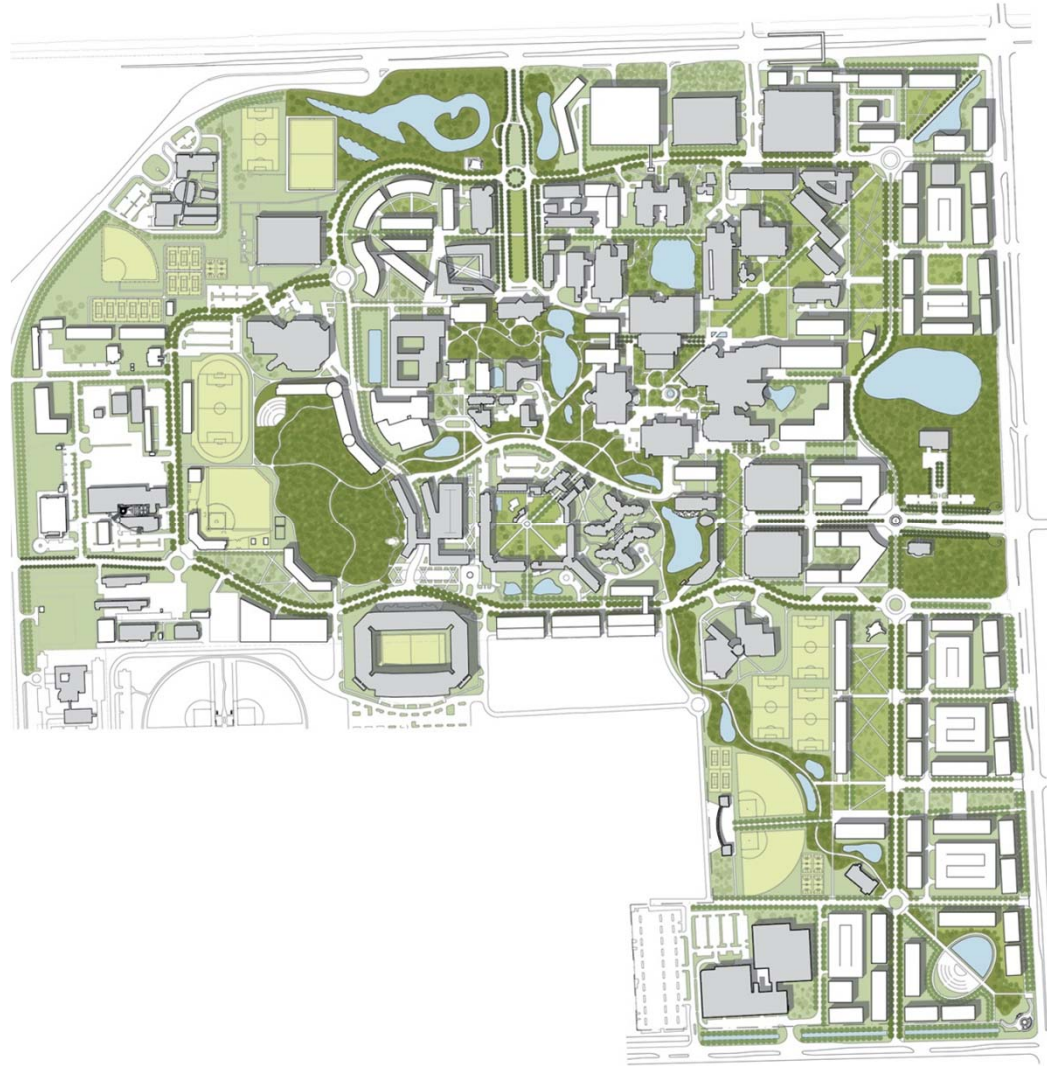

January 9, 2013

PERKINS+WILL

12

MMC – 2035 Facility Use

LEGEND

- ACADEMIC
- RESEARCH
- SUPPORT
- 1ST FLOOR SUPPORT
- HOUSING
- PARTNERSHIP
- SPORTS / RECREATION
- FACILITY SUPPORT
- OPEN SPACE
- NEPP PARKING
- VISION PLAN BUILDING
- ROAD REALIGNMENT
- CAMPUS AXES

KEY:

- A. EXPANDED TRACK AND FIELD
- B. AMPHITHEATER
- C. EXPANDED UNIVERSITY HOUSING
- D. GREEK HOUSING
- E. HOTEL
- F. GRADUATE HOUSING
- G. ACADEMIC/RESEARCH AREA
- H. EXPANDED RECREATION FIELDS
- I. EXPANDED UNIVERSITY HOUSING
- J. MIXED USE DISTRICT
- K. AMPHITHEATER
- L. FACILITY SUPPORT AREA

MODESTO MAIDIQUE CAMPUS

2035 PROPOSED PLAN



January 8, 2013

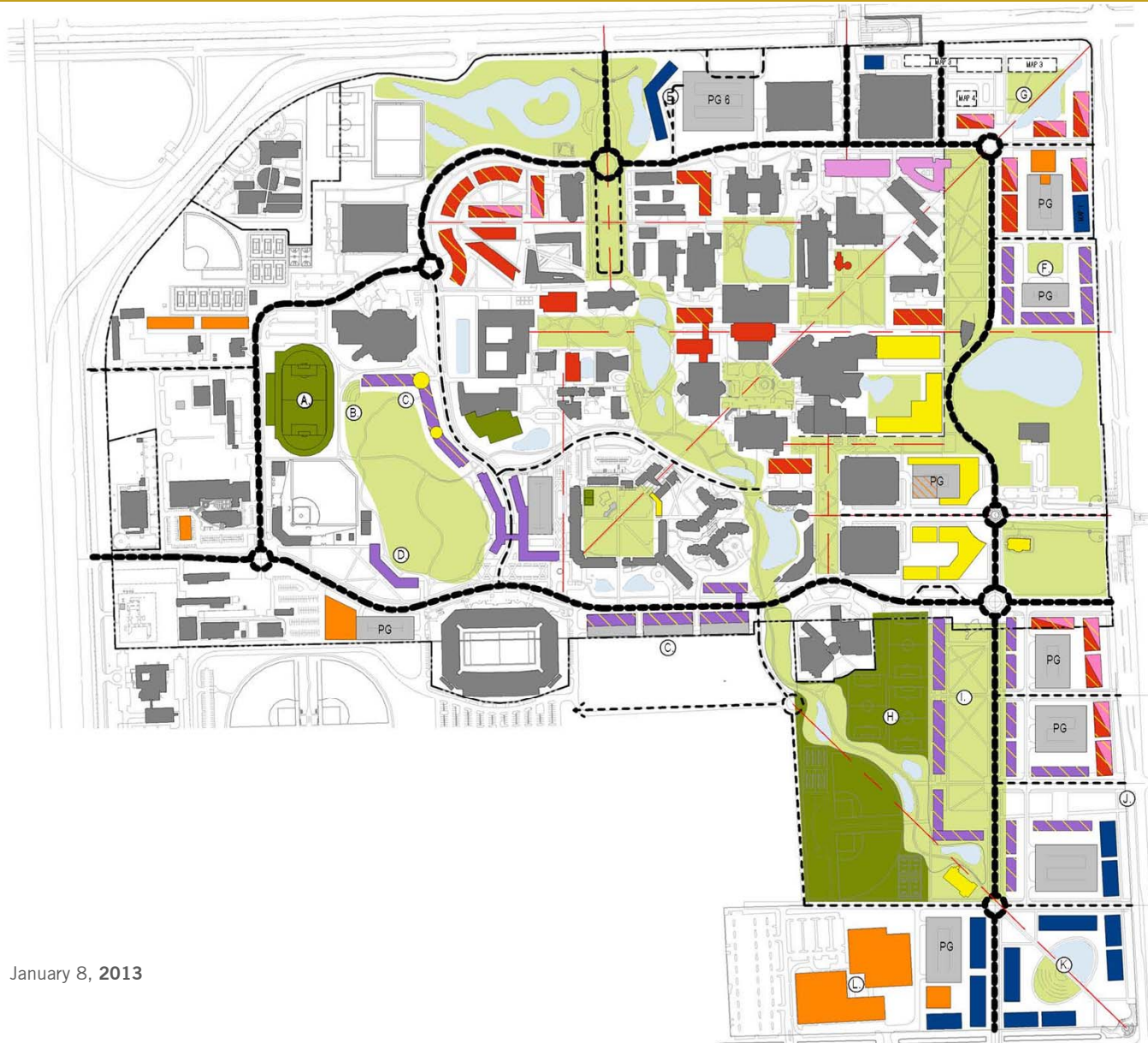

Modesto Maidique Campus

Facility Use

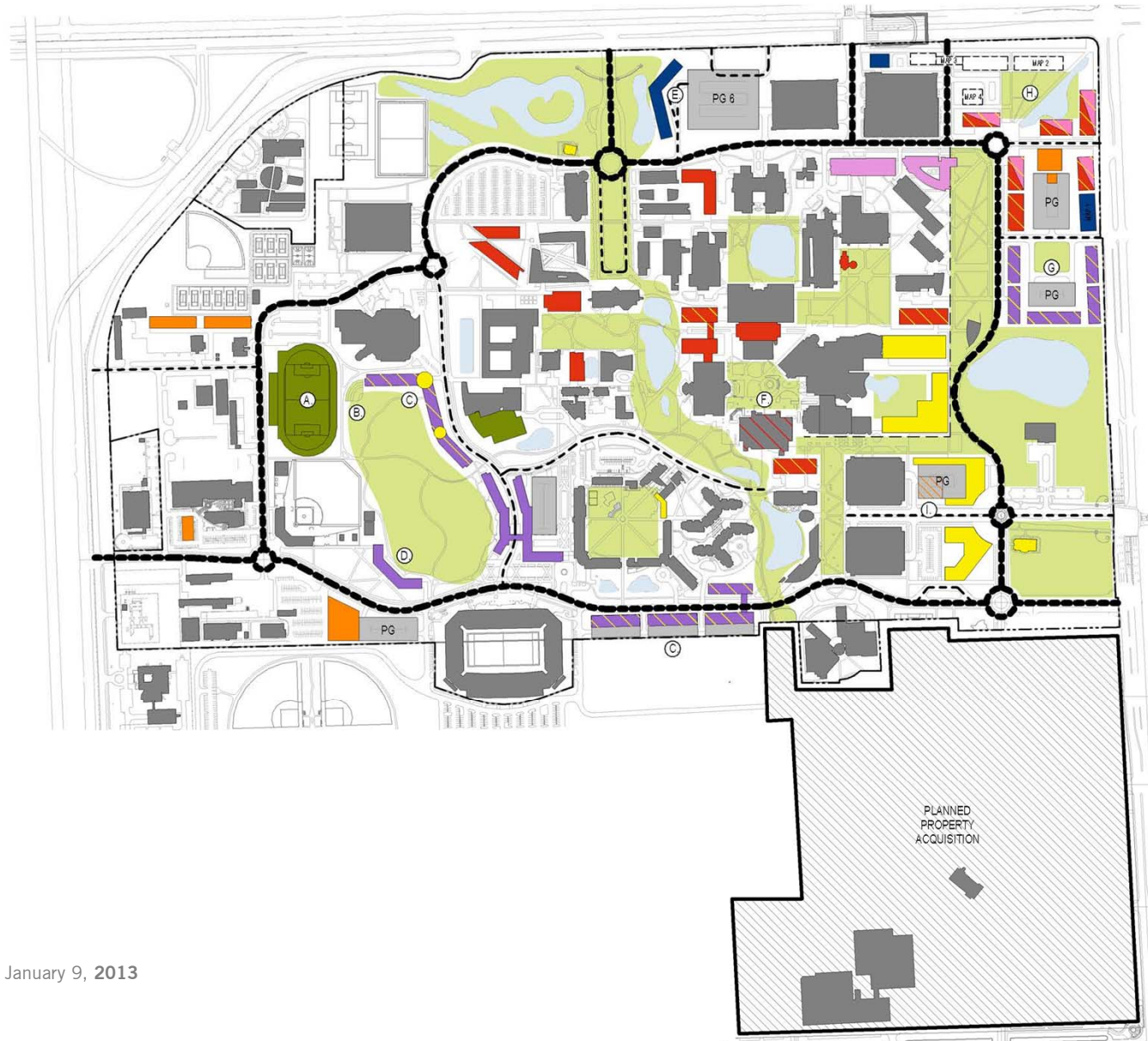

- LEGEND**
- ACADEMIC
 - RESEARCH
 - SUPPORT
 - 1ST FLOOR SUPPORT
 - HOUSING
 - PARTNERSHIP
 - SPORTS/RECREATION
 - FACILITY SUPPORT
 - OPEN SPACE
 - NEW PARKING
 - VISION PLAN BUILDING
 - ROAD REALIGNMENT
 - CAMPUS AXES

- KEY:**
- A. EXPANDED TRACK AND FIELD
 - B. AMPHITHEATER
 - C. EXPANDED UNIVERSITY HOUSING
 - D. GREEK HOUSING
 - E. HOTEL
 - F. REPURPOSING OF PRIMERA CASA
 - G. GRADUATE HOUSING
 - H. ACADEMIC/RESEARCH AREA
 - I. CENTRAL CHILLER PLANT

MODESTO MAIDIQUE CAMPUS
2020 PROPOSED PLAN

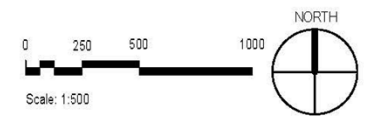

MMC – Support Facilities

LEGEND

- ACADEMIC / ADMINISTRATIVE OFFICES
- GENERAL USE / CAMPUS SUPPORT
- CAMPUS FACILITY SUPPORT
- CLINIC / HEALTHCARE FACILITIES
- 1ST FLOOR MULTI PURPOSE SPACE

MODESTO MAIDIQUE CAMPUS

ELEMENT 6.1
2020 SUPPORT FACILITIES



January 9, 2013

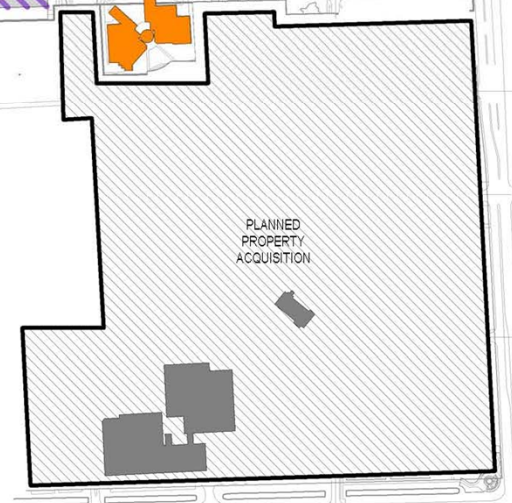

MMC - Housing

LEGEND

-  UNDERGRADUATE HOUSING
-  GRADUATE HOUSING
-  GREEK HOUSING

MODESTO MAIDIQUE CAMPUS

ELEMENT 7.1
2020 HOUSING FACILITIES



January 9, 2013

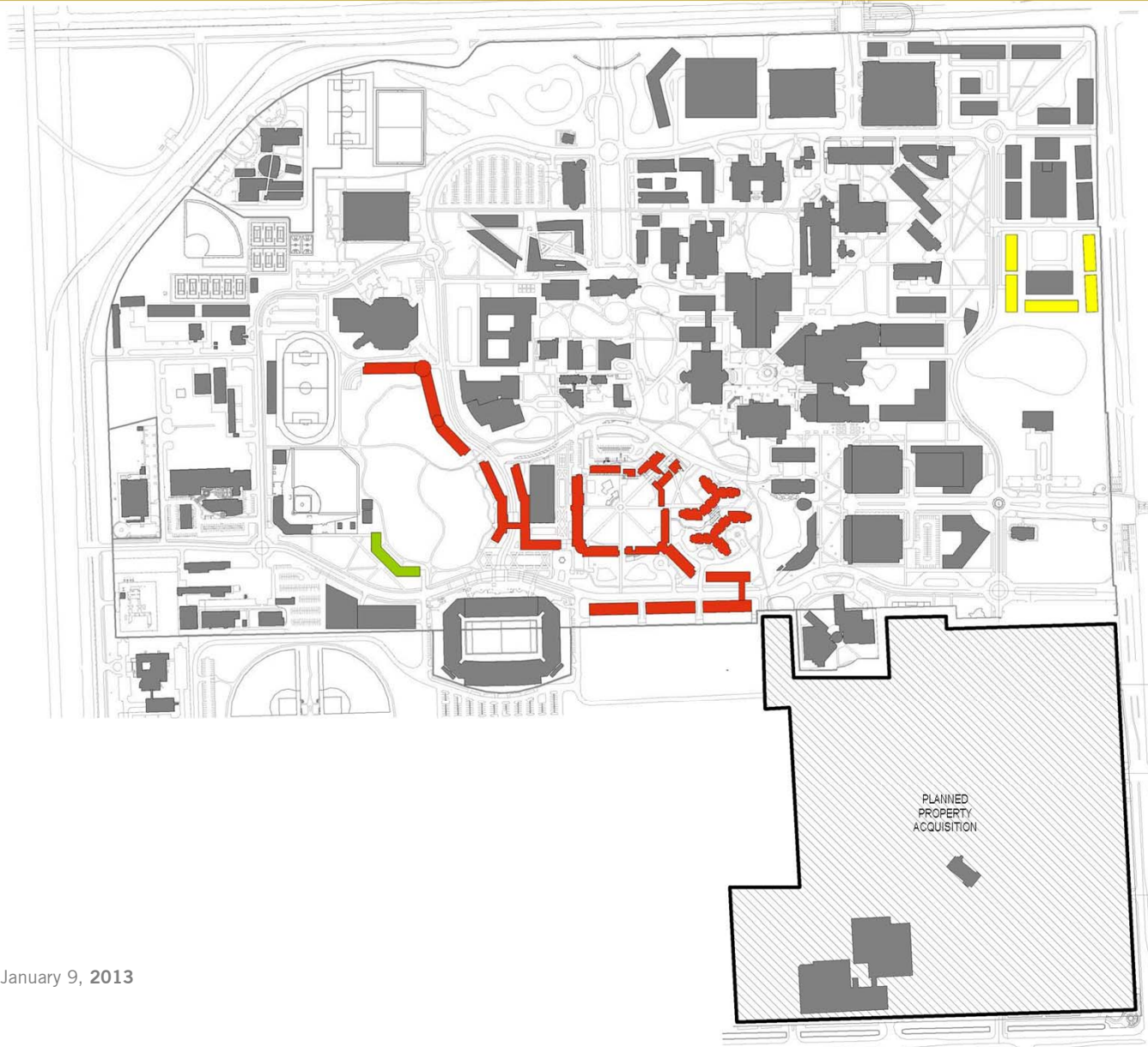

Modesto Maidique Campus

Open Space



LEGEND

- MULTI PURPOSE OPEN SPACE
- ATHLETICS
- SPECIAL PURPOSE LANDSCAPE
- RECREATION
- COURTYARD/PLAZA
- CAMPUS GATEWAY
- SURFACE WATER
- RECREATION PATH

MODESTO MAIDIQUE CAMPUS

ELEMENT 8.1 2020 OPEN SPACE

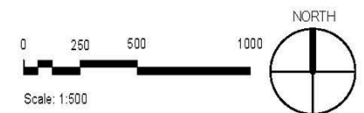

January 9, 2013



EC PLAN REVIEW

Engineering Center

Development Framework

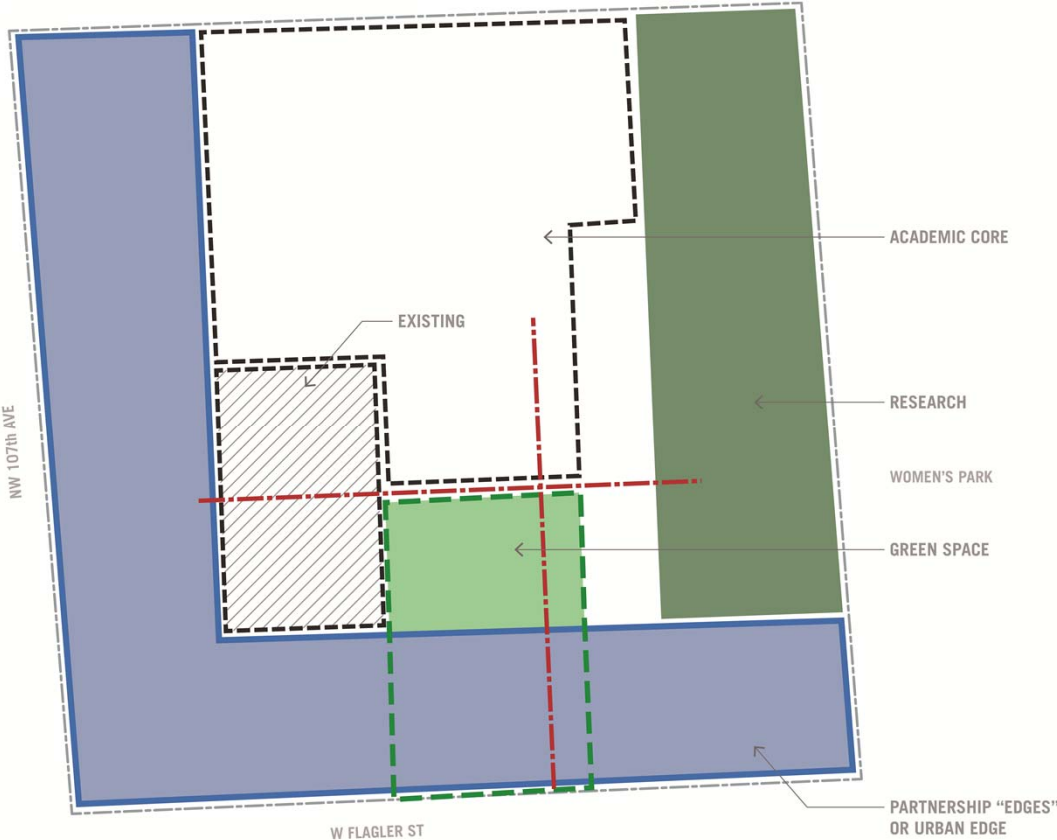

Engineering Center

Urban Design Framework - Vision

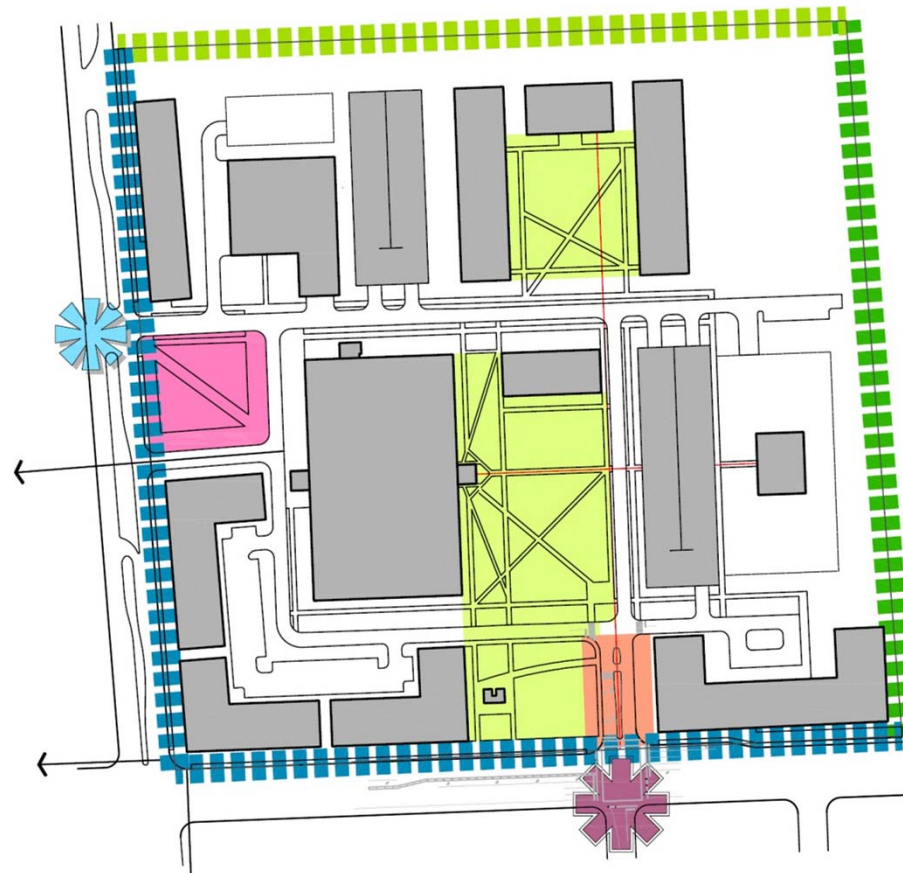

| LEGEND | |
|---------------------|---------------------------------|
| Open Space | |
| | Quads |
| | Special Purpose Landscape |
| | Courtyard/ Plaza |
| | Promenade |
| Connectivity | |
| | Primary Entrance |
| | Secondary Entrance |
| | Tertiary Entrance |
| | Regulating Line- Major Axis |
| | Regulating Line- Secondary Axis |
| | Pedestrian Connectivity |
| Streets | |
| | Roundabout |
| | Campus Gateway |
| | Adjacent Corridor |
| | Campus Greenbelt |
| | Main Street |
| Edges | |
| | Active Major |
| | Active Minor |
| | Passive Major |
| | Passive Minor |

Engineering Center

Vision Plan

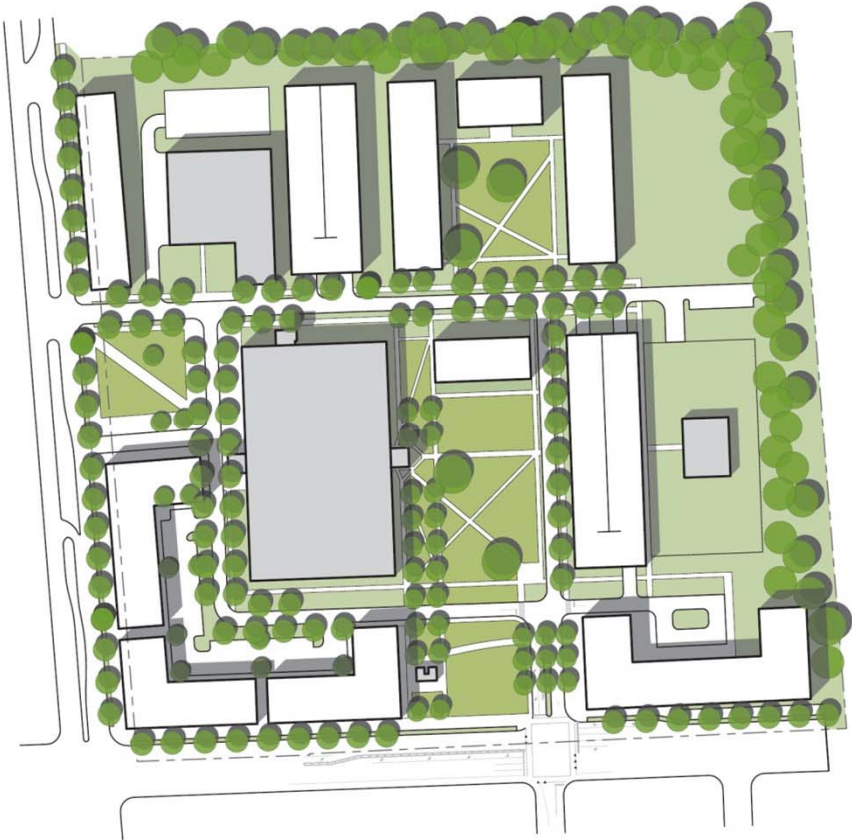

EC – 2035 Facility Use

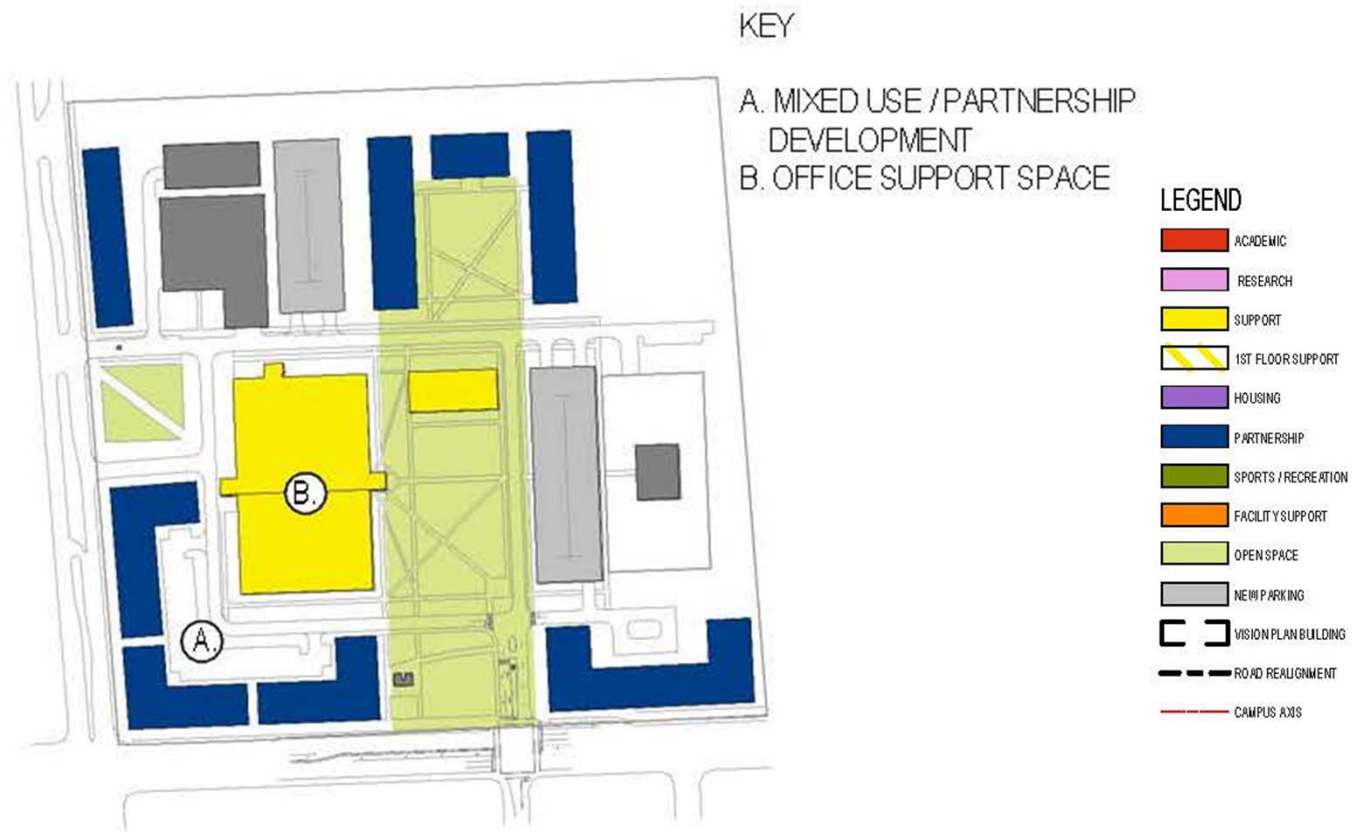

Engineering Center

Facility Use

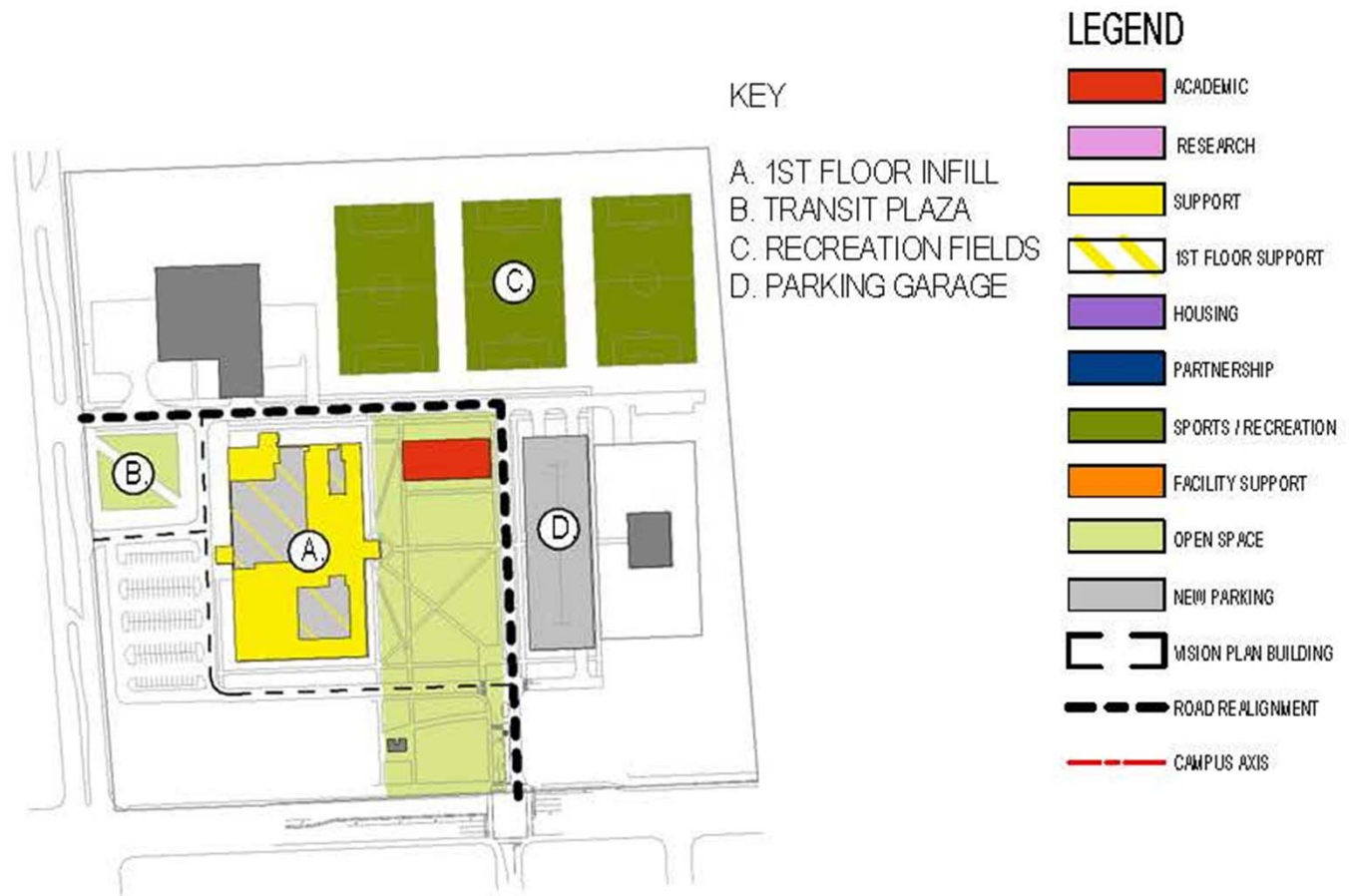

EC – Support Facilities

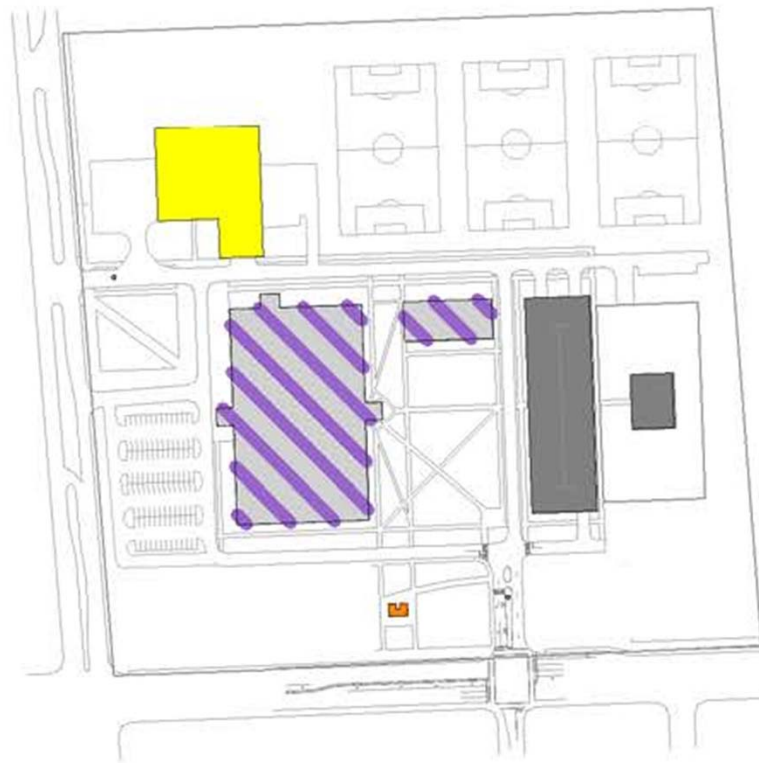

LEGEND

- ACADEMIC / ADMINISTRATIVE OFFICES
- GENERAL USE / CAMPUS SUPPORT
- CAMPUS FACILITY SUPPORT
- CLINIC / HEALTHCARE FACILITIES
- 1ST FLOOR MULTI PURPOSE SPAC

Engineering Center

Open Space



LEGEND

- MULTI PURPOSE OPEN SPACE
- ATHLETICS
- SPECIAL PURPOSE LANDSCAPE
- RECREATION
- COURTYARD/PLAZA
- CAMPUS GATEWAY
- SURFACE WATER
- RECREATION PATH

BBC PLAN REVIEW

Biscayne Bay Campus

Development Framework

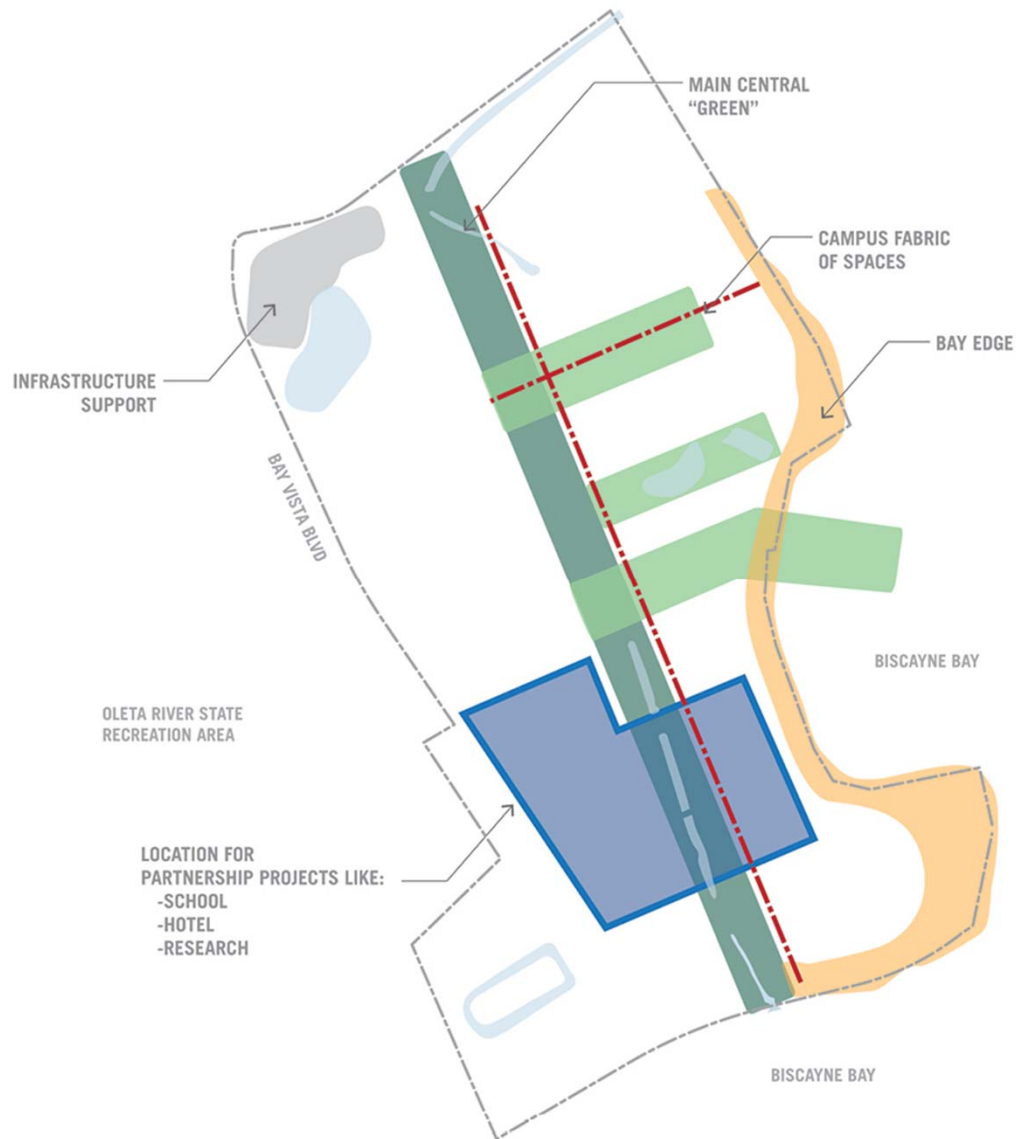

Biscayne Bay Campus

Urban Design Framework - Vision



| LEGEND | |
|--------------|---------------------------------|
| Open Space | |
| | Quads |
| | Special Purpose Landscape |
| | Courtyard/ Plaza |
| | Promenade |
| Connectivity | |
| | Primary Entrance |
| | Secondary Entrance |
| | Tertiary Entrance |
| | Regulating Line- Major Axis |
| | Regulating Line- Secondary Axis |
| | Pedestrian Connectivity |
| Streets | |
| | Roundabout |
| | Campus Gateway |
| | Adjacent Corridor |
| | Campus Greenbelt |
| | Main Street |
| Edges | |
| | Active Major |
| | Active Minor |
| | Passive Major |
| | Passive Minor |

Biscayne Bay Campus

Vision Plan



BBC – 2035 Facility Use

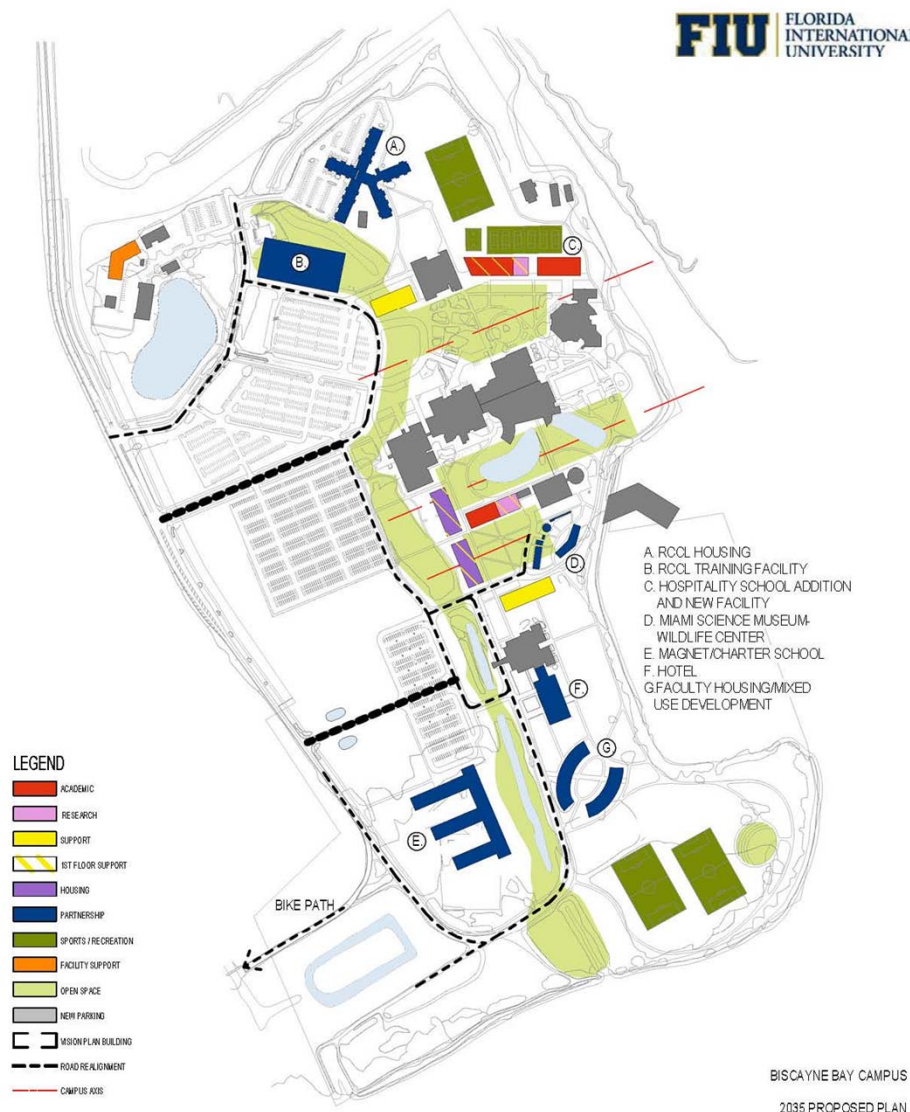

January 9, 2013

PERKINS+WILL

Biscayne Bay Campus

Facility Use



BISCAYNE BAY CAMPUS
2020 PROPOSED PLAN

BBC – Support Facilities

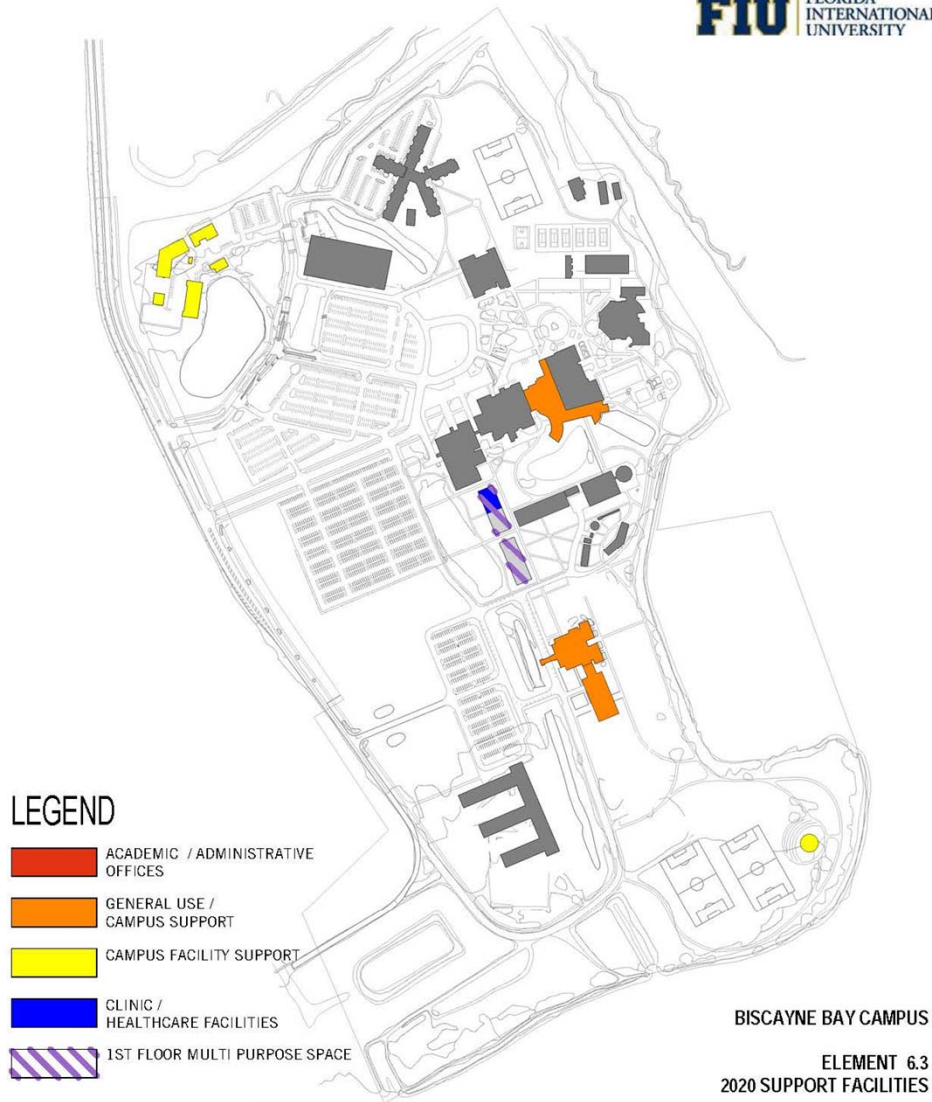

January 9, 2013

PERKINS+WILL

BBC – Housing Facilities



LEGEND

-  UNDERGRADUATE HOUSING
-  GRADUATE HOUSING
-  GREEK HOUSING

BISCAYNE BAY CAMPUS

ELEMENT 7.3
2020 HOUSING FACILITIES

January 9, 2013

PERKINS+WILL

BBC

Open Space

FIU FLORIDA INTERNATIONAL UNIVERSITY



January 9, 2013

PERKINS+WILL



FLORIDA
INTERNATIONAL
UNIVERSITY

DISCUSSION

Focus Group #4 - Key Questions

- Are student housing neighborhoods sufficiently supported by open space, transit, parking and auxiliary services?
- Do student housing locations satisfy programmatic needs / diversity?
- Do student life facility locations support interdisciplinary learning and research?
- Do 1st Floor services and student hubs reinforce FIU's identity?
- Do student life districts sufficiently connect with neighboring communities?
- Does campus zoning create a student-friendly campus?
- Does campus open space sufficiently balance athletics, rec sports, and informal (play) space?

Additional Resources

MMC – 2020 Space Needs



SPACE NEEDS 2020

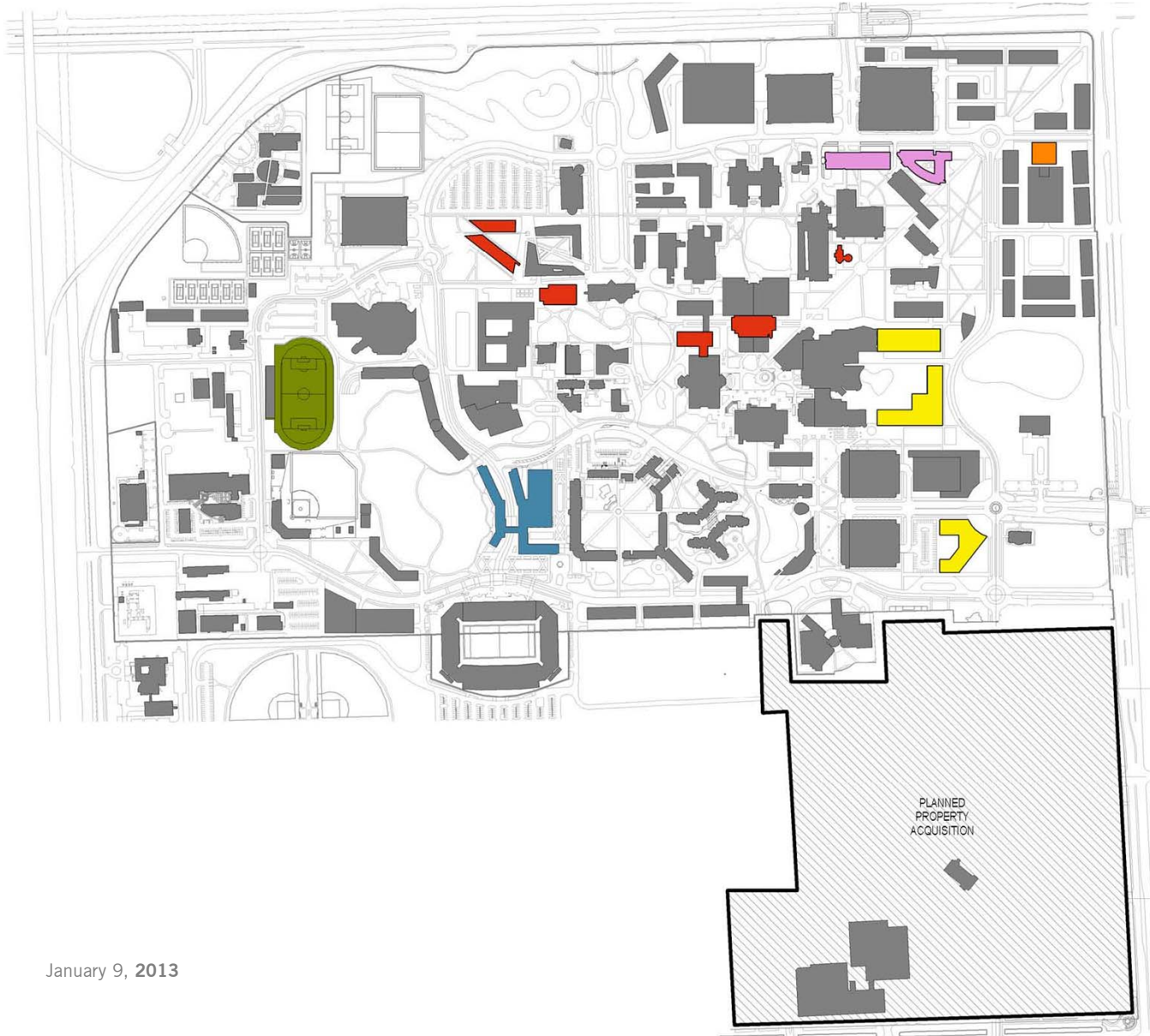
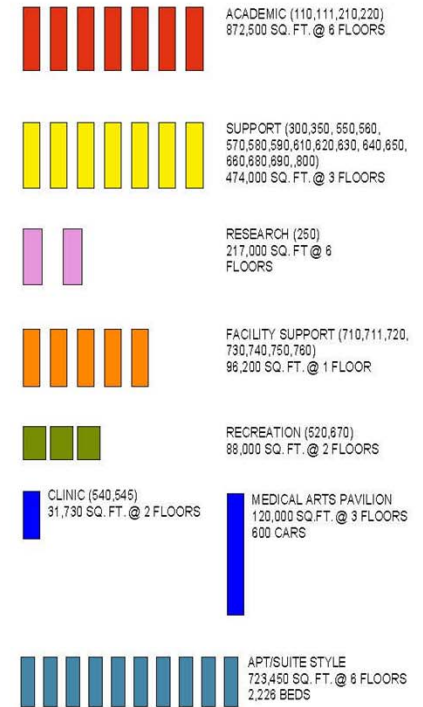

PLANNED PROPERTY ACQUISITION

MODESTO MAIDIQUE CAMPUS

2020 SPACE NEEDS / PLANNED PROJECTS



January 9, 2013

MMC – 2035 Space Needs

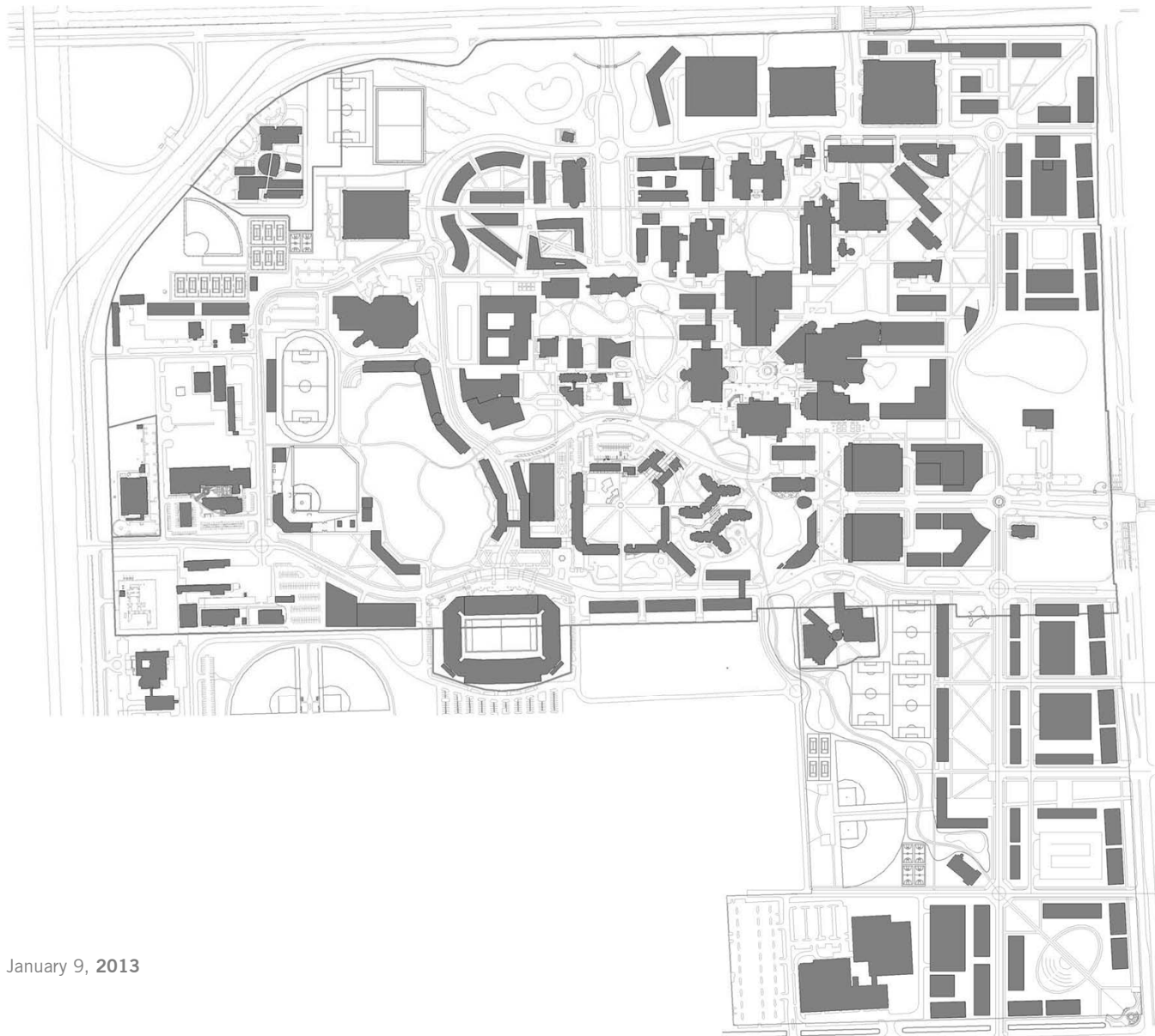

ADDED SPACE NEEDS 2035

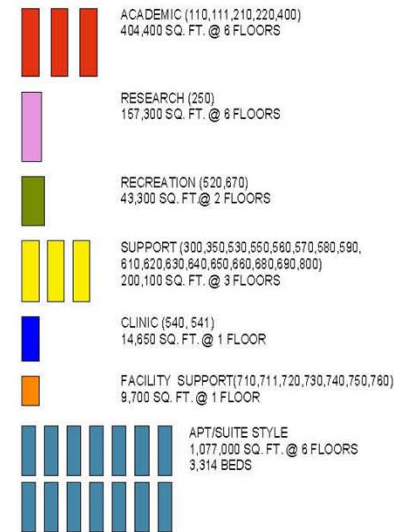

MODESTO MAIDIQUE CAMPUS

2035 SPACE NEEDS



January 9, 2013

MMC+EC - Recreation / Open Space Needs



RECREATION SPACE NEEDS 2020

NIRSA STANDARDS

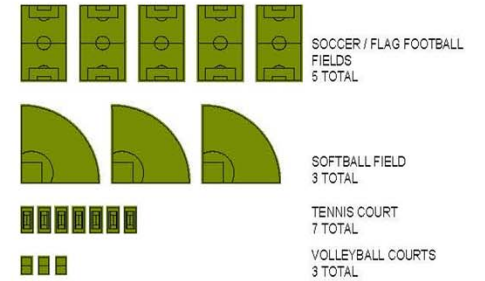

LEVEL OF SERVICE STANDARDS OF HOST COMMUNITY

OPEN SPACE AS SHOWN: 62.18 ACRES
 OPEN SPACE NEEDED: 103.73 ACRES (BASED ON ENROLLMENT HEADCOUNT)
 OPEN SPACE NEEDED: 11.76 ACRES (BASED ON RESIDENT HEADCOUNT)

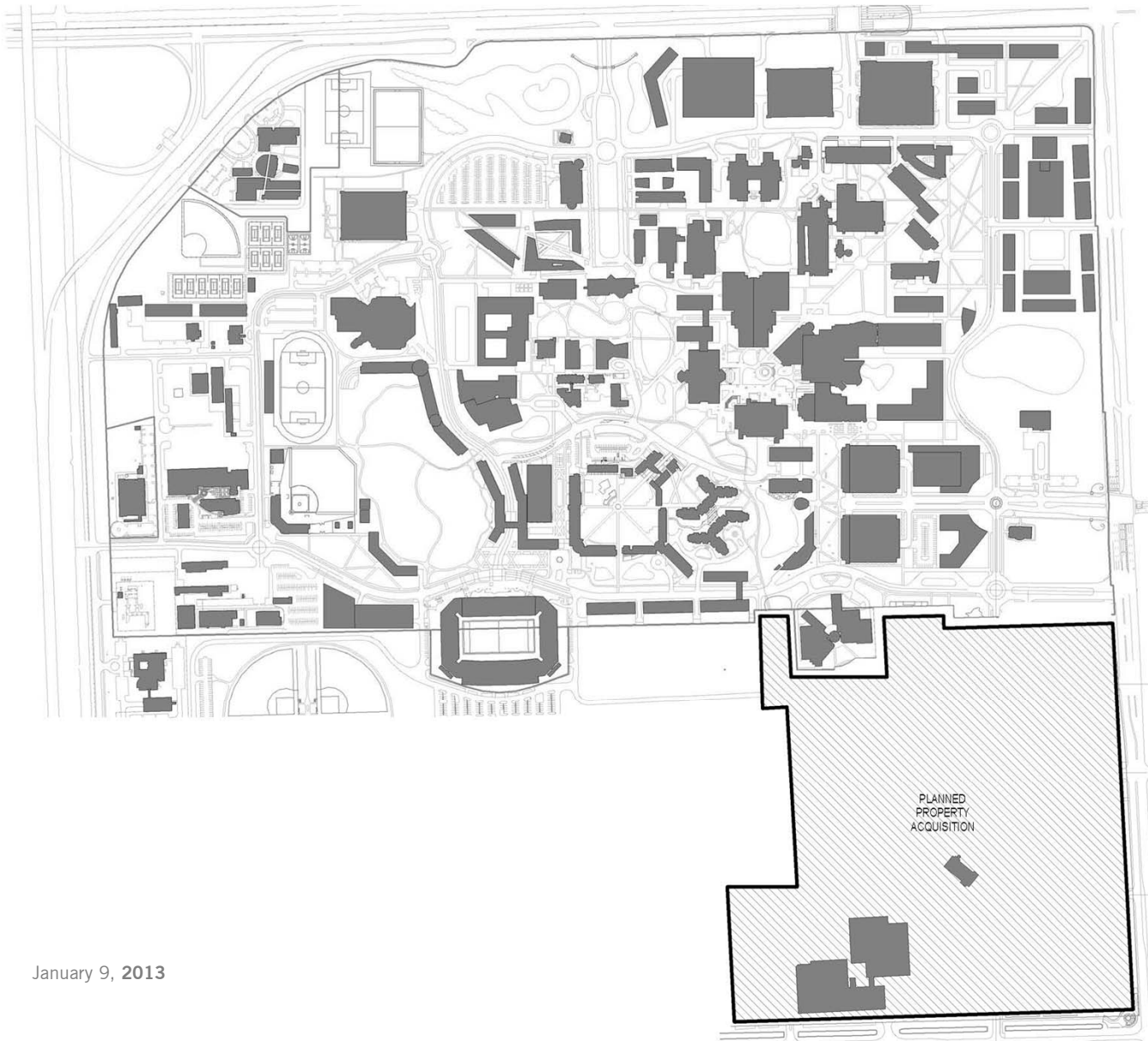

MODESTO MAIDIQUE CAMPUS 2020 RECREATION SPACE NEEDS



EC – 2020+2035 Space Needs

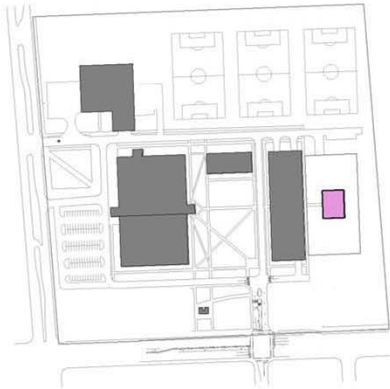

SPACE NEEDS 2020

- ACADEMIC (110,111,210,220)
46,600 SQ. FT. @ 2 FLOORS
- RECREATION (520, 670)
2,900 SQ. FT. @ 1 FLOOR
- FACILITY SUPPORT (710,711,720,730,740,750,760)
7,800 SQ. FT. @ 1 FLOOR

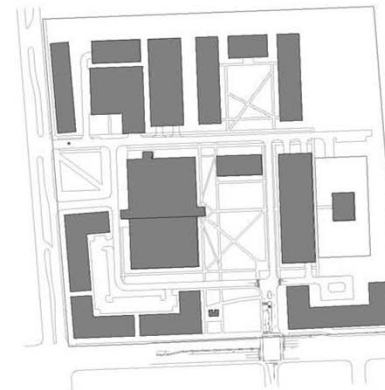

ADDED SPACE NEEDS 2035

- ACADEMIC (110,111,210,220,400)
37,700 SQ. FT. @ 2 FLOORS
- RECREATION (520,670)
1,000 SQ. FT. @ 1 FLOOR
- SUPPORT (300,350,530,550,560,570,580,590,610,620,630,640,650,660,680,690,800)
18,600 SQ. FT. @ 1 FLOORS
- FACILITY SUPPORT (710,711,720,730,740,750,760)
4,300 SQ. FT. @ 1 FLOOR

BBC – 2020+2035 Space Needs

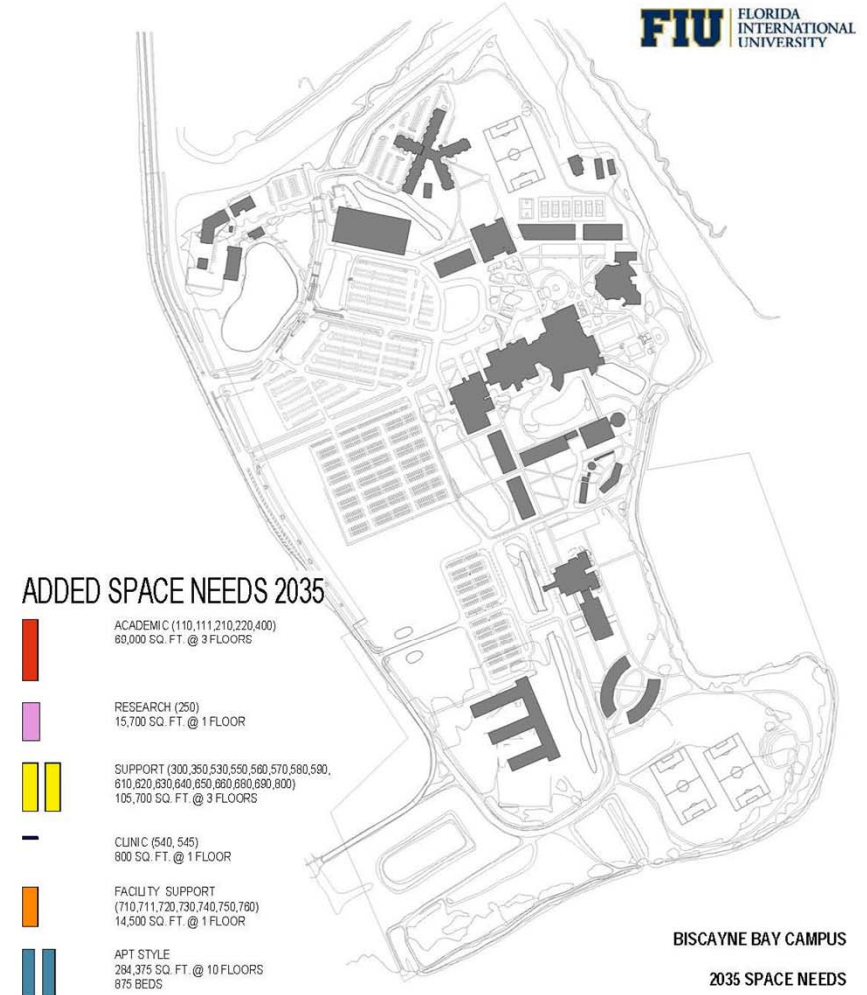
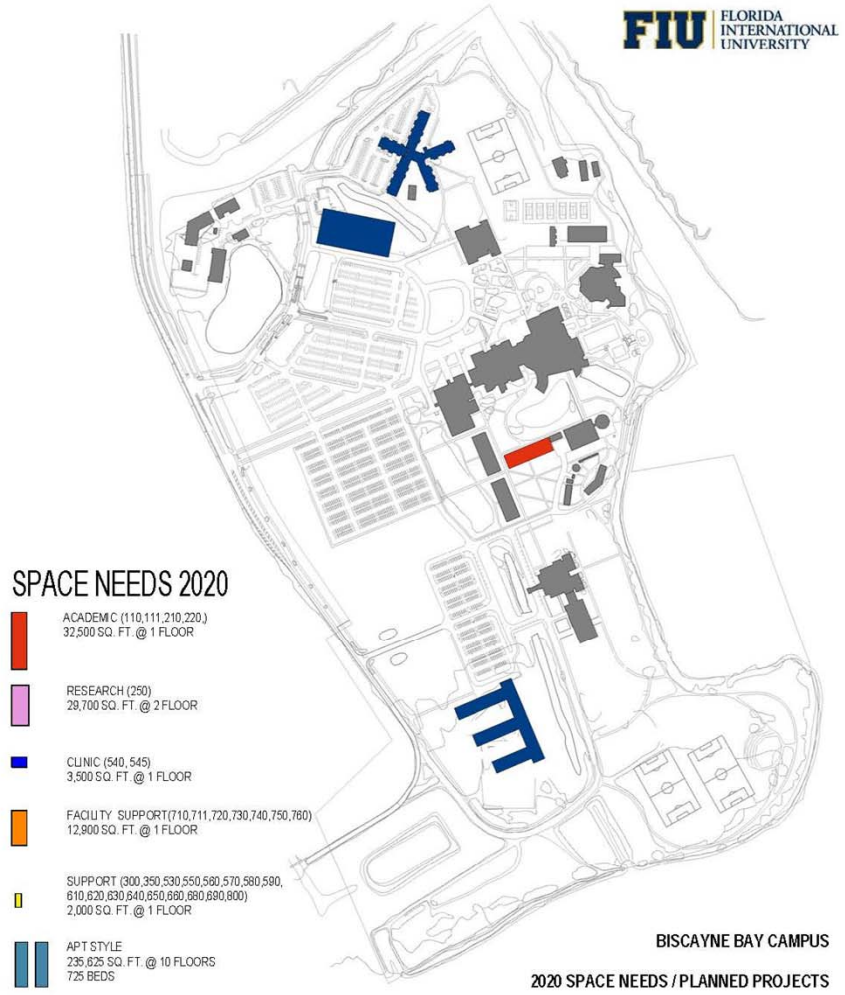

January 9, 2013

PERKINS+WILL

BBC – Recreation / Open Space Needs

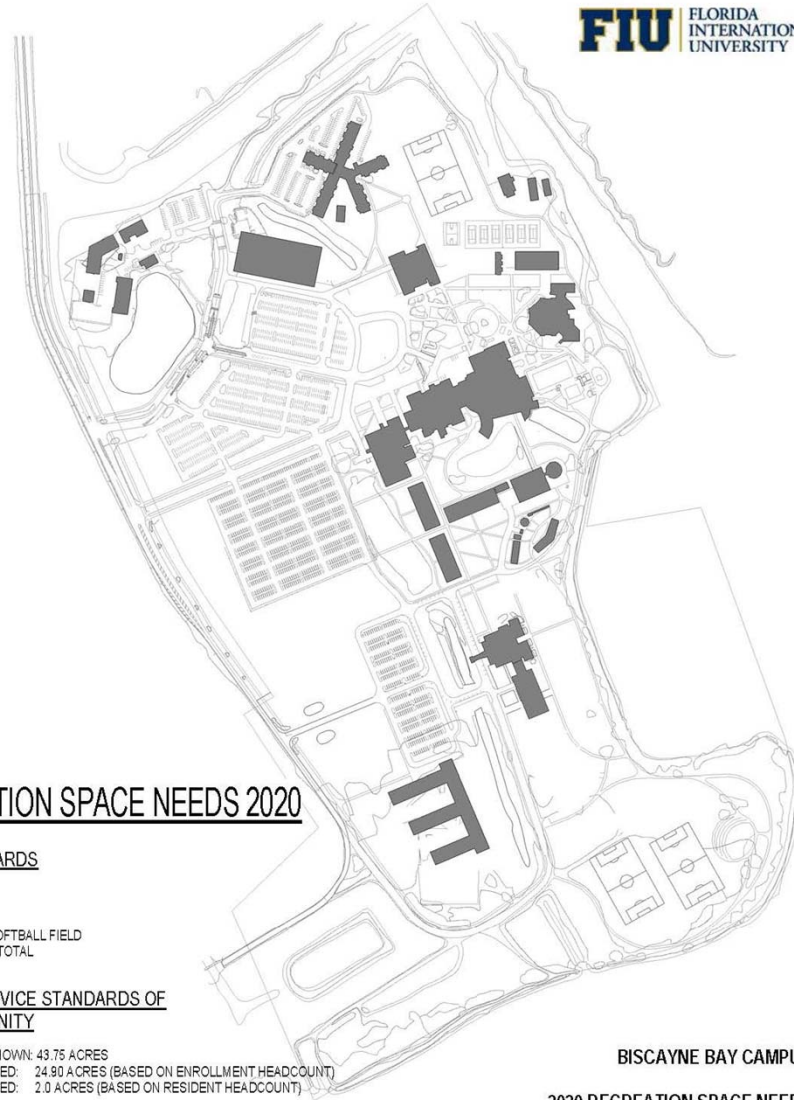

RECREATION SPACE NEEDS 2020

NIRSA STANDARDS



SOFTBALL FIELD
1 TOTAL

LEVEL OF SERVICE STANDARDS OF HOST COMMUNITY

OPEN SPACE AS SHOWN: 43.75 ACRES
OPEN SPACE NEEDED: 24.90 ACRES (BASED ON ENROLLMENT HEADCOUNT)
OPEN SPACE NEEDED: 2.0 ACRES (BASED ON RESIDENT HEADCOUNT)

BISCAYNE BAY CAMPUS

2020 RECREATION SPACE NEEDS

January 9, 2013

PERKINS+WILL