

CAMPUS MASTER PLAN UPDATE 2010-2020

FIU | FLORIDA
INTERNATIONAL
UNIVERSITY

Steering Committee Meeting #4



3 December 2012



January 8, 2013

PERKINS+WILL

1

Campus Master Plan 2010-2020

Meeting #4 Agenda

- 1. Review Schedule / December Minutes**
- 2. Review Campus Vision Plan**
- 3. Review Preliminary 2020 Concept Plan Elements**
 - a. Facility Use**
 - b. Land Use**
 - c. Open Space**
 - d. Circulation/Parking**

Master Planning Schedule

Inventory & Analysis	July-Oct 2012
Preliminary Alternative Concepts	Nov-Dec 2012
Concept Plan Development	Jan 2013
Draft Comprehensive Master Plan	Feb-July 2013
Steering Committee Mtg 5 (Review Draft CMP)	April 2, 2013
Final Comprehensive Master Plan	Aug-Dec 2013
BOT Approval of Master Plan	Dec 2013

Key Characteristics: Create a Strong Core

- **Expand programs to strengthen current successful campus districts and interdisciplinary practices**
- **Infill buildings and additions discretely to “densify” campus core for collegiality, walkability and livability**
- **Preserve open space for inspiration, education and recreation**

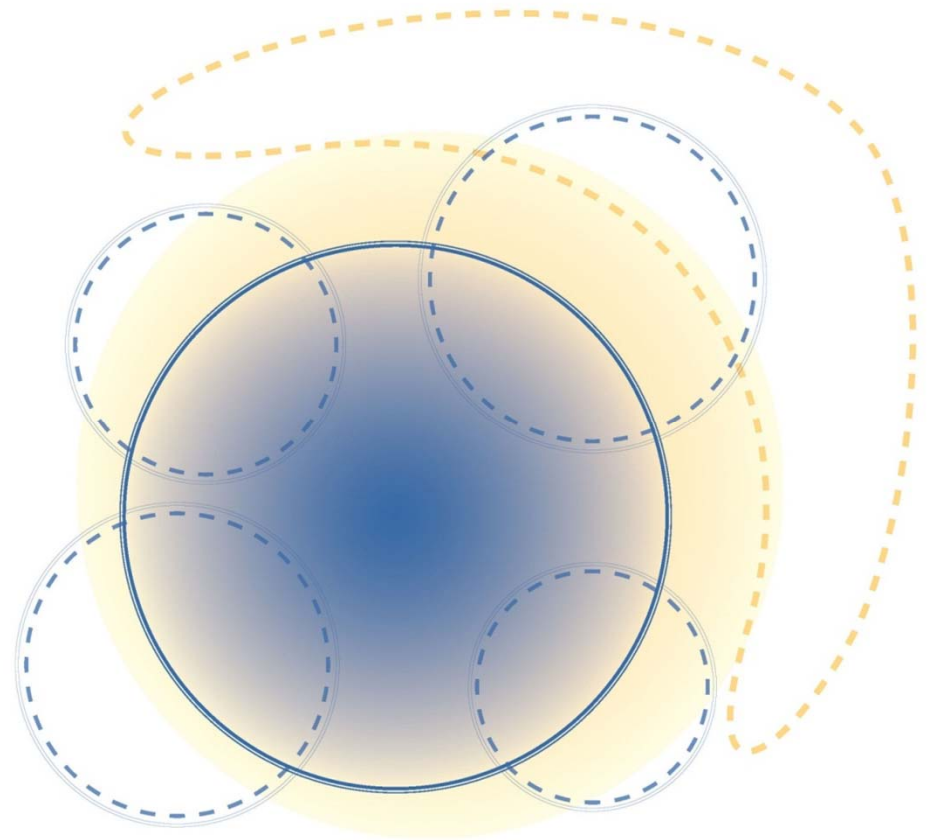

Key Characteristics: Reinforce Identity

- **Position Academic Health programs for high access and outreach**
- **Position Engineering, Math and Computing programs to successfully relocate to MMC over time**
- **Position Journalism, Hospitality, Education and Environmental Science programs to strengthen BBC identity**

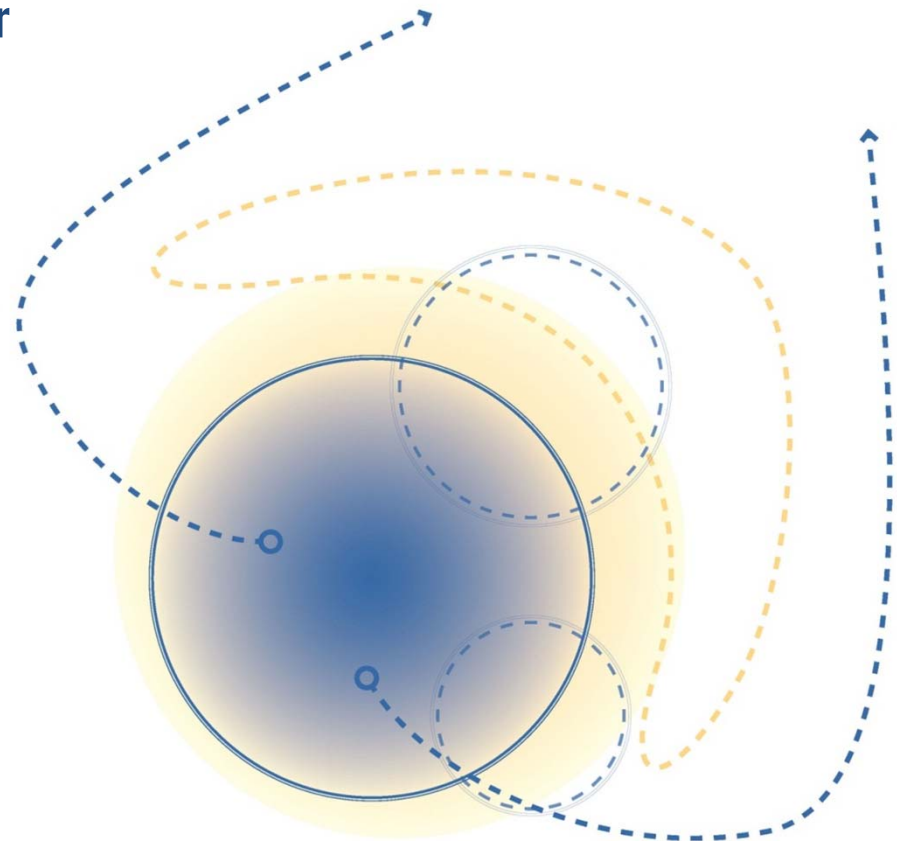

Key Characteristics: Reinforce Partnerships

- **Focus externally funded growth at the campus perimeter**
- **Reserve MMC partnership sites to meet requirements for high access, high visibility, and flexible opportunities**
- **Reposition EC / partnership sites for highest and best use**
- **Land bank sites at BBC in light of limited access**

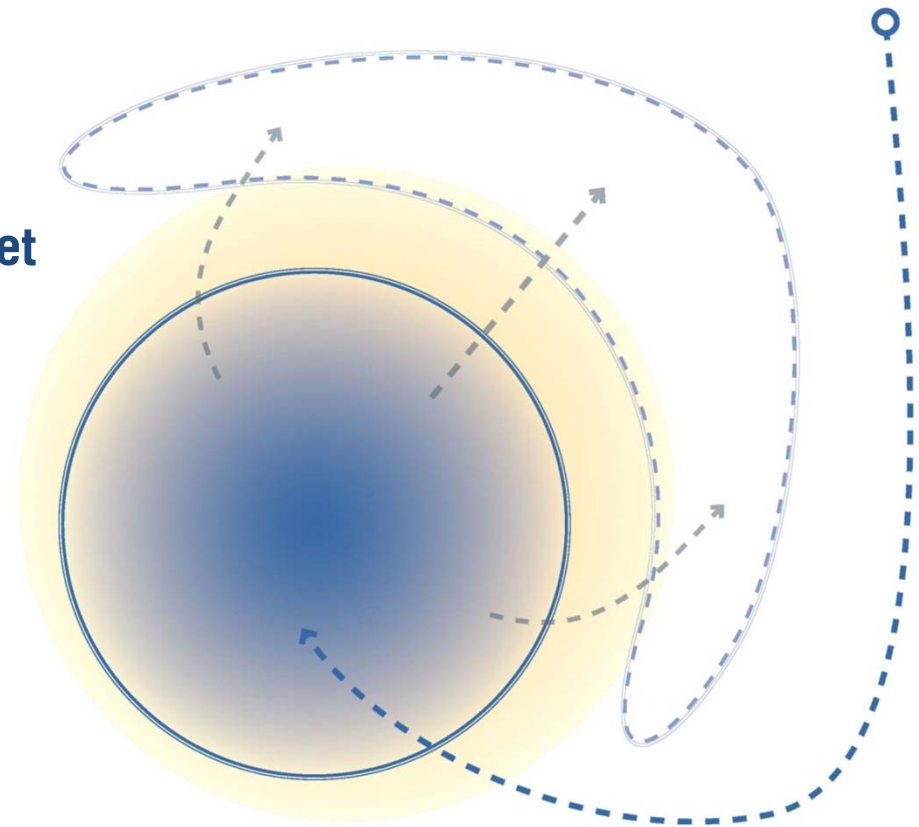

Overall 2020 New Space Needs

FIU NEEDS BEYOND CAPITAL PROJECTS

ACADEMIC:	951,600 SF
SUPPORT:	476,000 SF
RESEARCH:	246,900 SF
FACILITY SUPPORT:	116,900 SF
RECREATION:	90,900 SF
CLINIC:	35,200 SF
TOTAL:	1,917,500 SF

HOUSING: 1,002,950 SF /3086 BEDS (includes replacement)

RECREATION FIELDS/ COURTS:

NIRSA STANDARDS:

SOCCER/ FOOTBALL FIELDS

5 This assumes continued use of Mourning High

SOFTBALL FIELDS

4 This assumes fields at Tamiami Park are still used

TENNIS COURTS

3

VOLLEYBALL COURTS

3

COUNTY STANDARDS:

13.75 ACRES TOTAL REQUIRED

Additional 2035 Space Needs

FIU NEEDS BEYOND 2020

ACADEMIC:	511,000SF
SUPPORT:	324,400 SF
RESEARCH:	173,000 SF
FACILITY SUPPORT:	28,500 SF
RECREATION:	44,300 SF
STUDENT CLINIC:	15,450 SF
TOTAL:	1,096,650 SF
HOUSING:	1,509,000 SF (4043 BEDS)

RECREATION FIELDS/ COURTS:

NIRSA STANDARDS:

SOCCER/ FOOTBALL FIELDS	3 This assumes continued use of Mourning High
SOFTBALL FIELDS	2 This assumes fields at Tamiami Park are still used
TENNIS COURTS	6
VOLLEYBALL COURTS	2
BASKETBALL COURTS	2

COUNTY STANDARDS:

20.62 ACRES TOTAL REQUIRED

MMC PLAN REVIEW

Modesto Maidique Campus Development Framework

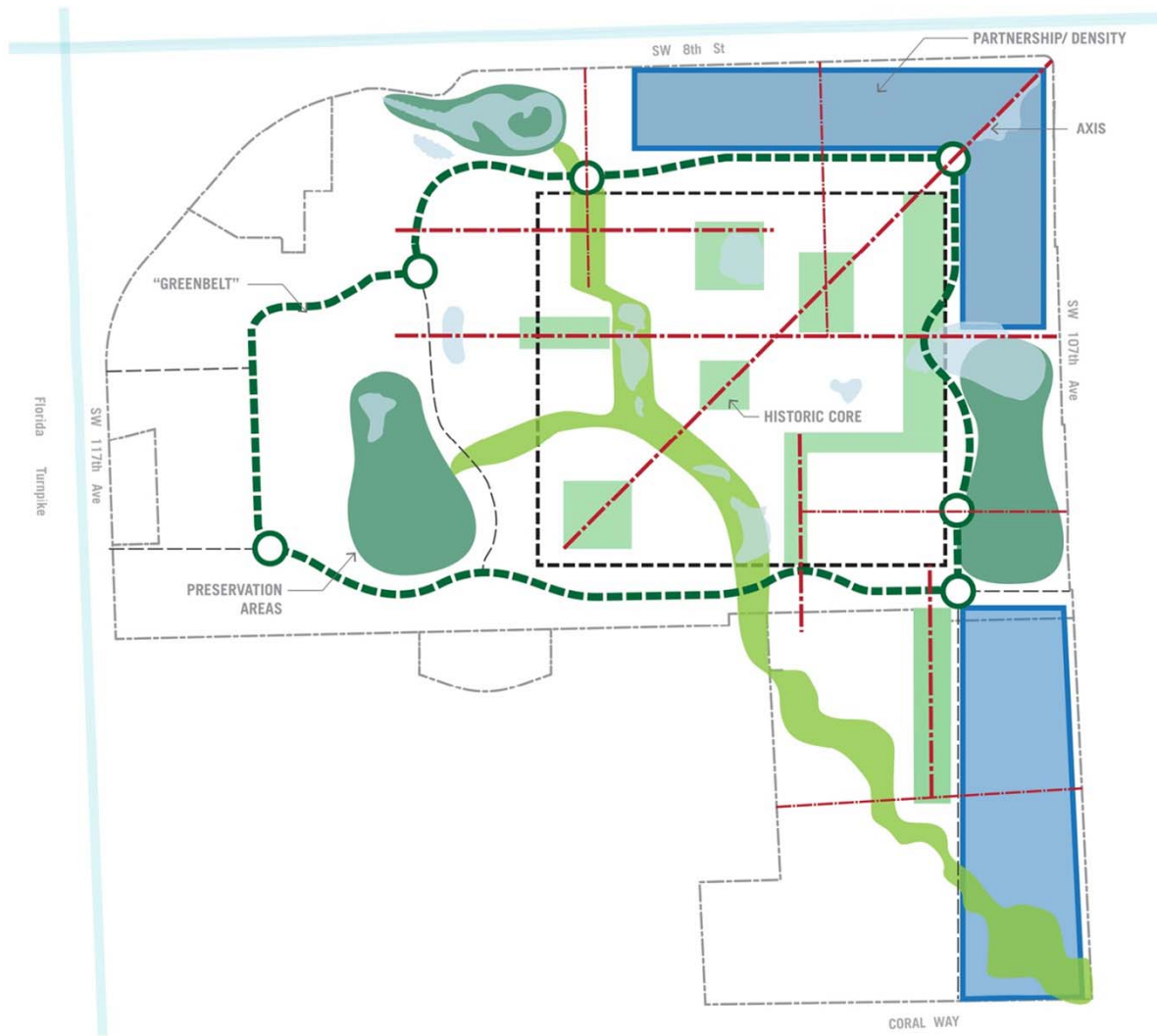

Modesto Maidique Campus

Urban Design Framework - Vision

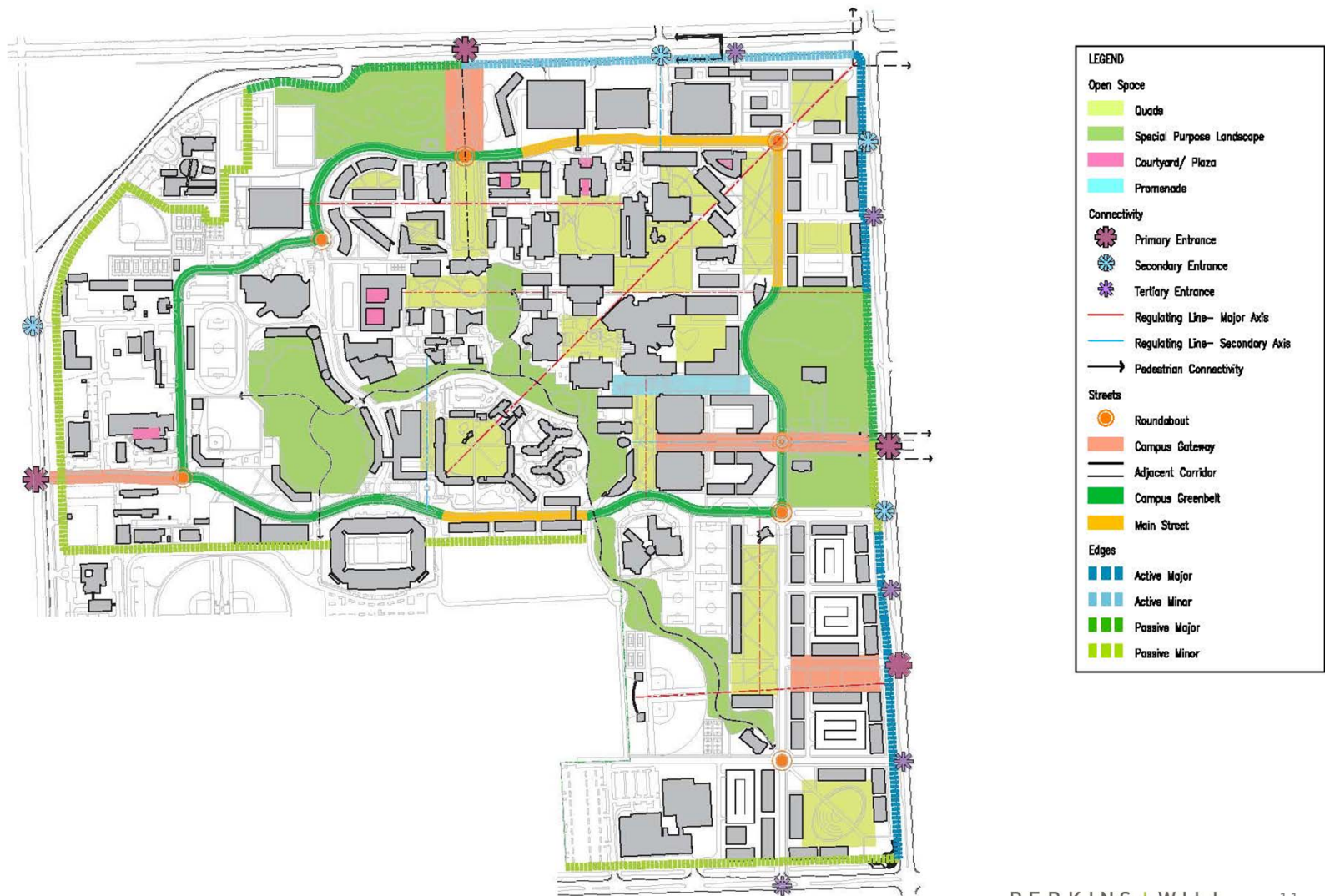

Modesto Maidique Campus

Vision Plan

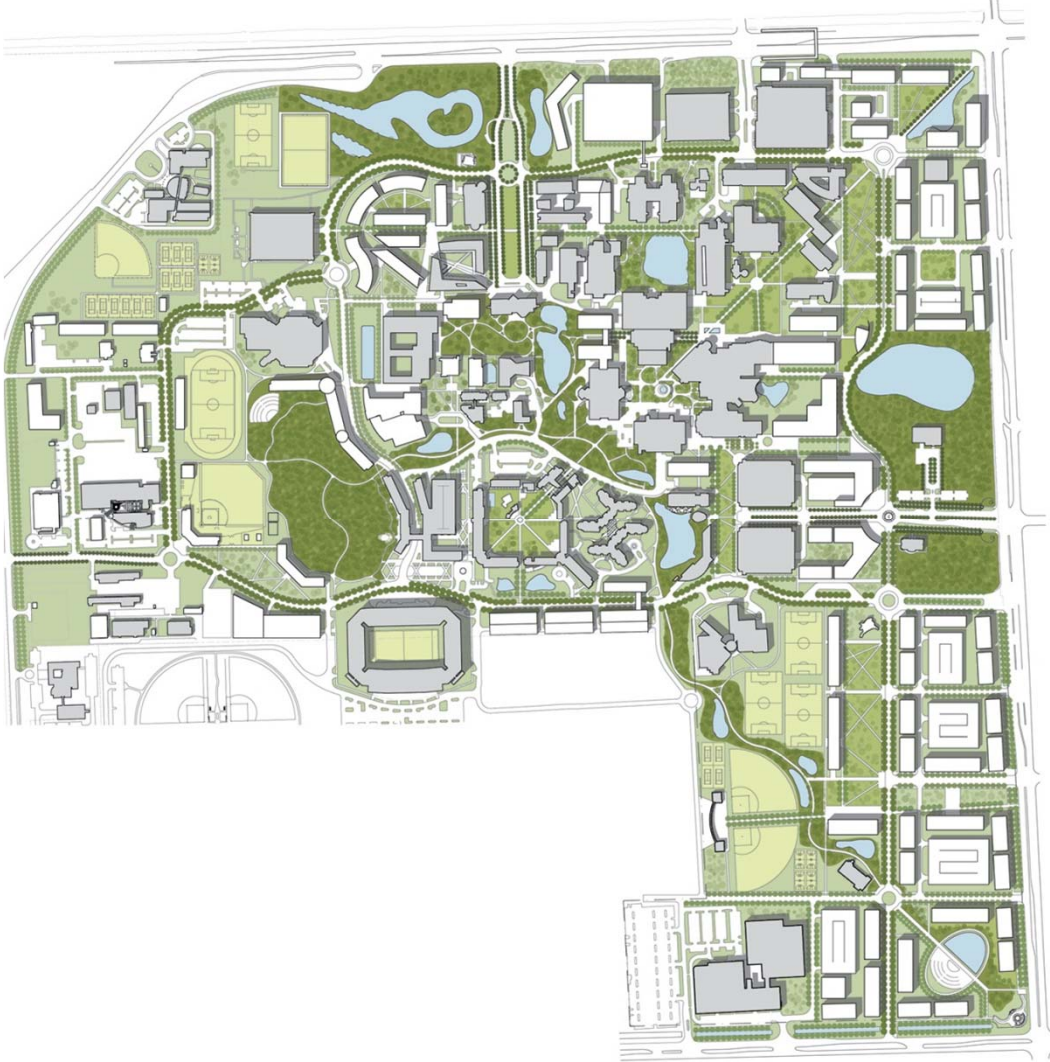

MMC – 2035 Facility Use

LEGEND

- ACADEMIC
- RESEARCH
- SUPPORT
- 1ST FLOOR SUPPORT
- HOUSING
- PARTNERSHIP
- SPORTS / RECREATION
- FACILITY SUPPORT
- OPEN SPACE
- NEPP PARKING
- VISION PLAN BUILDING
- ROAD REALIGNMENT
- CAMPUS AXES

KEY:

- A. EXPANDED TRACK AND FIELD
- B. AMPHITHEATER
- C. EXPANDED UNIVERSITY HOUSING
- D. GREEK HOUSING
- E. HOTEL
- F. GRADUATE HOUSING
- G. ACADEMIC/RESEARCH AREA
- H. EXPANDED RECREATION FIELDS
- I. EXPANDED UNIVERSITY HOUSING
- J. MIXED USE DISTRICT
- K. AMPHITHEATER
- L. FACILITY SUPPORT AREA

MODESTO MAIDIQUE CAMPUS

2035 PROPOSED PLAN

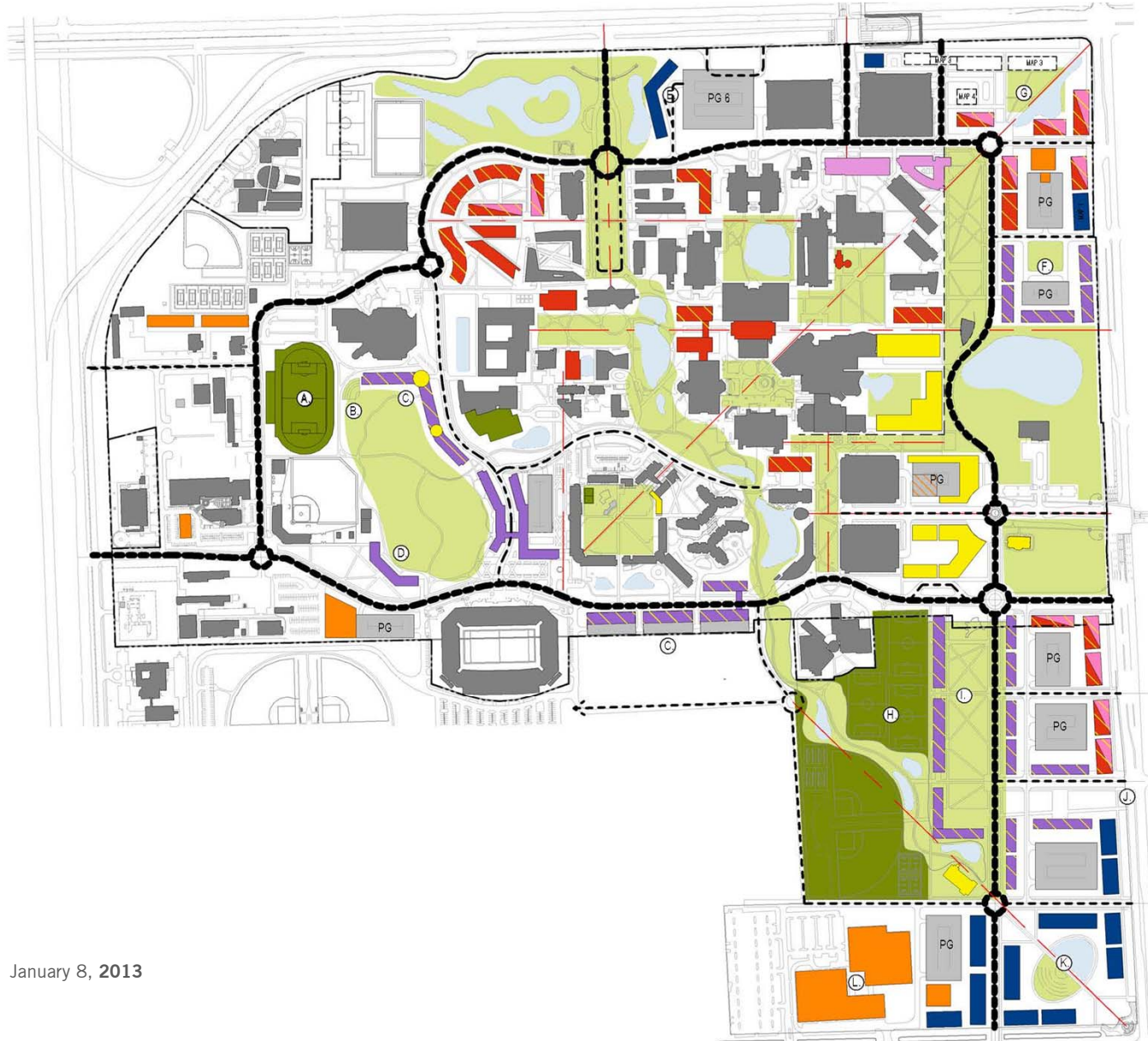
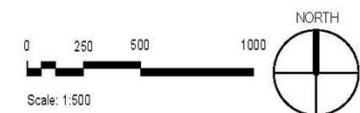

Modesto Maidique Campus

Facility Use

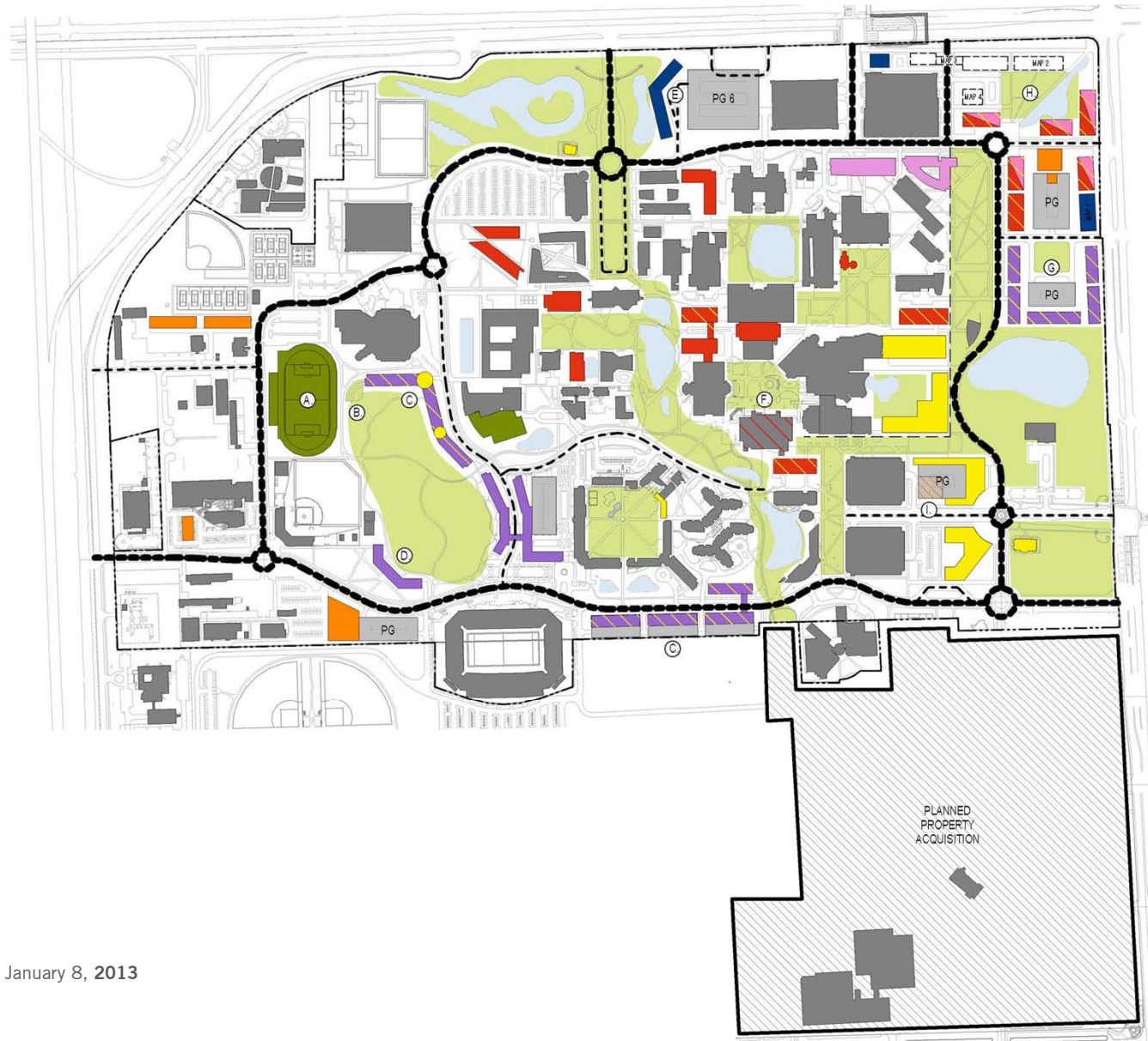

- LEGEND**
- ACADEMIC
 - RESEARCH
 - SUPPORT
 - 1ST FLOOR SUPPORT
 - HOUSING
 - PARTNERSHIP
 - SPORTS/RECREATION
 - FACILITY SUPPORT
 - OPEN SPACE
 - NEW PARKING
 - VISION PLAN BUILDING
 - ROAD REALIGNMENT
 - CAMPUS AXES

- KEY:**
- A. EXPANDED TRACK AND FIELD
 - B. AMPHITHEATER
 - C. EXPANDED UNIVERSITY HOUSING
 - D. GREEK HOUSING
 - E. HOTEL
 - F. REPURPOSING OF PRIMERA CASA
 - G. GRADUATE HOUSING
 - H. ACADEMIC/RESEARCH AREA
 - I. CENTRAL CHILLER PLANT

MODESTO MAIDIQUE CAMPUS
2020 PROPOSED PLAN

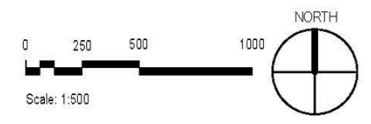

January 8, 2013

Modesto Maidique Campus

Land Use



LEGEND

- ACADEMIC + RESEARCH FACILITIES
- SUPPORT FACILITIES
- HOUSING
- ATHLETICS / RECREATION / OPEN SPACE
- COMMUNITY INTERFACE
- MIXED USE
- PARKING

MODESTO MAIDIQUE CAMPUS

ELEMENT 4.1
2020 LAND USE



January 8, 2013

PLANNED
PROPERTY
ACQUISITION

Modesto Maidique Campus

Open Space



LEGEND

- MULTI PURPOSE OPEN SPACE
- ATHLETICS
- SPECIAL PURPOSE LANDSCAPE
- RECREATION
- COURTYARD/PLAZA
- CAMPUS GATEWAY
- SURFACE WATER
- RECREATION PATH

MODESTO MAIDIQUE CAMPUS

ELEMENT 8.1 2020 OPEN SPACE



January 8, 2013



EC PLAN REVIEW

Engineering Center

Development Framework

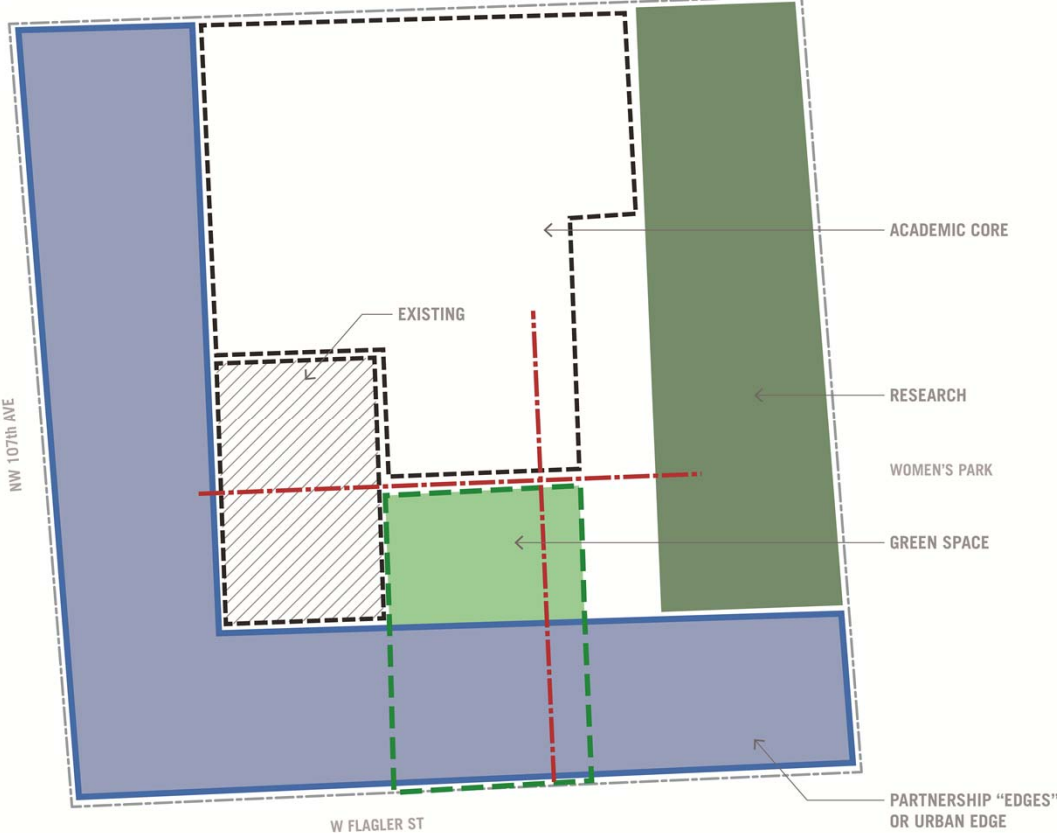

Engineering Center

Urban Design Framework - Vision

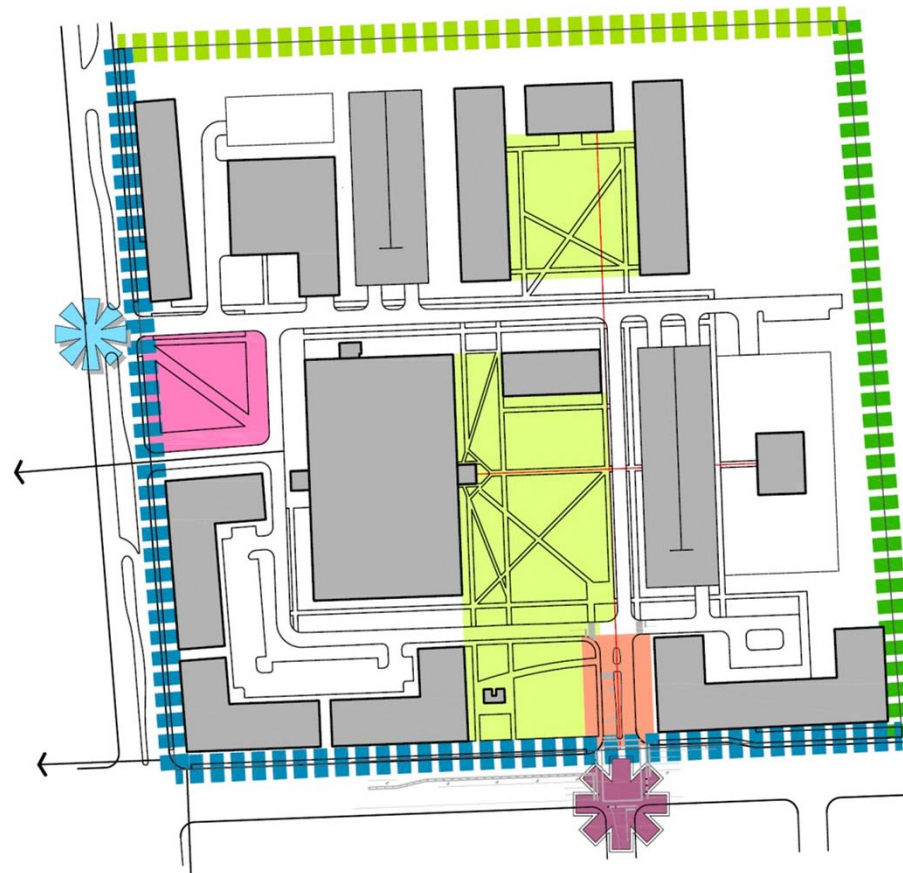

LEGEND	
Open Space	
	Quads
	Special Purpose Landscape
	Courtyard/ Plaza
	Promenade
Connectivity	
	Primary Entrance
	Secondary Entrance
	Tertiary Entrance
	Regulating Line- Major Axis
	Regulating Line- Secondary Axis
	Pedestrian Connectivity
Streets	
	Roundabout
	Campus Gateway
	Adjacent Corridor
	Campus Greenbelt
	Main Street
Edges	
	Active Major
	Active Minor
	Passive Major
	Passive Minor

Engineering Center

Vision Plan

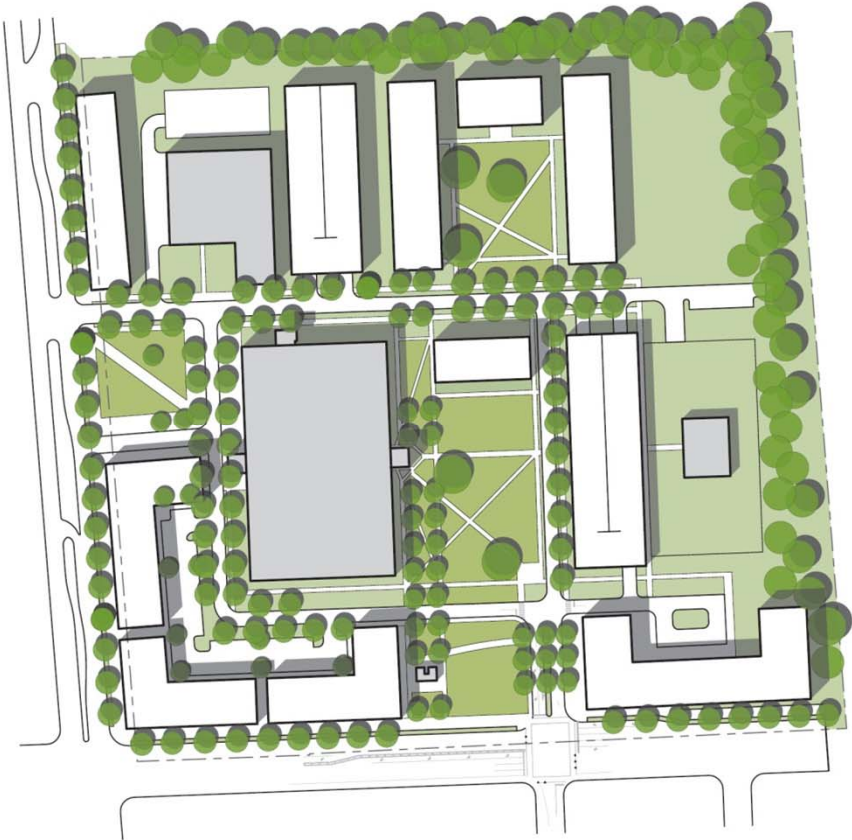

EC – 2035 Facility Use

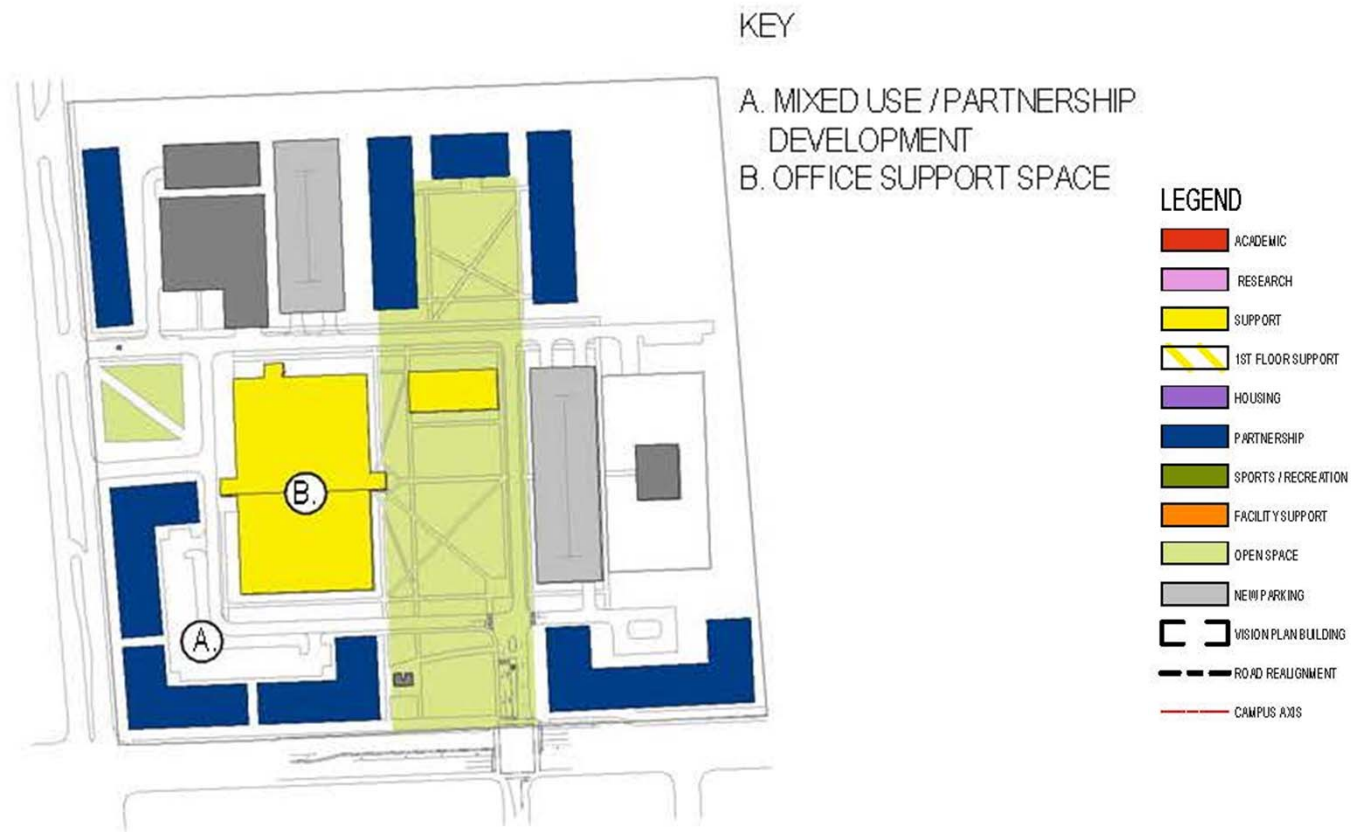

Engineering Center

Facility Use

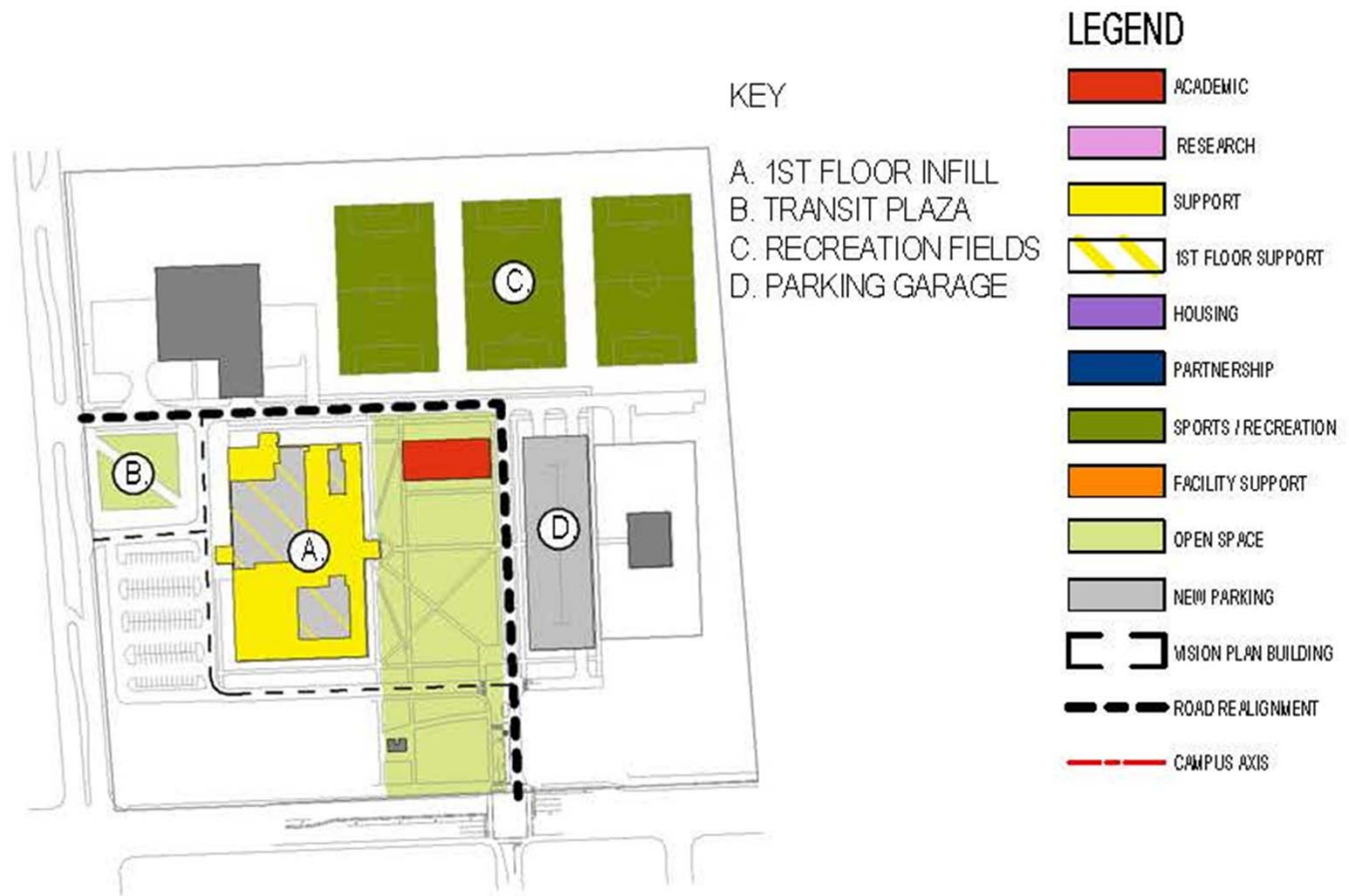

Engineering Center

Land Use

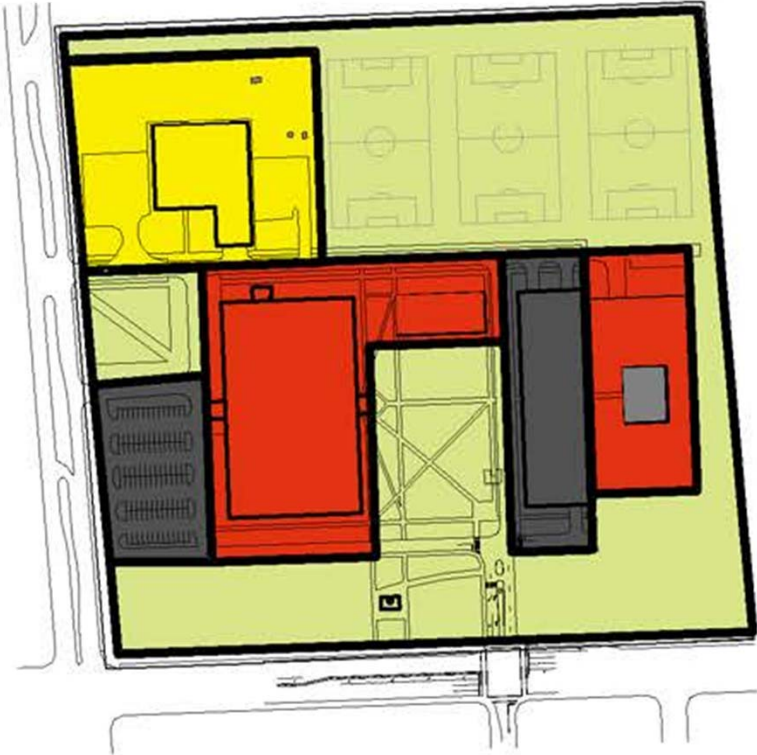

LEGEND

- ACADEMIC + RESEARCH FACILITIES
- SUPPORT FACILITIES
- HOUSING
- ATHLETICS / RECREATION / OPEN SPACE
- COMMUNITY INTERFACE
- MIXED USE
- PARKING

Engineering Center

Open Space



LEGEND

- MULTI PURPOSE OPEN SPACE
- ATHLETICS
- SPECIAL PURPOSE LANDSCAPE
- RECREATION
- COURTYARD/PLAZA
- CAMPUS GATEWAY
- SURFACE WATER
- RECREATION PATH

BBC PLAN REVIEW

Biscayne Bay Campus

Development Framework

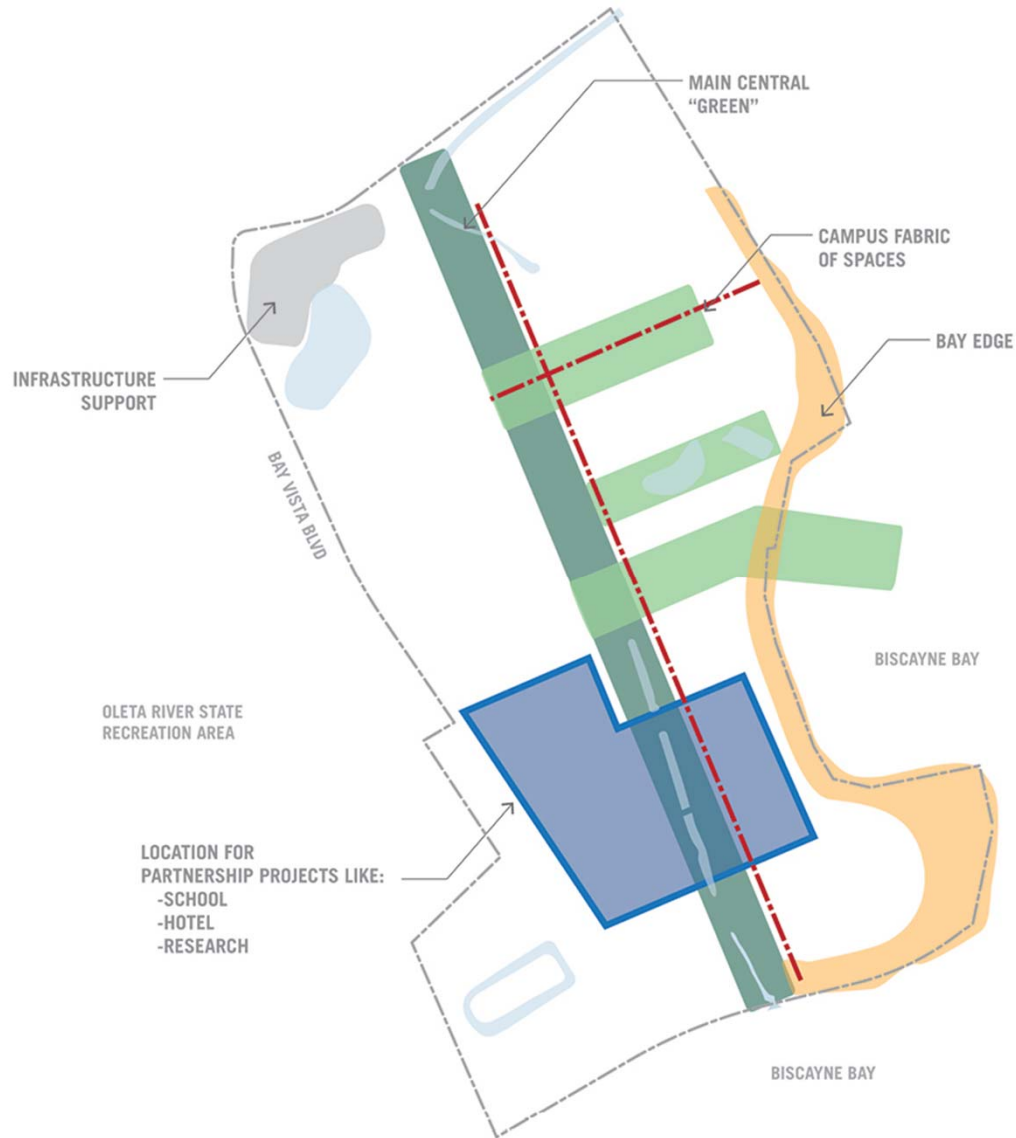

Biscayne Bay Campus

Urban Design Framework - Vision



LEGEND	
Open Space	
	Quads
	Special Purpose Landscape
	Courtyard/ Plaza
	Promenade
Connectivity	
	Primary Entrance
	Secondary Entrance
	Tertiary Entrance
	Regulating Line- Major Axis
	Regulating Line- Secondary Axis
	Pedestrian Connectivity
Streets	
	Roundabout
	Campus Gateway
	Adjacent Corridor
	Campus Greenbelt
	Main Street
Edges	
	Active Major
	Active Minor
	Passive Major
	Passive Minor

Biscayne Bay Campus

Vision Plan



BBC – 2035 Facility Use

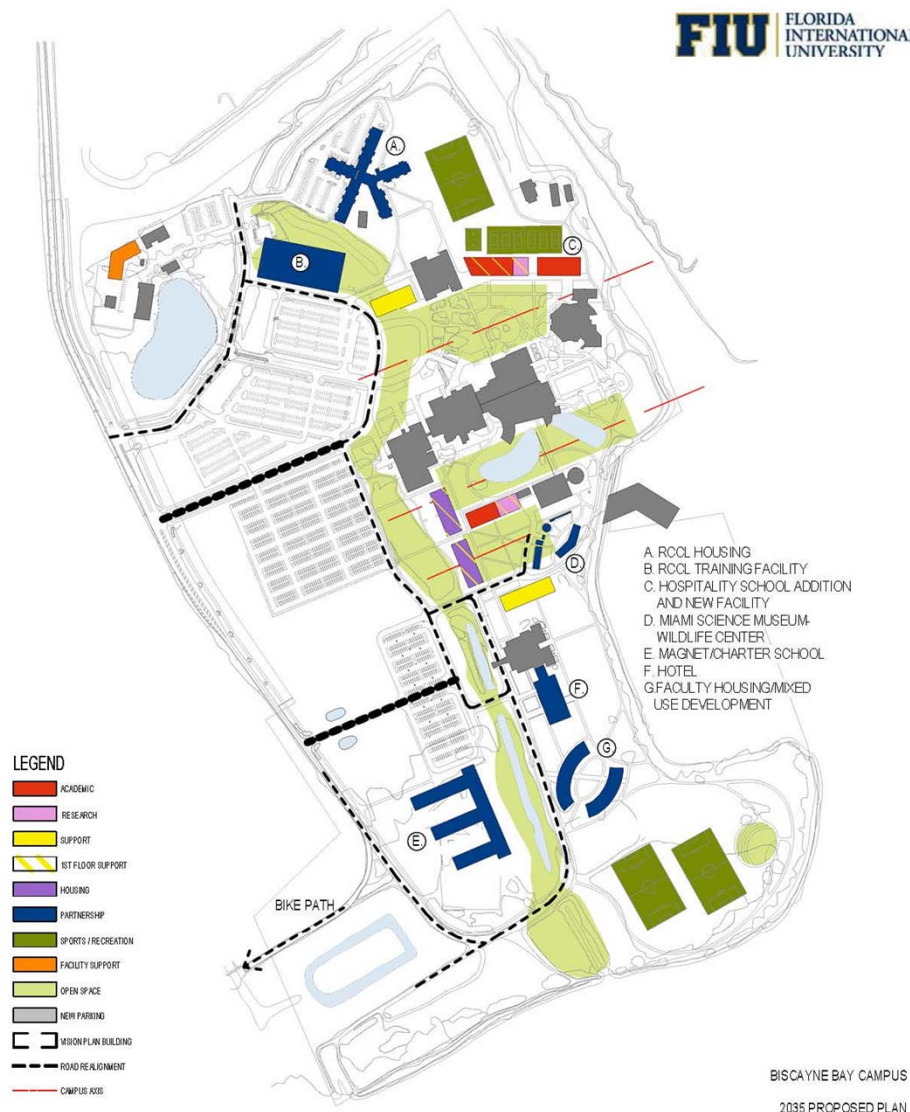

January 8, 2013

PERKINS+WILL

Biscayne Bay Campus

Facility Use



January 8, 2013

Biscayne Bay Campus

Land Use

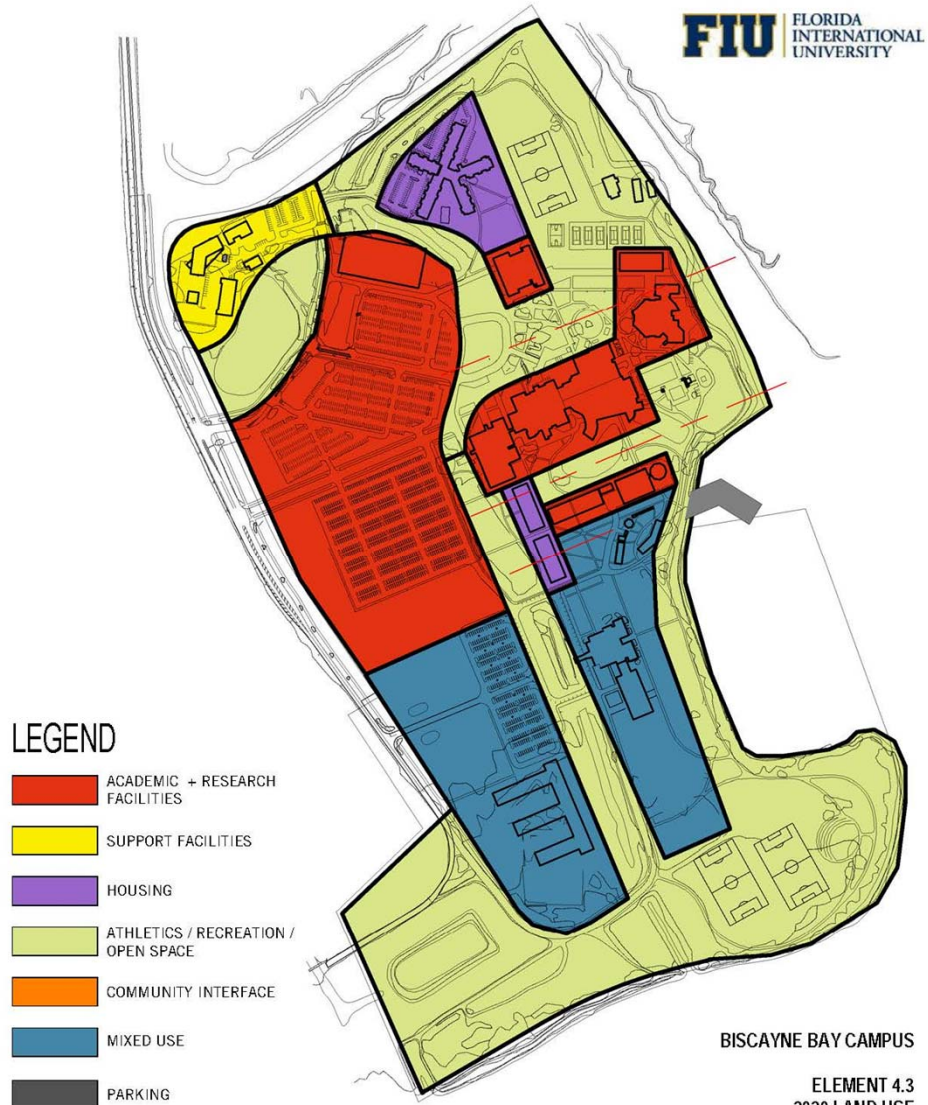

January 8, 2013

PERKINS+WILL

31

BBC

Open Space

FIU FLORIDA INTERNATIONAL UNIVERSITY

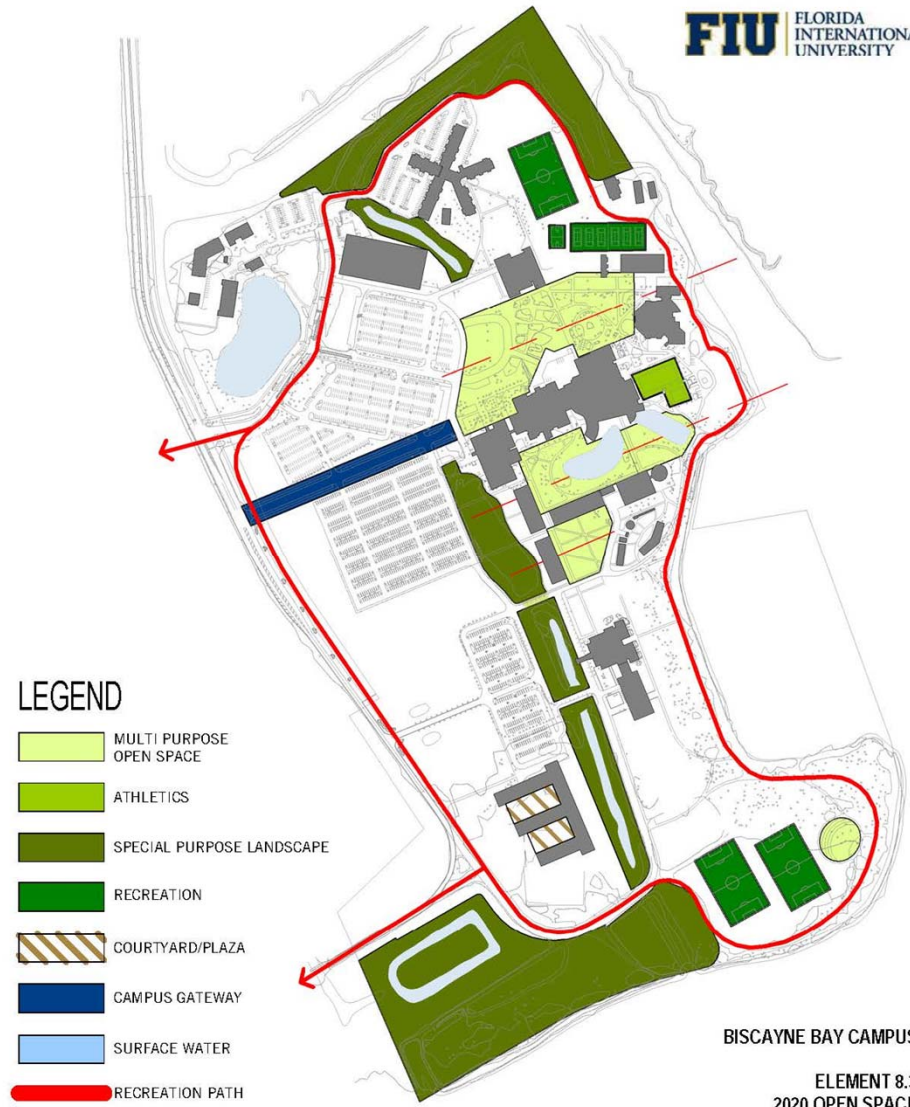

January 8, 2013

PERKINS+WILL



FLORIDA
INTERNATIONAL
UNIVERSITY

DISCUSSION

MMC Collage



January 8, 2013

PERKINS+WILL

EC Collage



BBC Collage

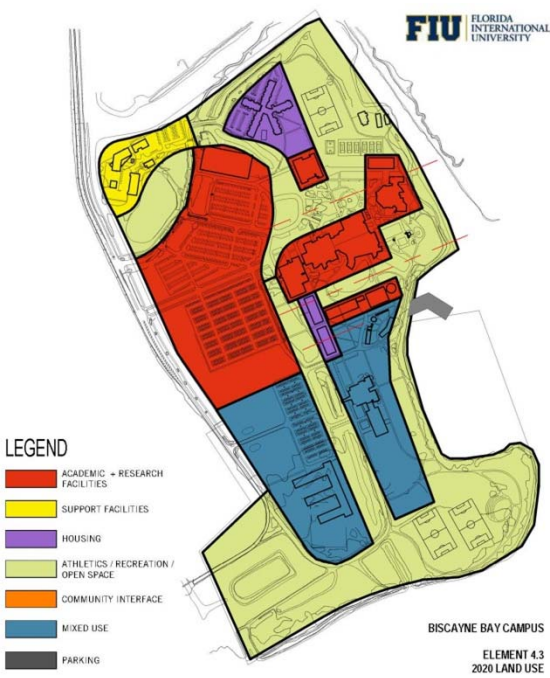
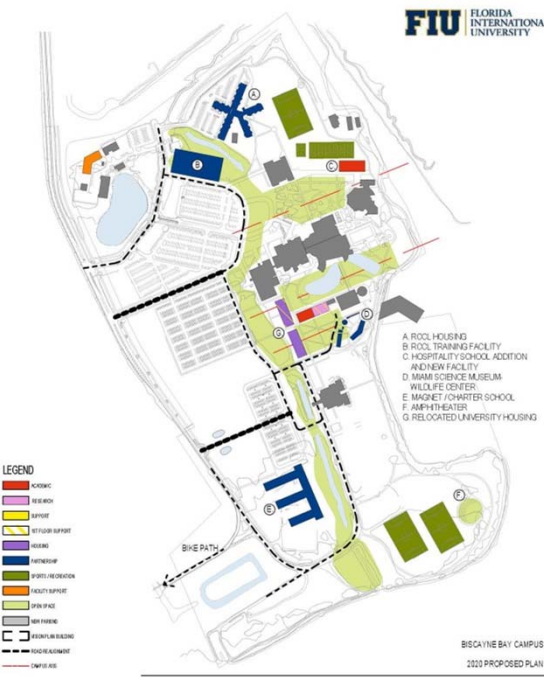

Additional Resources

MMC – 2020 Space Needs

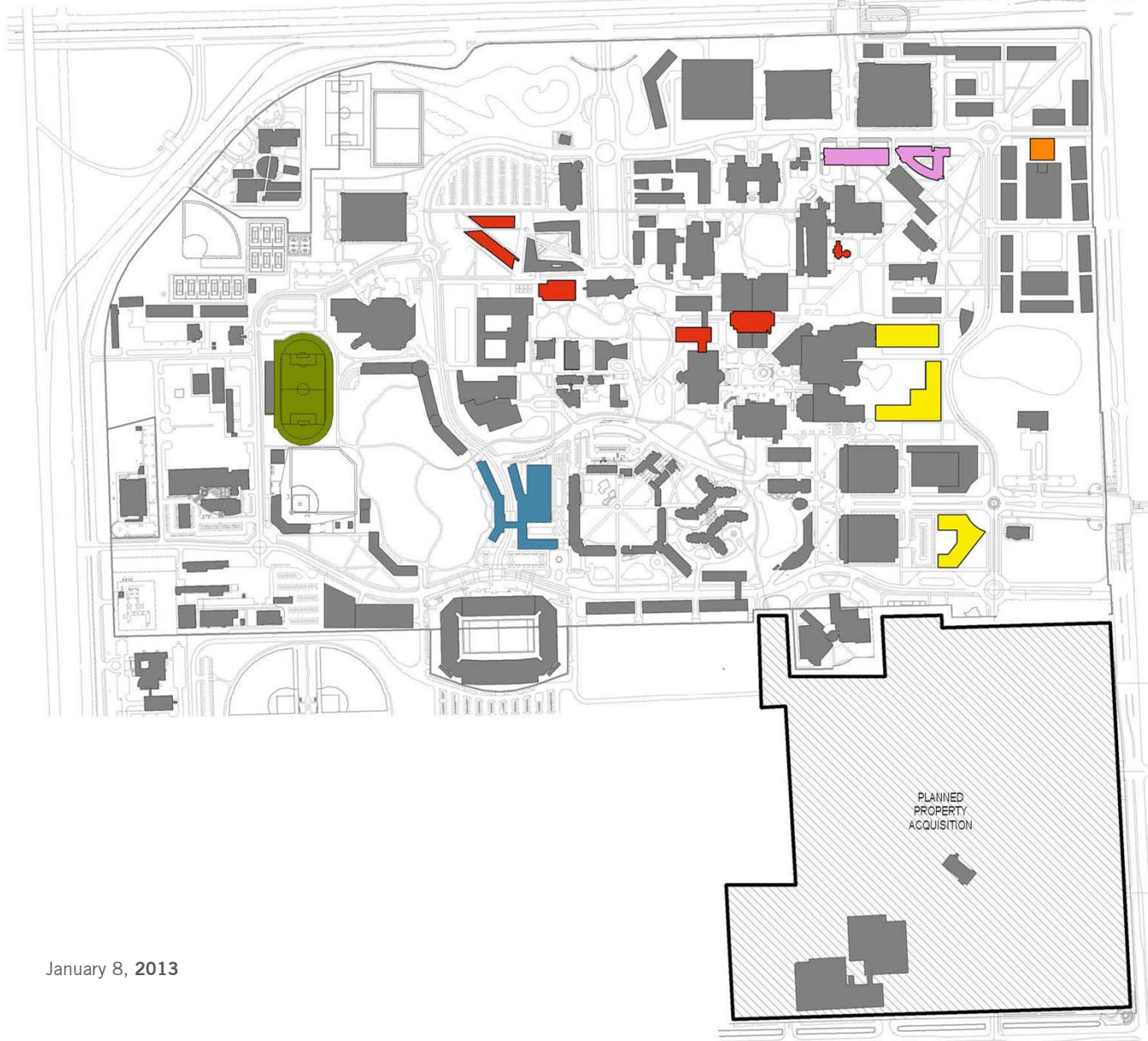

SPACE NEEDS 2020

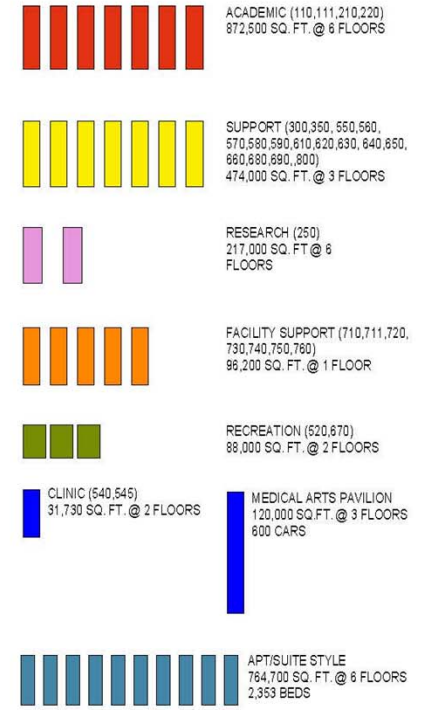

MODESTO MAIDIQUE CAMPUS

2020 SPACE NEEDS

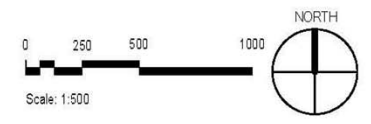

January 8, 2013

MMC – 2035 Space Needs

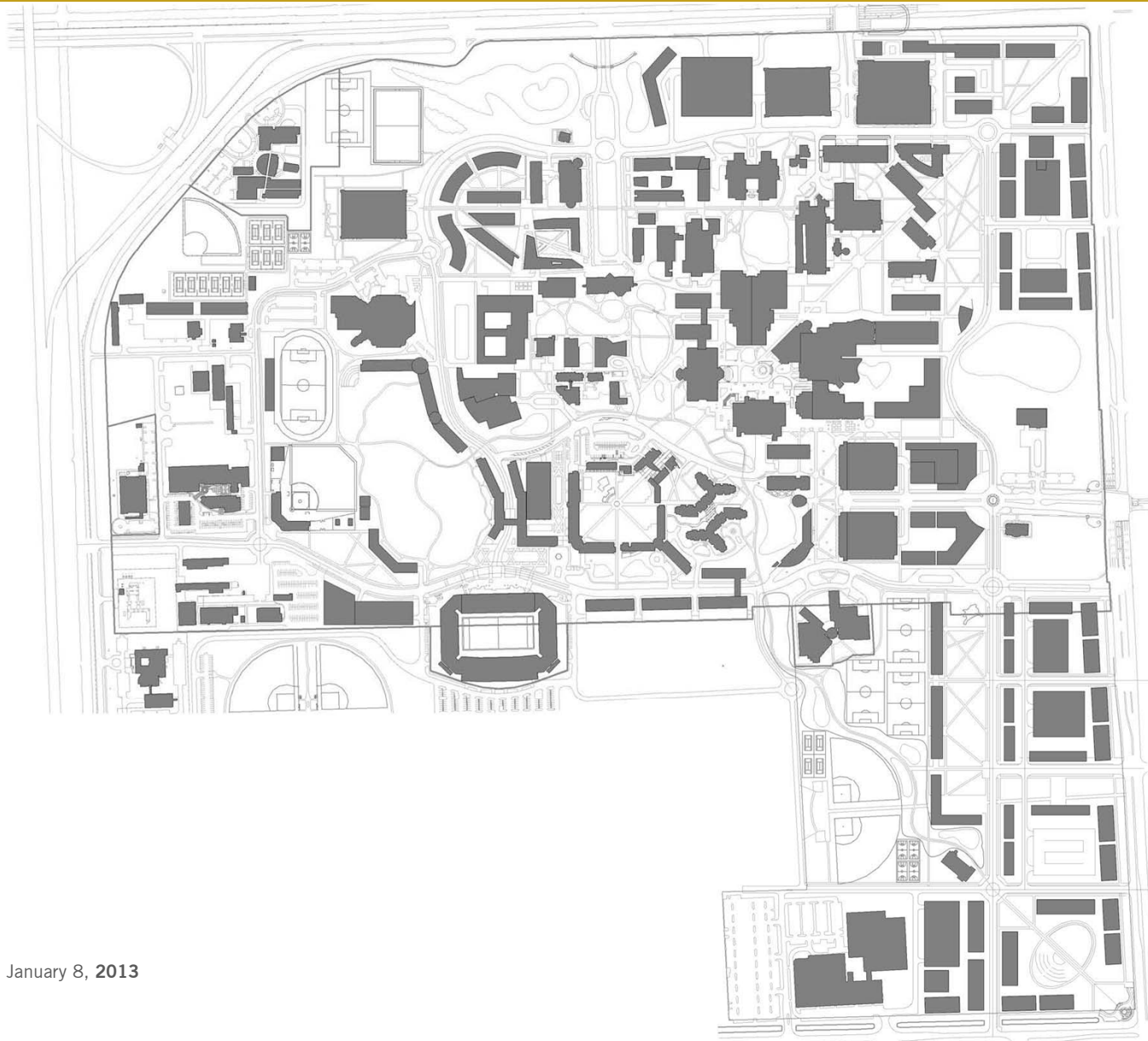

ADDED SPACE NEEDS 2035

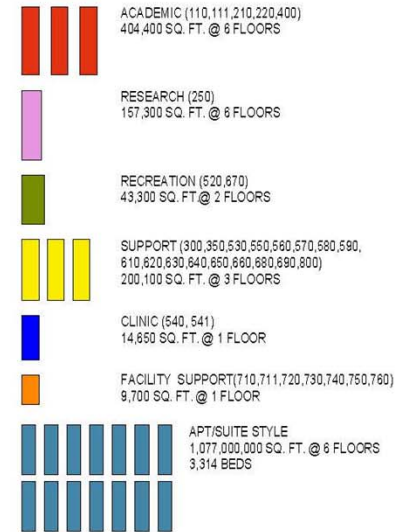

MODESTO MAIDIQUE CAMPUS

2035 SPACE NEEDS



MMC+EC - Recreation / Open Space Needs



RECREATION SPACE NEEDS 2020

NIRSA STANDARDS

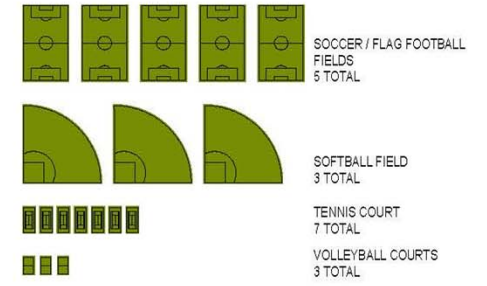

LEVEL OF SERVICE STANDARDS OF HOST COMMUNITY

OPEN SPACE AS SHOWN: 62.18 ACRES
 OPEN SPACE NEEDED: 103.73 ACRES (BASED ON ENROLLMENT HEADCOUNT)
 OPEN SPACE NEEDED: 11.76 ACRES (BASED ON RESIDENT HEADCOUNT)

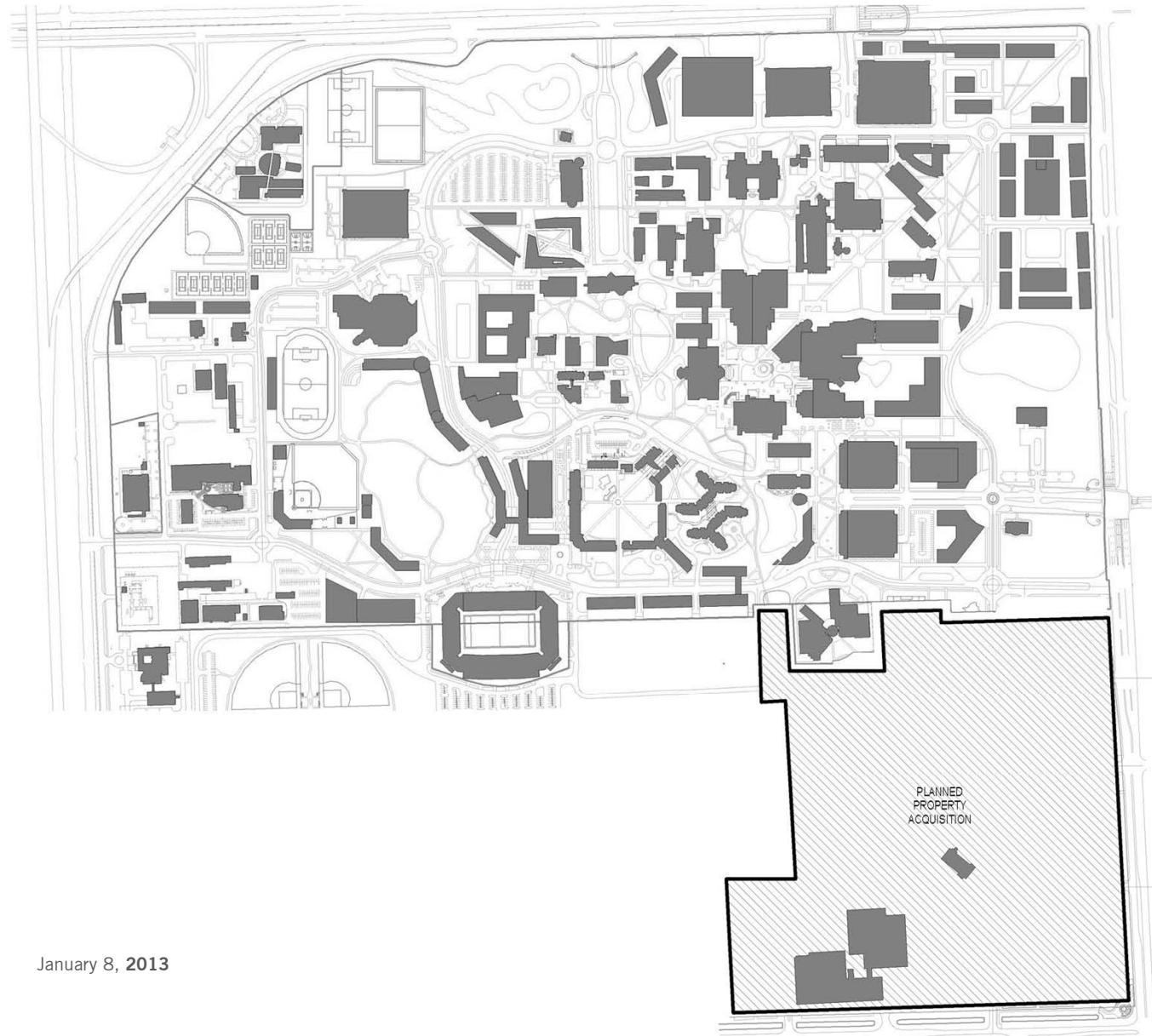

MODESTO MAIDIQUE CAMPUS 2020 RECREATION SPACE NEEDS

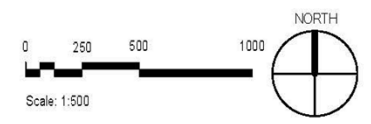

January 8, 2013

EC – 2020+2035 Space Needs

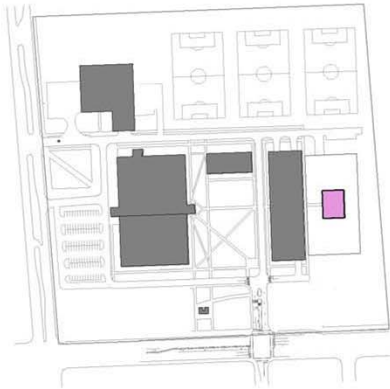

SPACE NEEDS 2020

- ACADEMIC (110,111,210,220)
46,600 SQ. FT. @ 2 FLOORS
- RECREATION (520, 670)
2,900 SQ. FT. @ 1 FLOOR
- FACILITY SUPPORT (710,711,720,730,740,750,760)
7,800 SQ. FT. @ 1 FLOOR

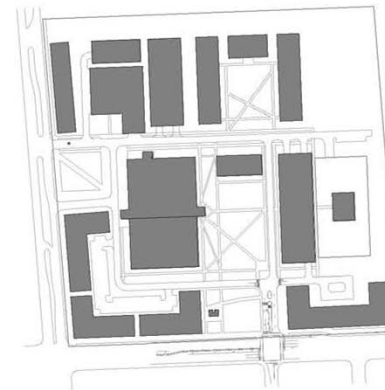

ADDED SPACE NEEDS 2035

- ACADEMIC (110,111,210,220,400)
37,700 SQ. FT. @ 2 FLOORS
- RECREATION (520,670)
1,000 SQ. FT. @ 1 FLOOR
- SUPPORT (300,350,530,550,560,570,580,590,610,620,630,640,650,660,680,690,800)
18,600 SQ. FT. @ 1 FLOORS
- FACILITY SUPPORT (710,711,720,730,740,750,760)
4,300 SQ. FT. @ 1 FLOOR

BBC – 2020+2035 Space Needs



SPACE NEEDS 2020

- ACADEMIC (110,111,210,220,)
32,500 SQ. FT. @ 1 FLOOR
- RESEARCH (250)
29,700 SQ. FT. @ 2 FLOOR
- CLINIC (540, 545)
3,500 SQ. FT. @ 1 FLOOR
- FACILITY SUPPORT(710,711,720,730,740,750,760)
12,900 SQ. FT. @ 1 FLOOR
- SUPPORT (300,350,530,550,560,570,580,590,
610,620,630,640,650,660,680,690,800)
2,000 SQ. FT. @ 1 FLOOR
- APT STYLE
238,250 SQ. FT. @ 10 FLOORS
733 BEDS

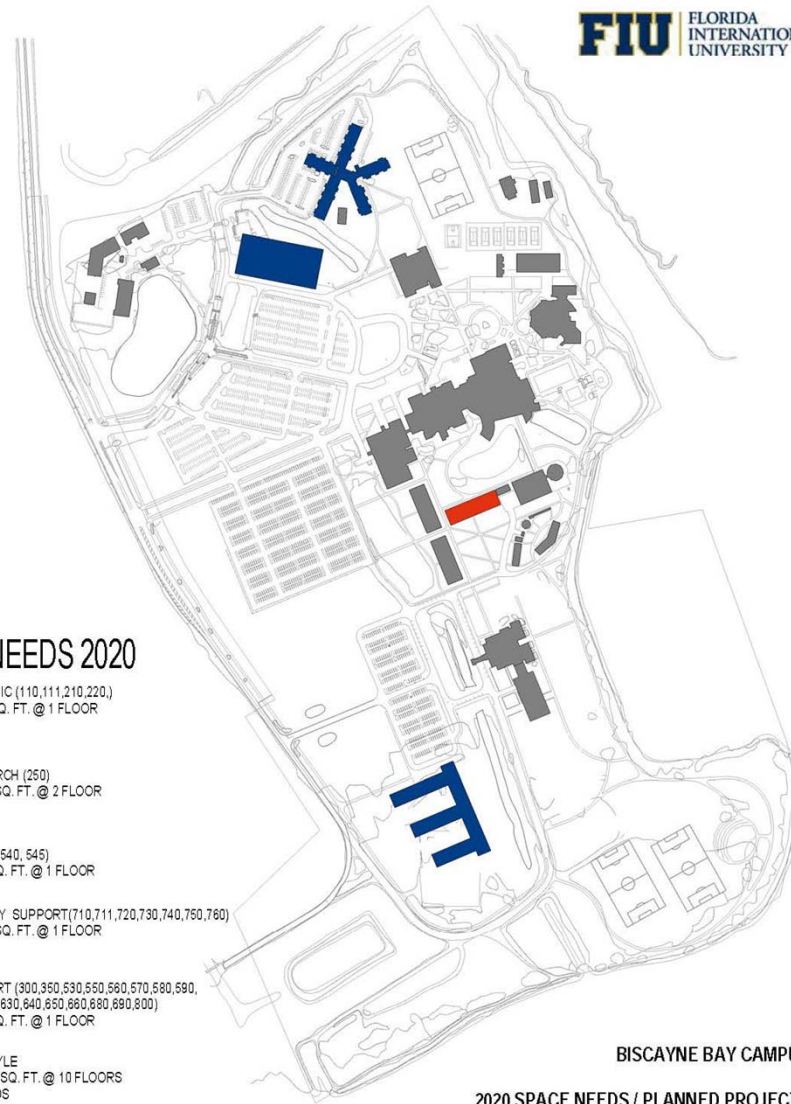

BISCAYNE BAY CAMPUS

2020 SPACE NEEDS / PLANNED PROJECTS

BBC – Recreation / Open Space Needs

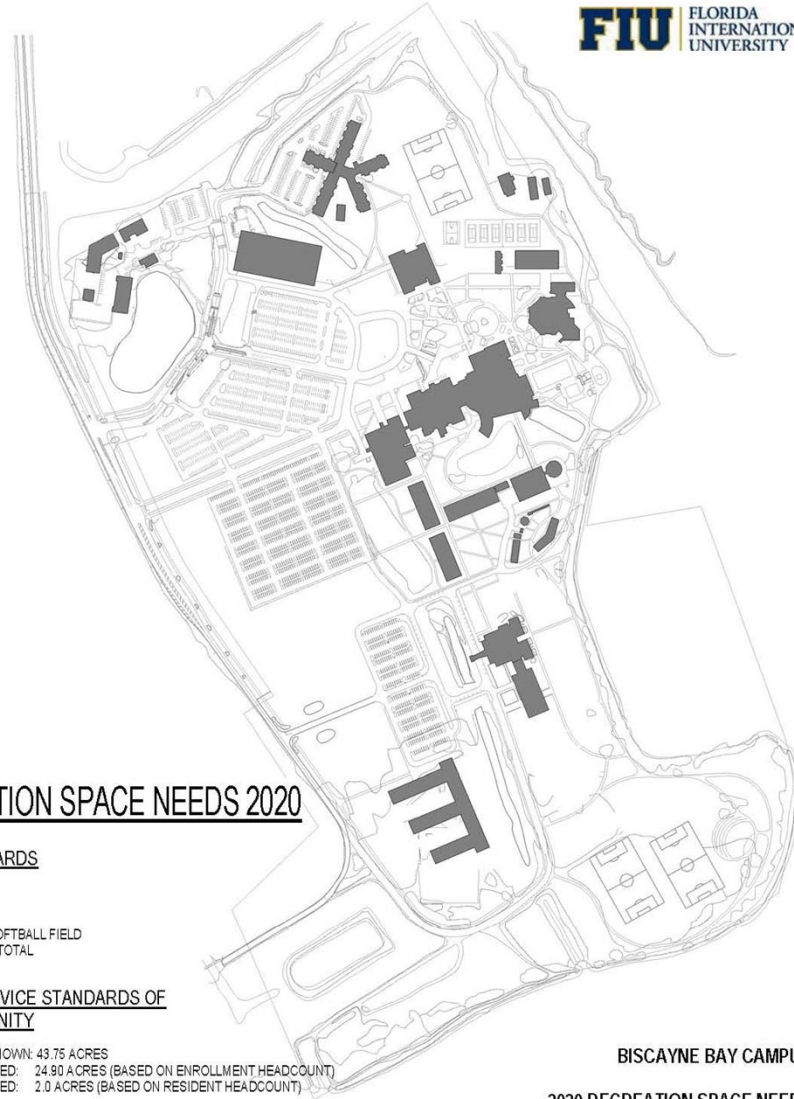

RECREATION SPACE NEEDS 2020

NIRSA STANDARDS



SOFTBALL FIELD
1 TOTAL

LEVEL OF SERVICE STANDARDS OF HOST COMMUNITY

OPEN SPACE AS SHOWN: 43.75 ACRES
OPEN SPACE NEEDED: 24.90 ACRES (BASED ON ENROLLMENT HEADCOUNT)
OPEN SPACE NEEDED: 2.0 ACRES (BASED ON RESIDENT HEADCOUNT)

BISCAYNE BAY CAMPUS

2020 RECREATION SPACE NEEDS

27 AUGUST 2012

PERKINS+WILL

Campus Guiding Principles

- Develop a **sustainable** campus environment.
- Develop forward looking, **innovative and interdisciplinary** learning and research environments.
- **Reinforce FIU's identity** through the articulation of landmarks, precincts, edges, buildings, and open spaces.
- Create a more **compact urban environment**.
- Develop comprehensive **multi-modal solutions to transportation & infrastructure**.
- Establish better **connectivity with neighboring communities**.
- Create a safe, connected, **pedestrian-friendly** campus.
- Site core academic programs along **main axes**.
- Develop **student life mixed use communities**.
- Foster learning through **multipurpose open space**.

Sustainable Planning Principles

- ***Multi-modal circulation*** and access to planned metro transit systems
- Mixed use parking decks at perimeter of campus
- More ***compact urban environment*** with connectivity to community
- Student residential community with mixed use amenities on campus
- Creating “***green lungs***” with open space quadrangles, courtyards, landscaping, and water features
- ***Campus green belt*** for pedestrian and vehicular movement
- ***Building guidelines*** encouraging natural ventilation, shading, and daylighting in exterior and interior spaces to reduce energy consumption
- Outdoor ***lighting guidelines*** for efficient energy use
- ***On-site storm water treatment and management***
- ***Landscape guidelines*** for shade, filtration and water efficiency
- Recycling/composting: facilities, construction, mail/print services, dining
- ***Thermal Energy Storage*** (ice tanks) planned with new chiller plants
- ***Precinct plants***: mini-loops for efficiency and shared redundancy