

- Zone A ●
- Zone B ●
- Zone C ●
- Zone D ●
- Zone E ● (EC)
- BBC ●

BUILDING LEGEND

No.	NAME	No.	NAME
01	CHARLES E. PERRY PRIMA CASA	50	TRISH & DAN BELL CHAPEL MANGO
02	DELUXIEME MAISON	52	PARKVIEW HOUSING
03	ERNEST R. GRAHAM UNIV. CTR.	56	TAMAMI HALL TOWER V.M.A.
04	VERTES HAUS	C01	DUPLICATING CENTER
04A	CENTRAL UTILITIES ONE	CW1	PODM COVERED WALKWAY
05	STEVEN & DOROTHEA GREEN LIB	CW2	DMGL COVERED WALKWAY
06	CHIA EBAN	CW3	PCA COVERED WALKWAY
06A	WERTHEIM CONSERVATORY	CW4	CLCO COVERED WALKWAY
07	OCEAN BANK CONVOCATION CENTER	CW5	DECP COVERED WALKWAY
07A	OBCC STORAGE	CW7	PG/PCP COVERED WALKWAY
08	COMPUTER, ARTS, SCIENCES AND EDUCATION	CW8	MANGORD COVERED WALKWAY
08A	CASE STORAGE SHED 8A	E01	EAST 1A
08B	CASE STORAGE SHED 8B	GHI	GREEK HOUSING I
08C	CASE STORAGE SHED 8C	GHI	GREEK HOUSING II
09	CHEMISTRY & PHYSICS BUILDING TEN	M01	RECREATION TRAILER
11	RYDER BUSINESS BUILDING	M05	COLC TRAILER
12	STUDENT HEALTH SERVICES COMPLEX	M06	FIU EMPOWERMENT CENTER
13	LABOR CENTER	M07	PARKING GARAGE 1 GOLD
14	SANFORD & DOLORES ZIFF EDU.	PG1	PARKING GARAGE 2 BLUE
14A	INFORMATION CENTER	PG3	PANTHER PARKING GARAGE
15	FIU BASEBALL STADIUM	PG4	RED PARKING GARAGE
15A	BATTING CAGE	PG5	PG5 MARKET STATION
15B	BASEBALL STADIUM STORAGE SHED	PG6	PARKING GARAGE SIX
15C	NATURE PRESERVE GREEN HOUSE	SH	SOLAR HOUSE
16	HERBERT & NICOLE WERTHEIM CTR.	THA	A UNIVERSITY APARTMENTS
17	CHILDREN'S CREATIVE LEARNING	THB	B UNIVERSITY APARTMENTS
17A	COLC SHED A	THC	C UNIVERSITY APARTMENTS
17B	COLC SHED B	THD	D UNIVERSITY APARTMENTS
18	FIU SOCCER STADIUM	THE	E UNIVERSITY APARTMENTS
18B	SOCCER STADIUM STORAGE B	THF	F UNIVERSITY APARTMENTS
19	PANTHER HALL	THG	G UNIVERSITY APARTMENTS
19A	UNIVERSITY TOWER	THH	H UNIVERSITY APARTMENTS
19B	EVERGLADES HALL	THJ	J UNIVERSITY APARTMENTS
19C	LAKEVIEW NORTH HALL	THK	K UNIVERSITY APARTMENTS
19C1	LAKEVIEW SOUTH HALL	THL	L UNIVERSITY APARTMENTS
19P	PANTHER RESIDENCE HALL POOL	W01	WEST 1
20	STUDENT ATHLETICS ACADEMIC CTR.	W01A	WEST 1A
21	ACADEMIC HEALTH CENTER 1	W01B	WEST 1B CANOPY
21A	ACADEMIC HEALTH CENTER 2	W01C	WEST 1C CERAMICS
22	CAMPUS SUPPORT COMPLEX SHOPS	W01D	GREEN HOUSE
22A	CAMPUS SUPPORT CANOPY/SERV	W02	WEST 2
22B	CAMPUS SUPPORT STORAGE	W02A	HAZARDOUS WASTE SHED
23	CAMPUS SUPPORT COMPLEX ADMIN.	W02B	CHEMICAL STORAGE
24	PAUL CEJAS ARCHITECTURE MANAGEMENT & ADVANCED RESEARCH	W02C	DEISEL/GASLINE PUMP
25	RAFAEL DIAZ-BALART HALL	W03	WEST 3- KEY CONTROL
26	RONALD W. REAGAN PRES. HOUSE	W05	WEST 5
27	PATRICIA & PHILIP FROST MUSEUM	W06A	WEST 6
28	COLLEGE OF BUSINESS COMPLEX	W06B	DUGOUT 3
31	CENTRAL UTILITIES TWO	W06C	DUGOUT 4
31A	SATELLITE CHILLER PLANT	W06D	PRESS BOX & DUGOUT
32	FITBALL STADIUM	W06E	SOFTBALL BATTING CAGE
33	WELLNESS AND RECREATION CENTER	W06F	SOFTBALL SHED 1
34	FIELD SUPPORT BUILDING	W06H	SOFTBALL COMPLEX
34A	REC. FIELD SUPPORT BUILDING	W07	WEST 7
35	SCHOOL OF INTER & PUBLIC AFFAIRS	W07A	WEST 7A CANOPY
36A	SCHOOL OF INTER & PUBLIC AFFAIRS 2	W07B	WEST 7B SHED
38	STOCKER ASTROSCIENCE CENTER	W07C	WEST 7C SHED
39	ACADEMIC HEALTH CENTER 3	W07D	WEST 7D SHED
40	TENNIS/GOLF COMPLEX	W09	WEST 9- PAINTING
41	HURRICANE CENTER	W10	WEST 10- DRAWING + MFA STUDIOS
42	ACADEMIC HEALTH CENTER 4	W10A	WEST 10A- ROTC
43	ACADEMIC HEALTH CENTER 5	W10C	ADMINISTRATIVE SYSTEM II
44	AMBULATORY CARE CENTER	W10R	ROTC TRAILER
45	STUDENT ACADEMIC SUCCESS CENTER	W10S	ROTC SHED
47	DIGITAL ART STUDIOS		
48	INNOVATION 1 (Fornly Engineering 1)		

Site Inventory

141 FIU Buildings
FIU = 9,082,269 GSF
Note: some sheds + gazebos may not be shown for clarity
* 2 Subleased Buildings not included in Site Inventory
3 Buildings under construction not included in Site Inventory
(332,563 FIU + 11,676 Subleased)
344.239 Total Acres

Area = 7.49 Acres of Shared use on County Land

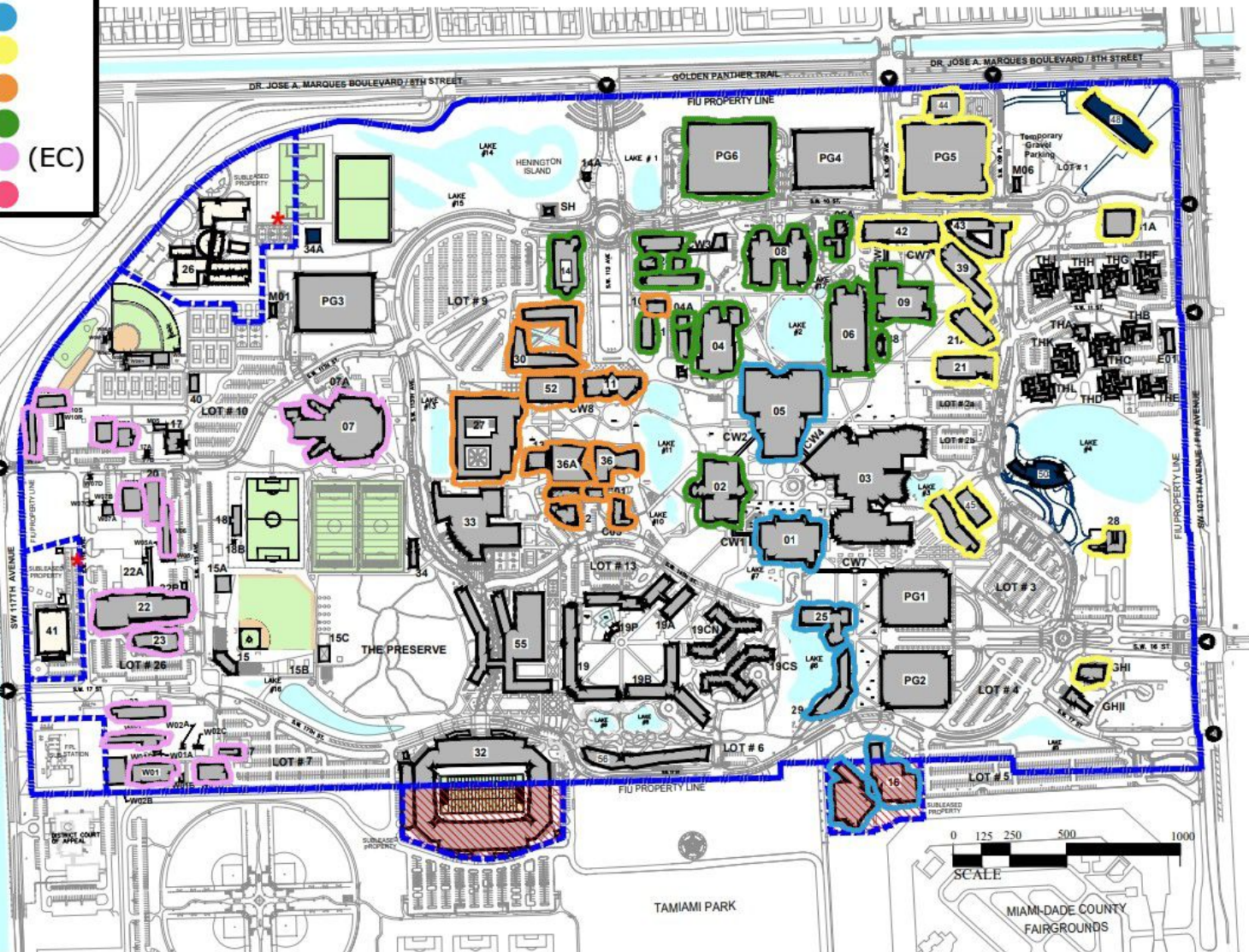

- EXISTING BUILDINGS
- IN CONSTRUCTION OR STARTING 2024
- SUBLEASED PROPERTY
- ENTRANCE
- PROPERTY LINE
- LEASE PROPERTY LINE

FLORIDA INTERNATIONAL UNIVERSITY

- MODESTO A. MAIDIQUE CAMPUS -





BUILDING LEGEND

No.	NAME
101	ENGINEERING CENTER
102	OPERATIONS/UTILITY
102A	EC WOOD STORAGE
102B	EC WOOD STORAGE 2
102C	EC WOOD STORAGE 3
102H	ARC RESEARCH LAB # 1
102I	ARC RESEARCH LAB # 2
102J	ARC RESEARCH LAB # 3
102K	ARC RESEARCH LAB # 4
102L	EC WOOD STORAGE 4
102M	STORAGE 102M
102P	STORAGE 102P
102Q	STORAGE 102Q
103	INFORMATION BOOTH 1
103A	INFORMATION BOOTH 2
104	SOLAR DECATHLON HOUSE
105	WALL OF WIND RESEARCH FACILITY
105A	WALL OF WIND TRAILER
105B	WOW SHED
105C	WALL OF WIND SHOP
EG21	EC GAZEBO # 1
EG22	EC GAZEBO # 2
SP	SOLAR PANELS

Site Inventory
22 FIU Buildings
FIU = 544,559 GSF
Note: some sheds + gazebos may not be shown for clarity
28,008 TOTAL ACRES

EXISTING BUILDINGS
 IN CONSTRUCTION OR STARTING 2024
 ENTRANCE PROPERTY LINE

FLORIDA INTERNATIONAL UNIVERSITY

- THE ENGINEERING CENTER -



OCTOBER 23, 2024

▲ To Biscayne Blvd.
Via NE 151 Street

OLETA STATE
PARK

BISCAYNE
BAY

CITY OF
NORTH MIAMI

Site Inventory
41 FIU Buildings
FIU = 953,003 GSF
<small>Note: some sheds + gazebos may not be shown for clarity</small>
* 3 Subleased Buildings not included in Site Inventory
(183,484 FIU + 11.70 Subleased)
195.184 Total Acres <small>(Total does not include 3.53 acres R.O.W. easement.)</small>

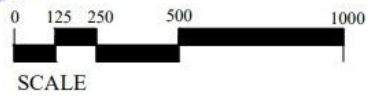
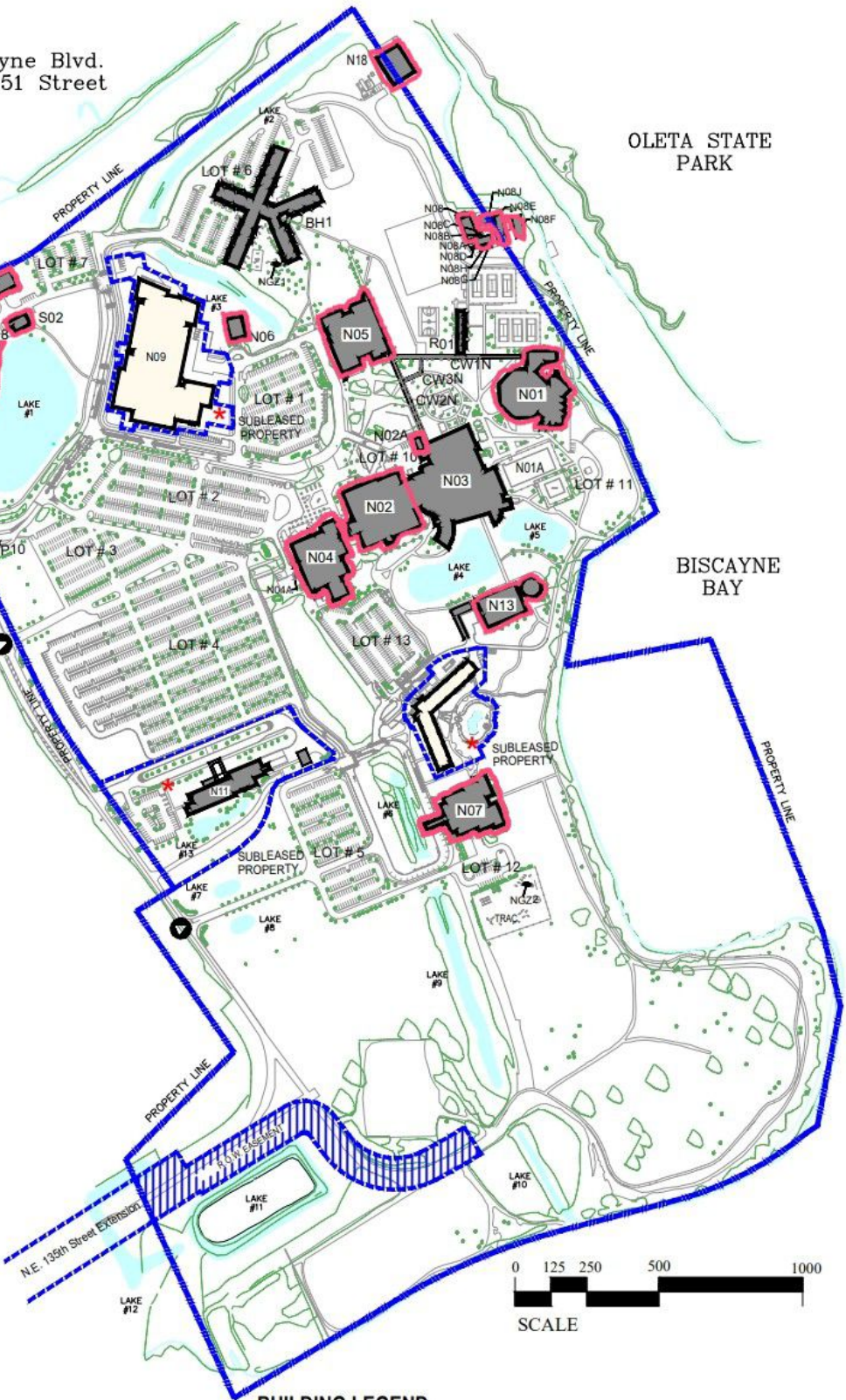

BUILDING LEGEND

No.	NAME
BH1	BAY VISTA HOUSING
CW1N	HMH/L COVERED WALKWAY
CW2N	WUCH/L COVERED WALKWAY
CW3N	CW1N/CW2N COVERED WALKWAY
N01	HOSPITALITY MANAGEMENT
N01A	AQUATIC COMPLEX
N02	ACADEMIC ONE
N02A	BBC CENTRAL UTILITIES
N03	GREGORY B. WOLFE UNIV. CTR.
N04	ACADEMIC TWO
N04A	ACADEMIC TWO STORAGE
N05	GLENN HUBERT LIBRARY
N06	STUDENT HEALTH SERVICES
N07	ROZ&CAL KOVENS CONFERENCE CTR.

No.	NAME
N08	CCR LABORATORY
N08A	CCR LABORATORY MODULE
N08B	CCR LAB SHED 1
N08C	CCR LAB SHED 2
N08D	CCR LAB SHED 3
N08E	CCR LAB METAL CANOPY 1
N08F	CCR LAB METAL CANOPY 2
N08G	CCR LAB COLD ROOM
N08H	CCR LAB SHED 4
N08J	MOTION CAPTURE TANK FACILITY
N09	RCCL TRAINING CENTER
N10	BAYVIEW HOUSING
N11	MAST ACADEMY
N13	MARINE SCIENCE

No.	NAME
N18	FROST MUSEUM OF SCIENCE - BATCHELOR CENTER
P10	INFORMATION CENTER
R01	OUTDOOR RECREATION
R01E	OUTDOOR RECREATION EXPANSION
S01	CENTRAL RECEIVING
S02	UNIVERSITY POLICE
S03	PHYSICAL PLANT
S03A	PLANT SUPPORT
S04	GROUNDS

EXISTING BUILDINGS	IN CONSTRUCTION OR STARTING 2023	SUBLEASED PROPERTY
ENTRANCE	PROPERTY LINE	LEASE/ EASEMENT LINE

FLORIDA INTERNATIONAL UNIVERSITY
- BISCAYNE BAY CAMPUS -

